

HARWICH PORT COMMONS

4 RETAIL/OFFICE UNITS AVAILABLE

557 Route 28 | Harwich Port, MA



FOR LEASE AT \$25–\$27.50/SQ. FT. (N-N-N)



For more information, please contact:

BRAD KUHRTZ

Office: 508-862-9000, Ext. 118 | Cell: 508-360-4523

Fax: 508-862-9200 | bkuhrtz@comrealty.net

Commercial
Realty Advisors

222 West Main Street, Hyannis, MA 02601 | 508-862-9000 | www.comrealty.net

Commercial Realty Advisors

PROPERTY SUMMARY: 557 ROUTE 28, HARWICH PORT, MA

Harwich Port Commons

Harwich Port Commons is a newly constructed (2018) mixed-use town center style building located in the center of historic Harwich Port, MA. The building features four first-floor storefront retail/office spaces and four second floor luxury residential condominiums above. Dedicated off street parking and plenty of storage. The blend of classic architectural character with contemporary fits and finishes presents a rare opportunity to place your business in a vibrant and growing main street district.

All retail units are bright, airy and customizable to suit tenants. Each unit has a storage closet and private bathroom. Grounds are professionally landscaped.

| | | | |
|-------------------------|--------------------|-----------------|------------------------------|
| Retail/Office #1 | Street Facing Unit | 1,185 ± sq. ft. | \$27.50 / Sq. Ft. (N-N-N) |
| Retail/Office #2 | Street Facing Unit | 1,262 ± sq. ft. | \$27.50 / Sq. Ft. (N-N-N) |
| Retail/Office #3 | Rear Facing Unit | 1,172 ± sq. ft. | \$25 / Sq. Ft. (N-N-N) |
| Retail/Office #4 | Rear Facing Unit | 1,135 ± sq. ft. | \$25 / Sq. Ft. (N-N-N) |



Commercial
Realty Advisors

FLOOR PLAN: 557 ROUTE 28, HARWICH PORT, MA

← ROUTE 28 →

Street Facing Unit #2
1,262 ± sq. ft.
\$27.50 (N-N-N)

Street Facing Unit #1
1,185 ± sq. ft.
\$27.50 (N-N-N)

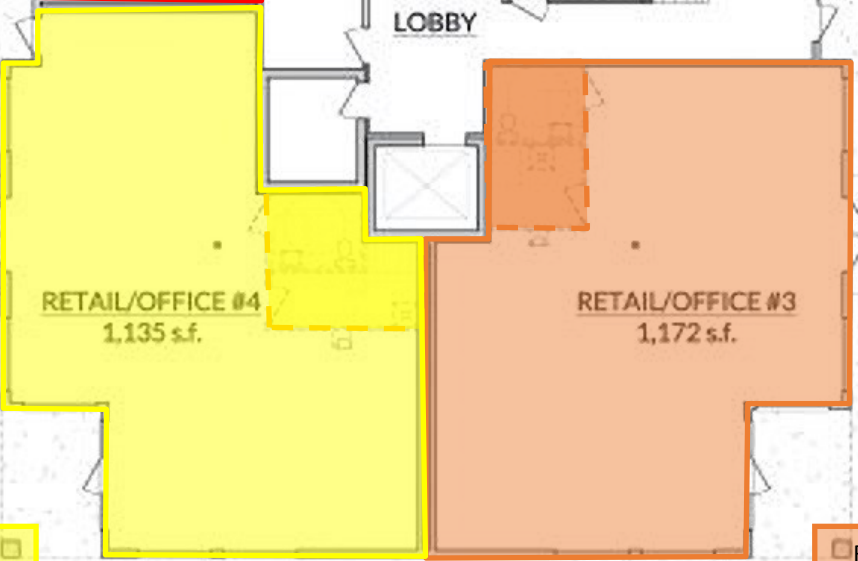
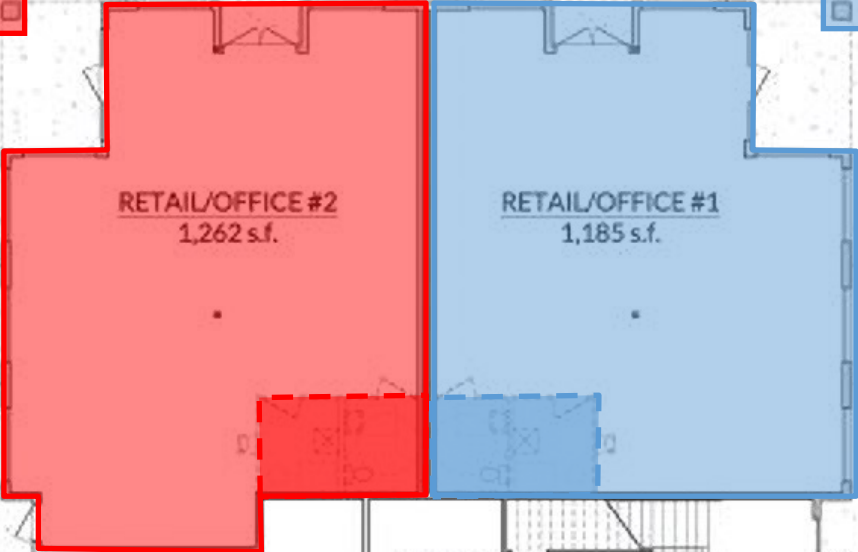

Rear Facing Unit #4
1,135 ± sq. ft.
\$25.00 / sq. ft. (N-N-N)

Rear Facing Unit #3
1,172 ± sq. ft.
\$25.00 / sq. ft. (N-N-N)

MAIN FLOOR PLAN

Commercial Realty Advisors

MAP & IMAGES: 557 ROUTE 28, HARWICH PORT, MA

