

FOR LEASE >

# Millikan 73

13955 SW MILLIKAN WAY BEAVERTON, OR 97005

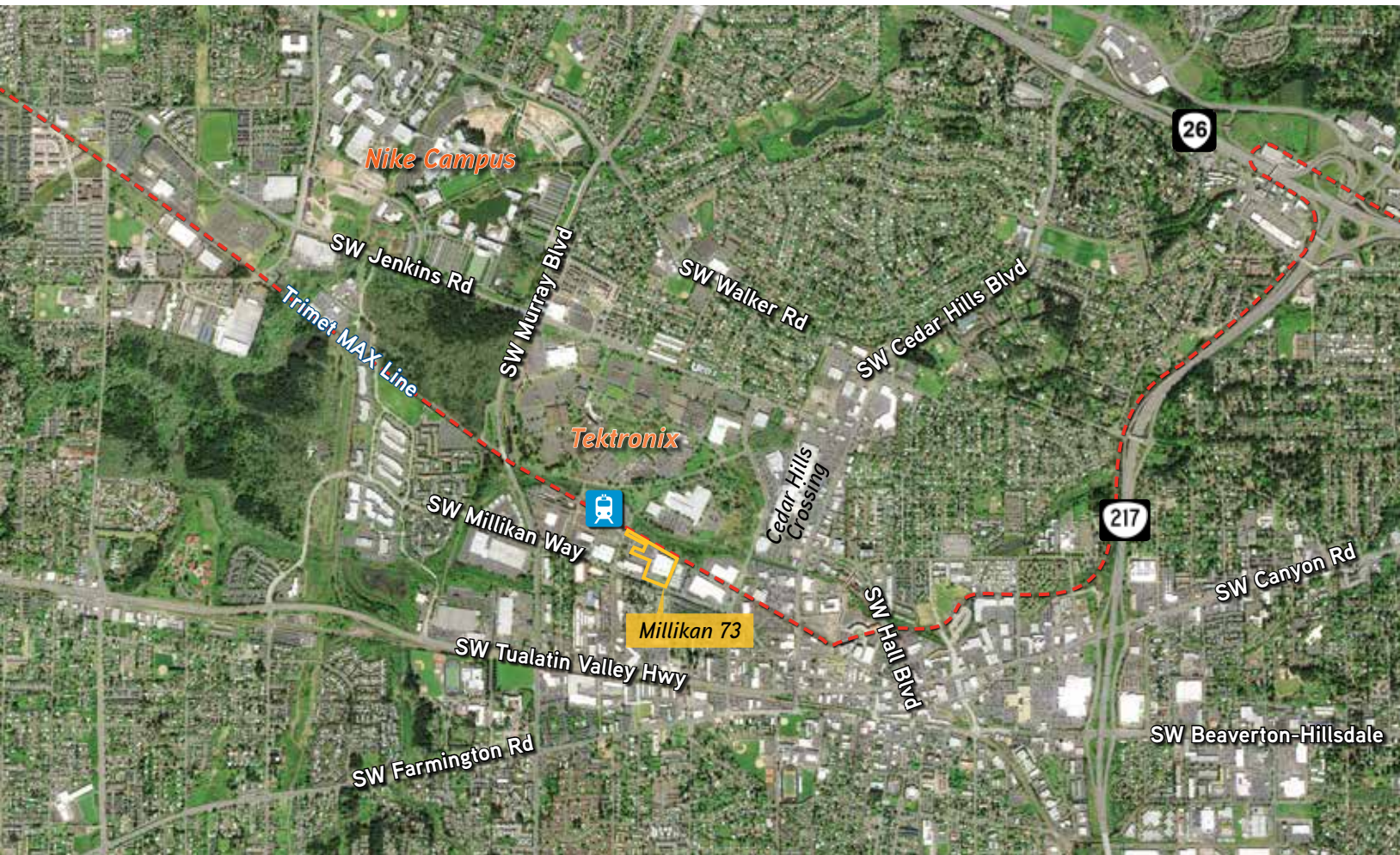

FOR LEASE >

# Millikan 73

13955 SW MILLIKAN WAY BEAVERTON, OR 97005



41,000 SF Production - R&D Space \$0.75/SF, NNN  
21,175 SF Office Space - \$1.20/SF, NNN  
*\*Expandable to 103,316 SF, July 2017*

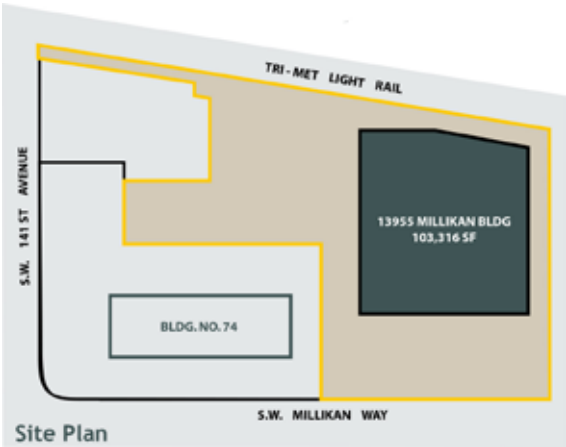

- > **Millikan Way MAX Station** is one block away
- > **SC-E1, Station Community Employment zoning** allows general office, manufacturing, fabricating, assembly, processing, and packaging.
- > **Beaverton Enterprise Zone** - Allows property tax abatement on new equipment purchases and new leasehold improvements; up to 5-year exemption. [www.BeavertonOregon.gov/Ezone](http://www.BeavertonOregon.gov/Ezone)
- > **Walkable to Cedar Hills Crossing** - Food service, retail, commercial, and financial services.

## PRODUCTION - 41,000 SF

- > Fully air conditioned
- > Electrical distribution; air lines
- > 30,000 SF drop ceiling production; restrooms/shower/lockers; training, break room
- > 10,000 SF warehouse with HVAC; 22' clear height; 4 dock doors; 1 grade & dock covered platform

## OFFICE - 21,175 SF

- > 2nd floor with direct connection to Production
- > Elevator served (2) from lobby & Production
- > Perimeter offices with open workstation interior; multiple conference rooms; kitchen, restrooms, server room, etc.

### Millikan 73 - Built in 1976 for Tektronix

- 103,316 SF
- 3.2:1,000 Parking
- Enterprise Zone
- On MAX Station

This document has been prepared by Colliers International for advertising and general information only. Colliers International makes no guarantees, representations or warranties of any kind, expressed or implied, regarding the information including, but not limited to, warranties of content, accuracy and reliability. Any interested party should undertake their own inquiries as to the accuracy of the information. Colliers International excludes unequivocally all inferred or implied terms, conditions and warranties arising out of this document and excludes all liability for loss and damages arising there from. This publication is the copyrighted property of Colliers International and/or its licensor(s). ©2016. All rights reserved. 01/07/16



MIKE THOMAS  
503 499 0059  
PORTLAND, OR  
[mike.thomas@colliers.com](mailto:mike.thomas@colliers.com)

MARK McCLUNG  
503 499 0066  
PORTLAND, OR  
[mark.mcclung@colliers.com](mailto:mark.mcclung@colliers.com)



# Floor Plans - 1st & 2nd Floor

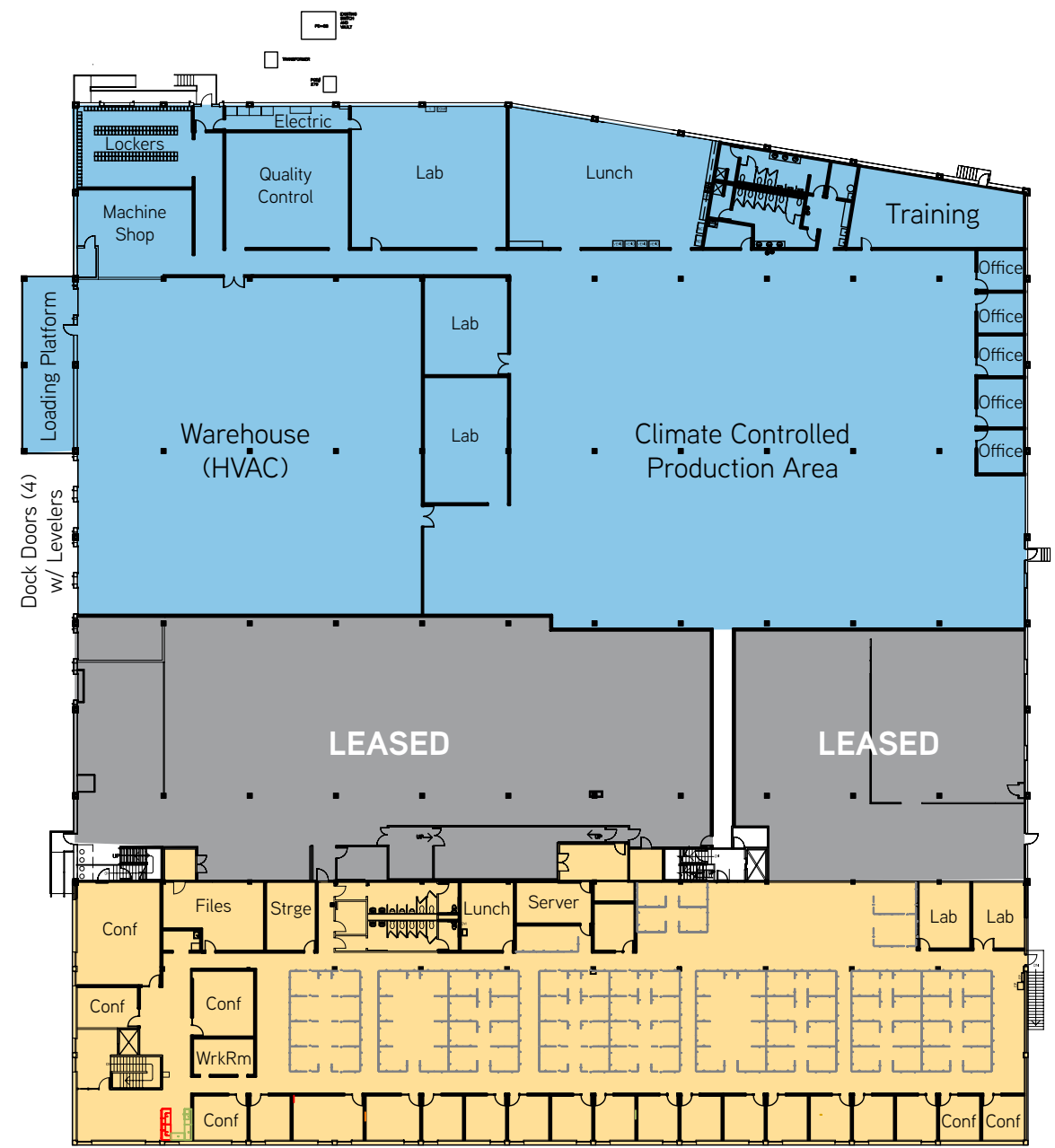

## 41,000 SF - 1st Floor Production Space

- Fully air-conditioned
- Abundant distributed electrical power and compressed air lines
- 30,000 SF of drop-ceiling environment; restrooms, lockers, showers; training room; break room
- 10,000 SF of warehouse (HVAC); 22' clear height; 4 dock doors; 1 covered platform dock with grade access.
- Available now

## 21,175 SF - 2nd Floor Office

- Contiguous to Production
- Elevator served (2) from main Lobby and Production
- Perimeter offices with open work station interior; multiple conference rooms; kitchen, restrooms, server room
- Available November 2016

