

630 HARVARD STREET

HARVARD ST

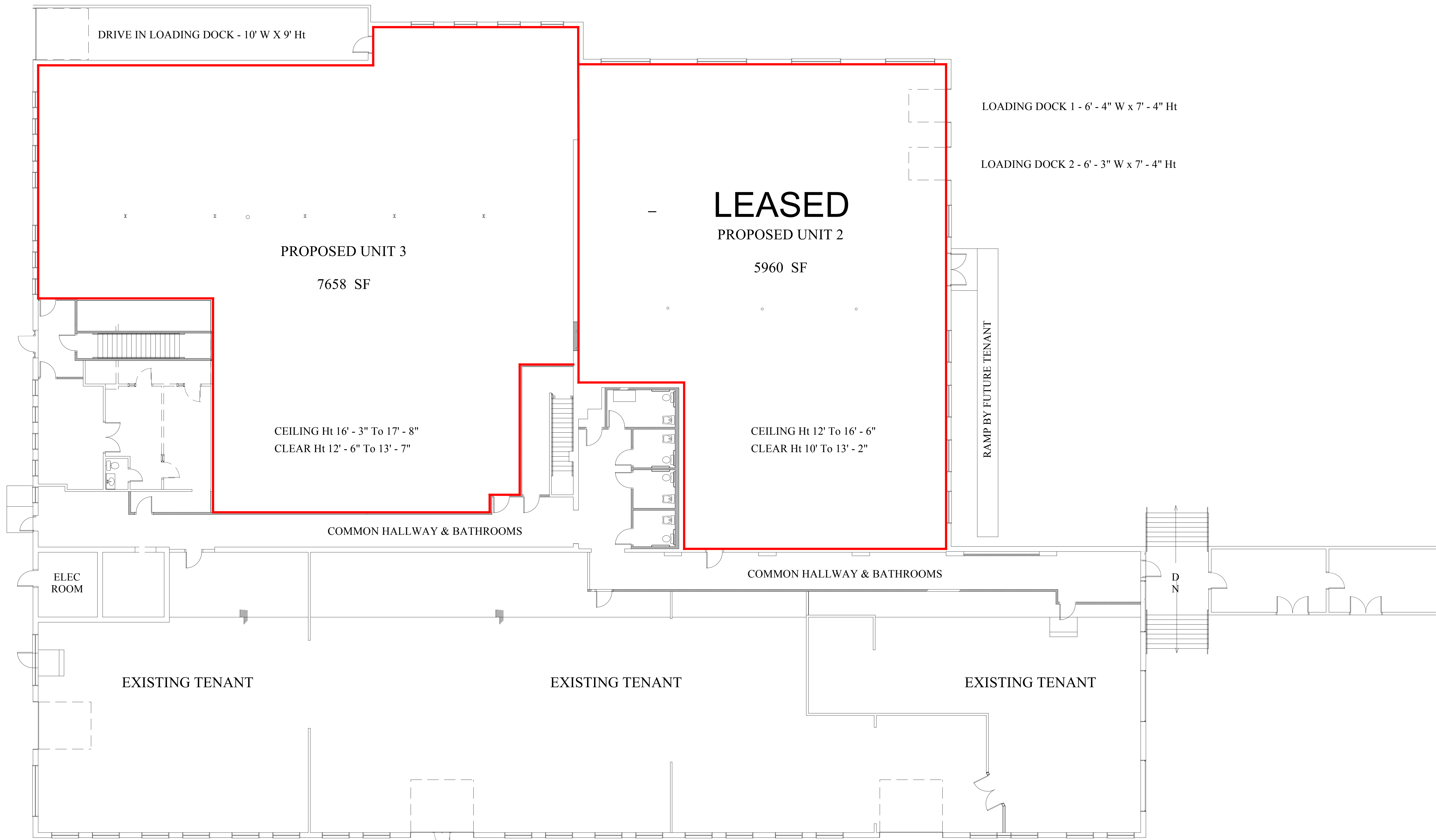

DRIVE IN LOADING DOCK - 10' W X 9' Ht

LOADING DOCK 1 - 6' - 4" W x 7' - 4" Ht

LOADING DOCK 2 - 6' - 3" W x 7' - 4" Ht

PROPOSED UNIT 3

7658 SF

LEASED

PROPOSED UNIT 2

5960 SF

CEILING Ht 16' - 3" To 17' - 8"
CLEAR Ht 12' - 6" To 13' - 7"

CEILING Ht 12' To 16' - 6"
CLEAR Ht 10' To 13' - 2"

RAMP BY FUTURE TENANT

COMMON HALLWAY & BATHROOMS

COMMON HALLWAY & BATHROOMS

ELEC ROOM

EXISTING TENANT

EXISTING TENANT

EXISTING TENANT

D
N

HALL ST