

For LEASE

# CustomBlocks



**BRAD CARNESE**  
503 279 1750  
brad.carnese@cushwake.com

**MARK CARNESE**  
503 279 1764  
mark.carnese@cushwake.com

**DOUG DEURWAARDER**  
503 279 1752  
doug.deurwaarder@cushwake.com



[customblocksportland.com](http://customblocksportland.com)





*Landlord is enrolled in  
Facilities Permit Program*

## BUILDING HIGHLIGHTS

---

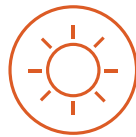

- ±32,116 SF, divisible to ±4,500 SF
- Vintage 1940s & 1950s
- Old growth timber, bowstring truss roof
- Heavy 3-phase power
- Significant natural light - skylights
- Fully sprinklered
- Off-street parking
- 8' x 14' drive-in loading door
- Located in the newly expanded East Portland Enterprise zone & e-commerce overlay

## BUILDING AMENITIES

---

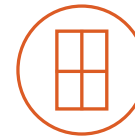

- New building systems throughout
- Seismically upgraded
- Rooftop decks with city views
- New energy-efficient operable windows
- New streetscape landscaping
- Interior bike storage and showers
- Significant sustainability elements
- Custom building addresses

*Authentic creative office in  
the heart of the Central Eastside*



*Shell complete*

**\$29.50 / SF NNN**

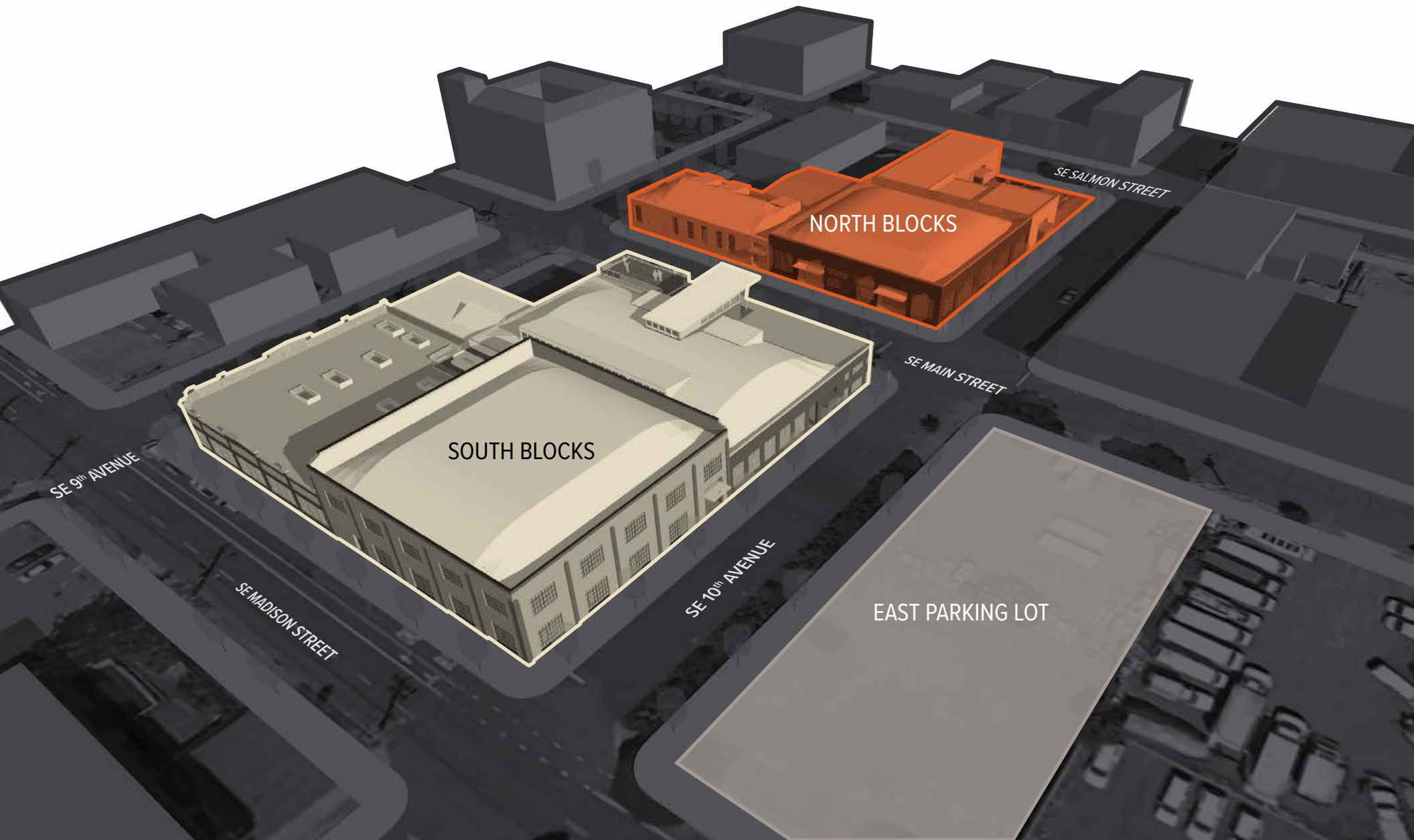

*SE 9th & 10th Avenue from  
SE Salmon Street to SE Madison Street  
Portland, OR*



## NORTH BLOCKS | TOTAL OF 22,790 RSF

- Fully leased
- Old growth timber, bowstring truss roof
- Vintage 1930s
- Extensive natural light
- Operable windows
- Clear heights 14-16 feet
- Heavy 3-phase power
- 8' x 14' drive-in loading door
- Fully sprinklered
- Independent parking lot
- Opportunity for patio seating

*Retail opportunities for tap room, tasting room, along with light assembly or high-tech production*

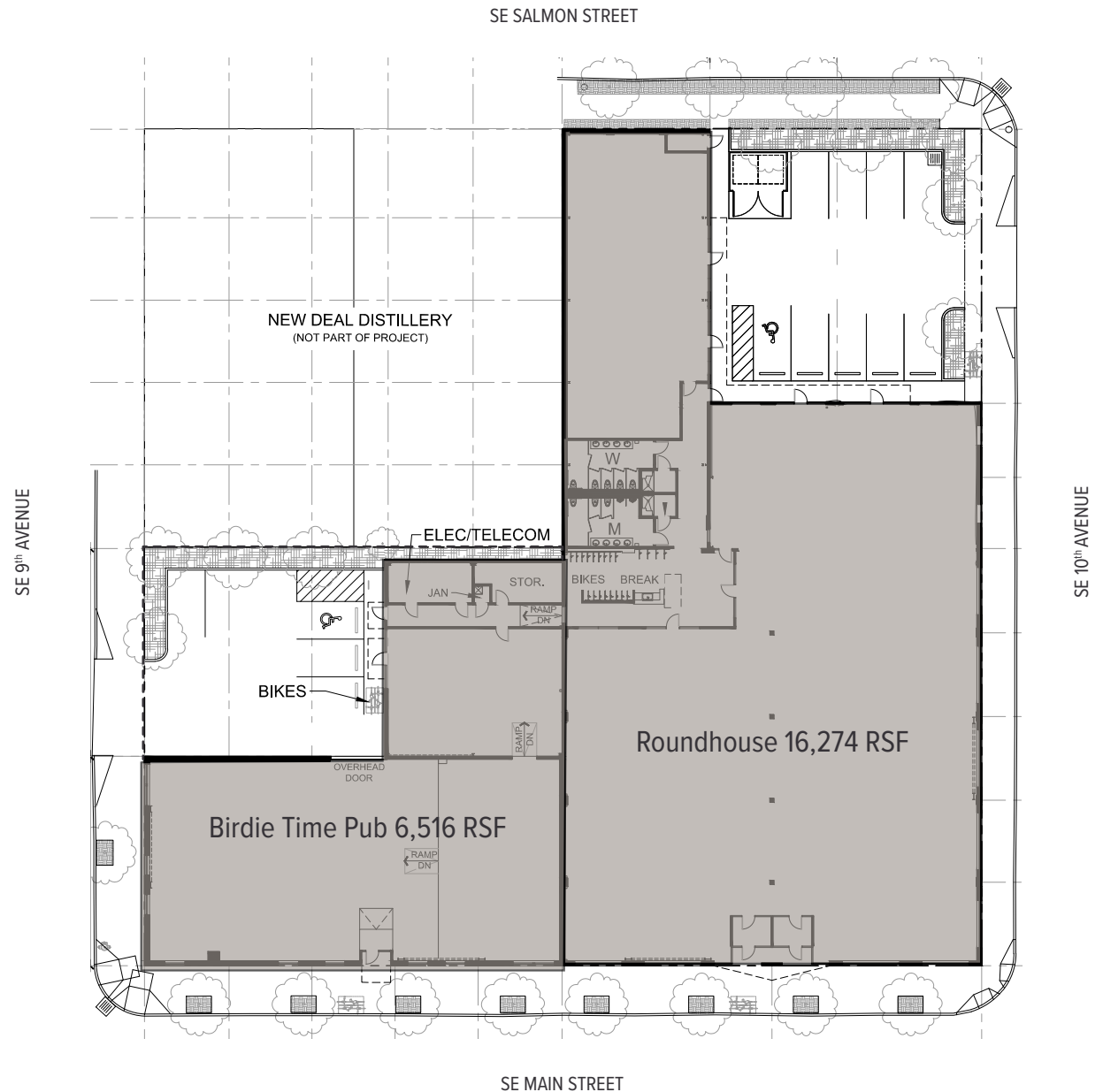



## SOUTH BLOCKS | TOTAL OF 48,972 RSF

- ± 4,500 RSF to ± 32,116 RSF available
- Large space includes crow's nest and mezzanine
- Off-street parking
- Interior bike storage and showers
- Clear heights 14-18 feet
- Heavy 3-phase power, full seismic upgrades
- Significant natural light - skylights
- Fully sprinklered
- 2 rooftop decks with city views

Second floor of SE quadrant

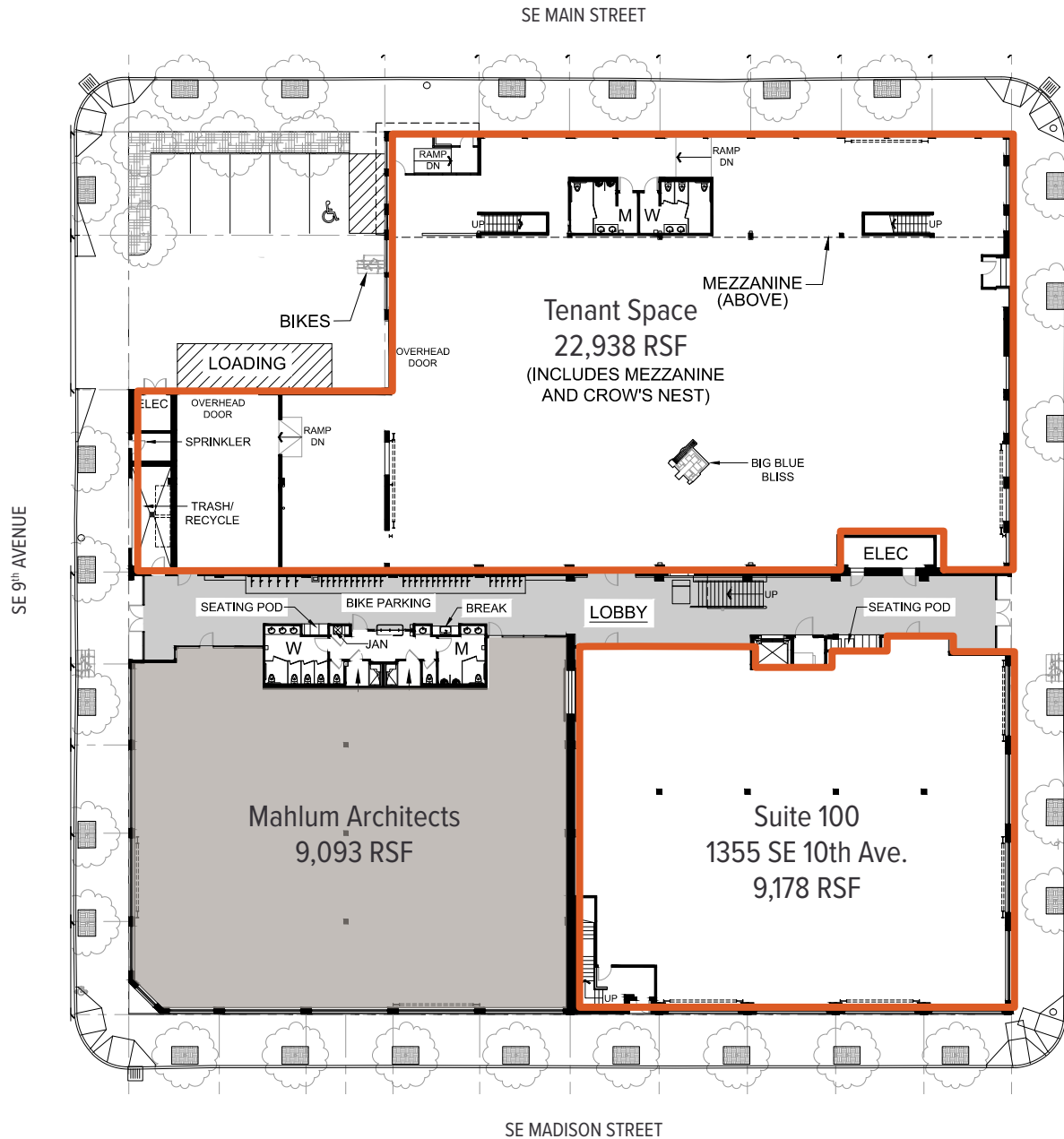
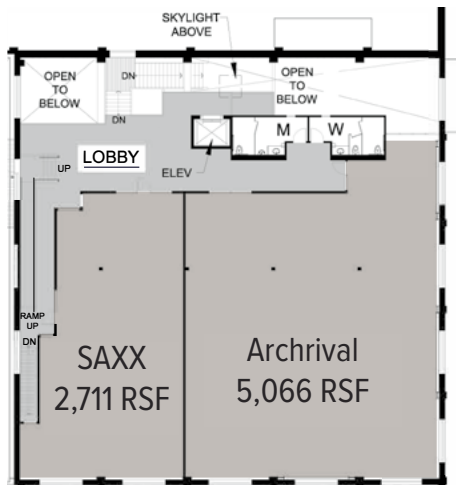



*Uses:*

*Creative office, including headquarters opportunity, software, engineering, clean tech, apparel, footwear, food and beverage*

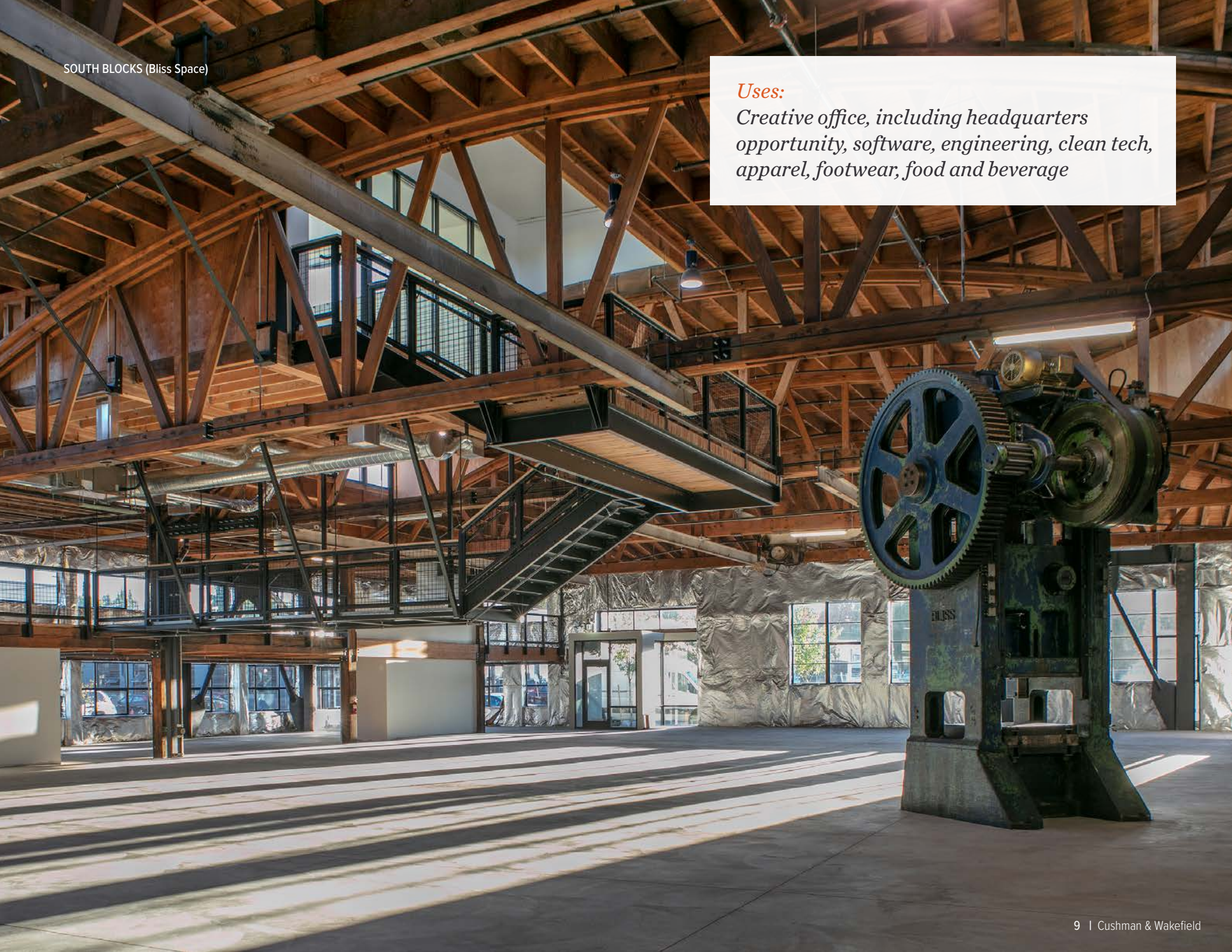

## Parking

- 4 parking lots
- 69 total stalls
- 1:1,000 parking ratio





## Multi-Modal Transportation bike + streetcar + bus + walk + drive

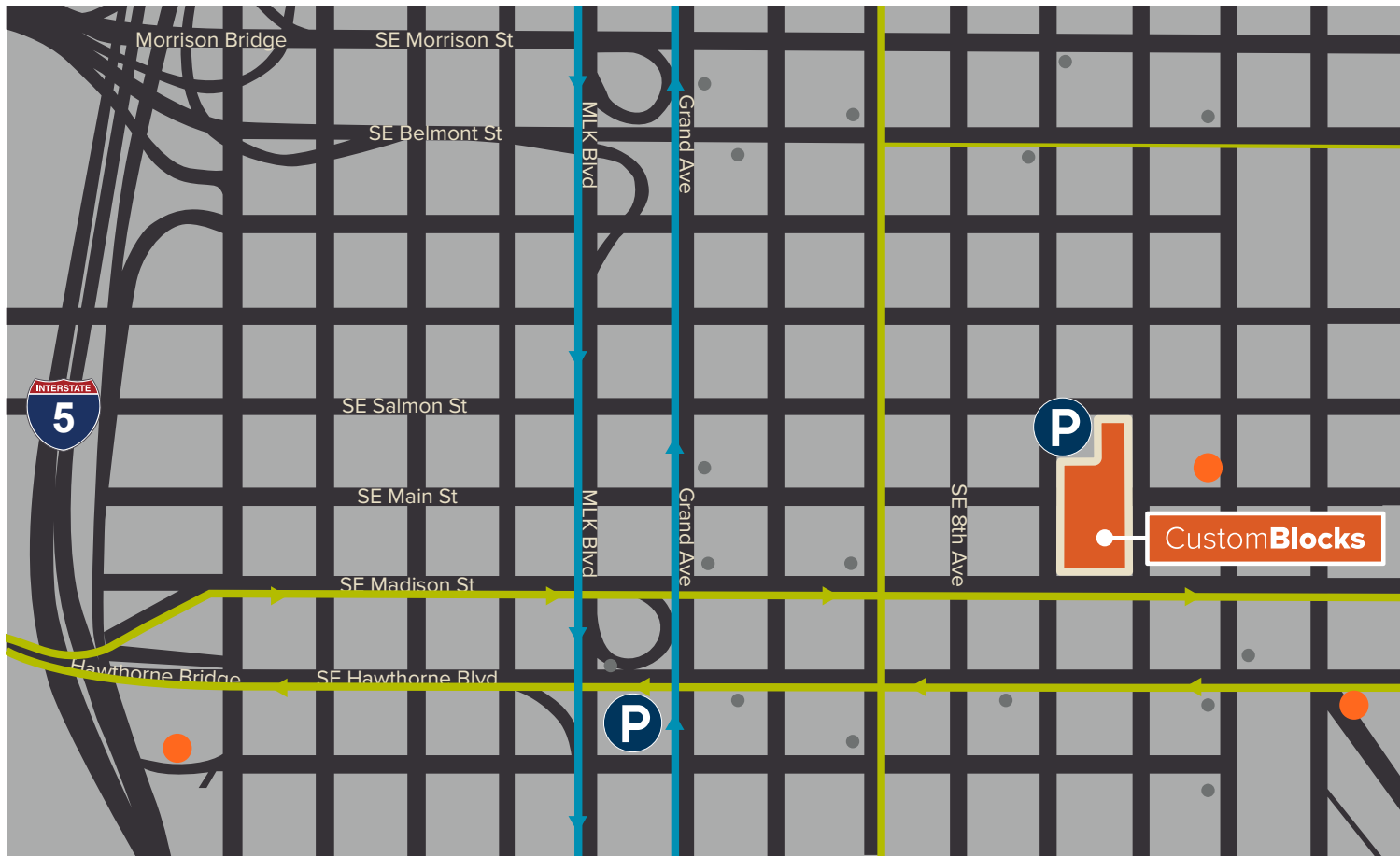

### Proximity to

Bus Stops	●	1-2 blocks
Streetcar		4-5 blocks
Bike Route	—	Adjacent
Biketown Hubs	●	1-3 blocks
Interstate 5		0.8 mile
Interstate 84		1.2 miles
Downtown		1 mile



***Biker's Paradise***  
Flat as a pancake,  
excellent bike lanes



***Walker's Paradise***  
Daily errands do not  
require a car



***Excellent Transit***  
Transit is convenient  
for most trips

## Location

- Located in Central Eastside –Buckman / Ladd’s Addition
- Strong bike and public transportation infrastructure
- Close to I-5 and Hawthorne and Morrison Bridges
- Biking/Walking distance to waterfront and downtown PDX
- Located in the newly expanded East Portland Enterprise zone & e-commerce overlay
- Proximity to new developments:
  - LOCA (formerly Goat Blocks): Market of Choice, Orchard Supply
  - The Redd, Ecotrust
- Proximity to some of the city’s finest restaurants and bars: Rolling River Spirits, Rogue, Growler Guys, Cascade Brewing, Buckman Coffee Factory, The Commons Brewery, Bunk Sandwiches, Renata
- Streetscape with Building/ Naming Rights/ Unique addresses for each space





## Amenities food + drink + shopping + entertainment

- Entertainment
- Cafes/Restaurants
- Retail
- Selected Top 10 Amenities
- Brewery/Distillery
- Fitness
- Services

1. 
2. 
3. 
4. 
5. 
6. 
7. 
8. 
9. 
10. 

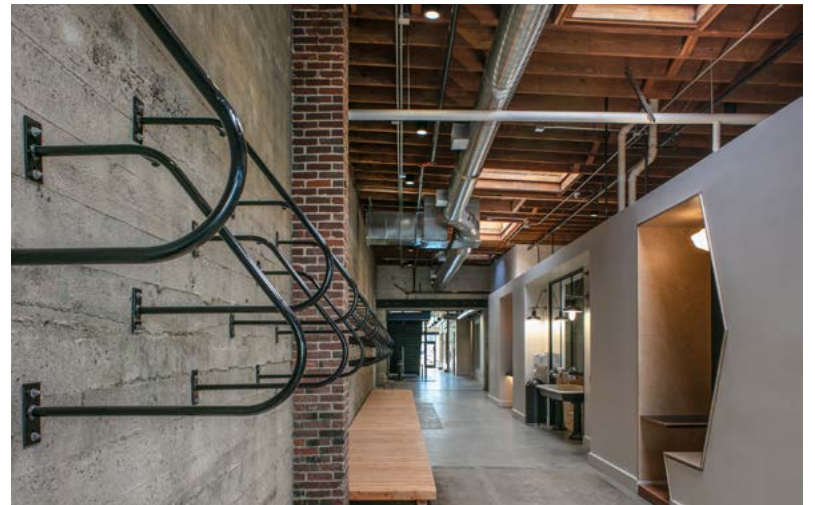
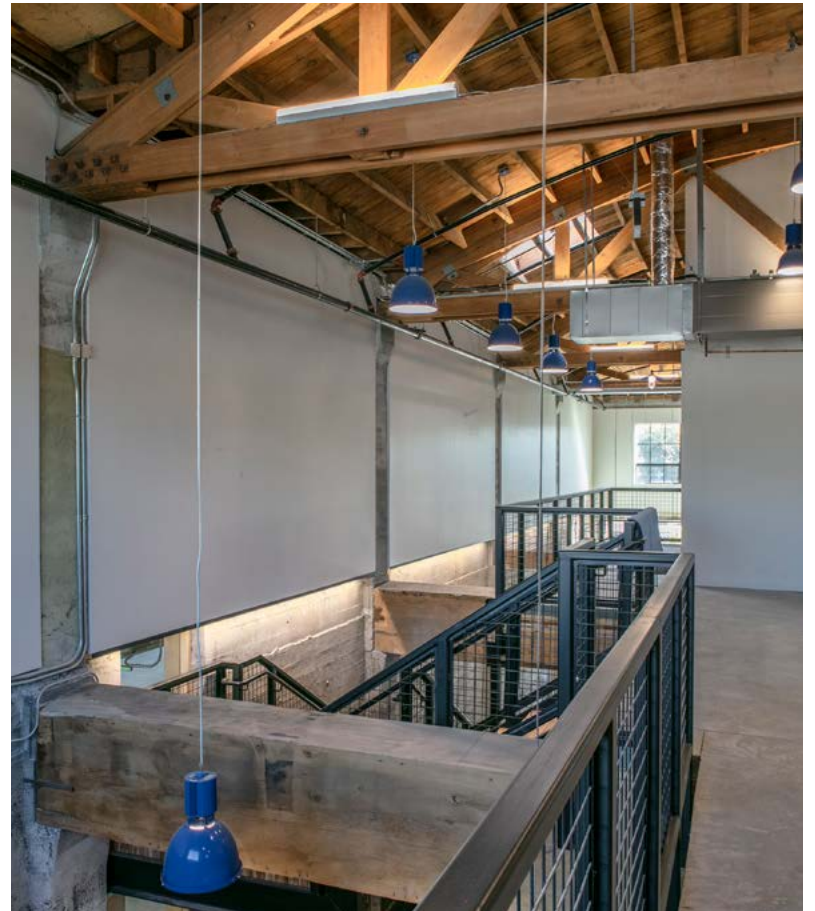

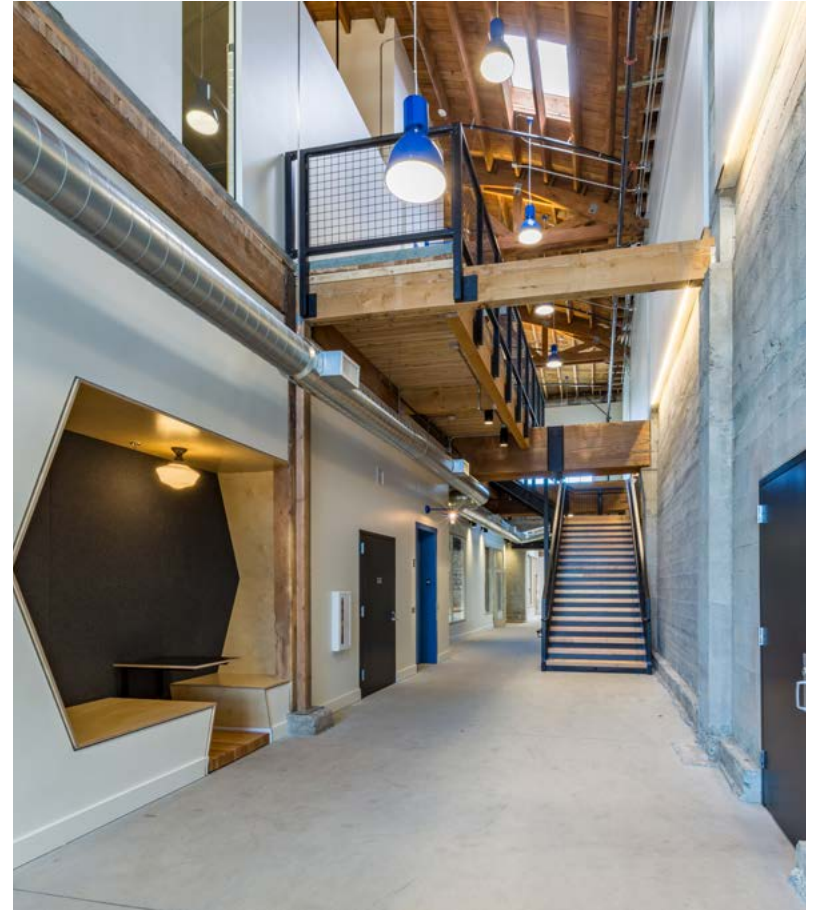





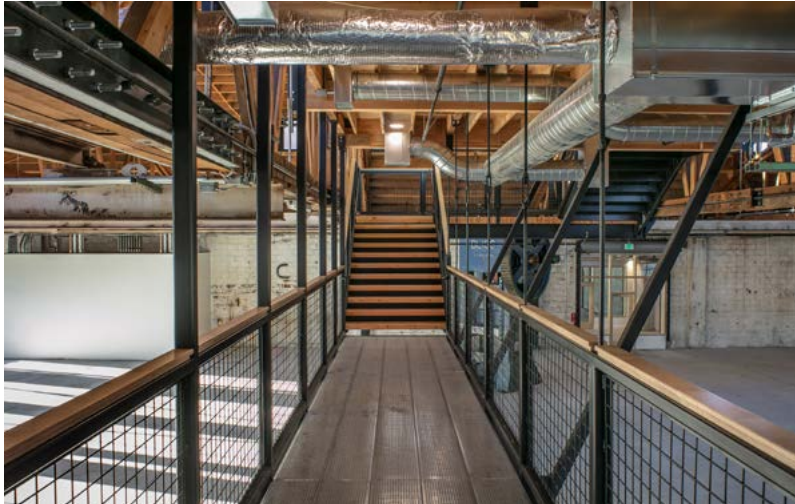



# CustomBlocks

**BRAD CARNESE**

503 279 1750  
brad.carnese@cushwake.com

**MARK CARNESE**

503 279 1764  
mark.carnese@cushwake.com

**DOUG DEURWAARDER**

503 279 1752  
doug.deurwaarder@cushwake.com

[cushmanwakefield.com](http://cushmanwakefield.com)

[customblocksportland.com](http://customblocksportland.com)

Developed By:



Joint Venture Partner:



Architect:



Builder:



Leasing:

