

Sublease Available

225 W. Randolph

CBRE



Rental Rate
Negotiable



Term
11/30/2022



Available
Q4 2020



Total SF
177,949 SF
Divisible



Seat Count
1,411

Single Floor Options:

26th (26,520 SF) or
29th Floor (20,000 SF)

Two Floor Option:

19th-20th Floor (46,195 SF)

Three Floor Option:

22nd-24th Floor (79,588 SF)

225 W. Randolph



225 W. Randolph

24th Floor

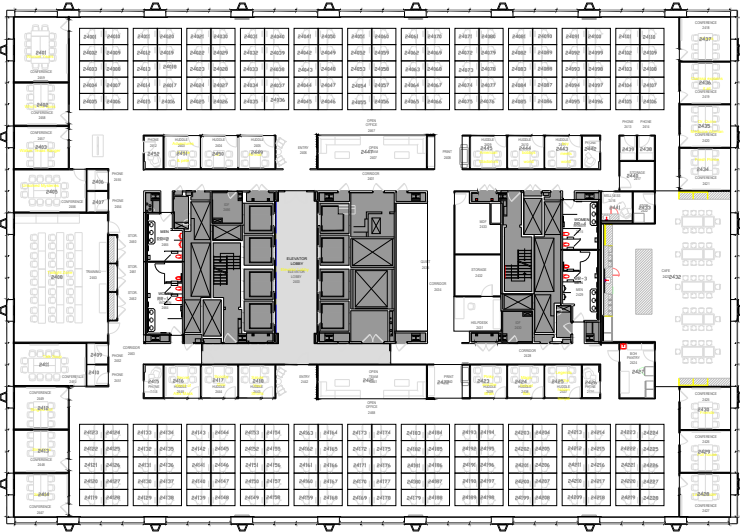

24th Floor – 26,520 SF, 220 workstations
Conf. Rooms - 28, Phone Rooms - 8

26th Floor



26th Floor – 26,517 SF, 240 workstations
Conf. Rooms - 16, Phone Rooms - 7

29th Floor

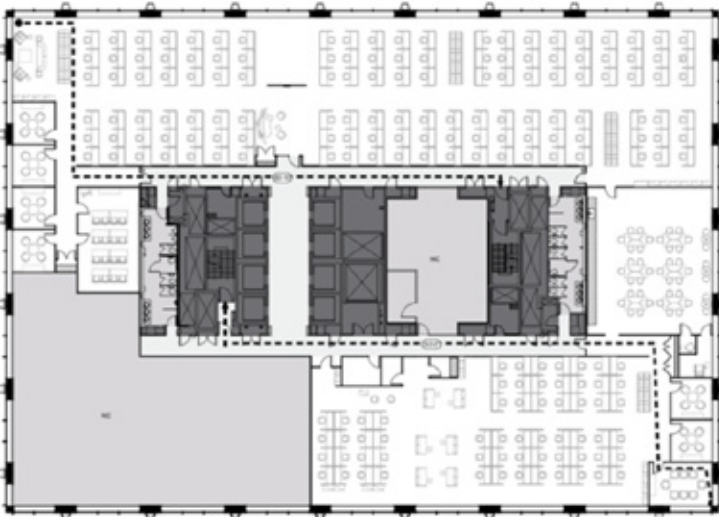

29th Floor – 20,000 SF, 175 workstations
Conf. Rooms - 7, Phone Rooms - 0



225 W. Randolph





For More Information Contact:



Holly Pearson

Transactions Coordinator
+1 312 935 1979
holly.pearson@cbre.com

Marcella LaHara

Senior Transaction Manager
+1 570 401 7796
marcella.lahara@cbre.com

Ian J Murphy

Director, Transaction Management
+1 312 925 9460
ian.murphy@cbre.com

Paul Reaumont

Vice Chairman
+1 312 935 1476
paul.reaumont@cbre.com



© 2019 CBRE, Inc. All rights reserved. This information has been obtained from sources believed reliable, but has not been verified for accuracy or completeness. You should conduct a careful, independent investigation of the property and verify all information. Any reliance on this information is solely at your own risk. CBRE and the CBRE logo are service marks of CBRE, Inc. All other marks displayed on this document are the property of their respective owners, and the use of such logos does not imply any affiliation with or endorsement of CBRE. Photos herein are the property of their respective owners. Use of these images without the express written consent of the owner is prohibited. PMSstudio_September2019