

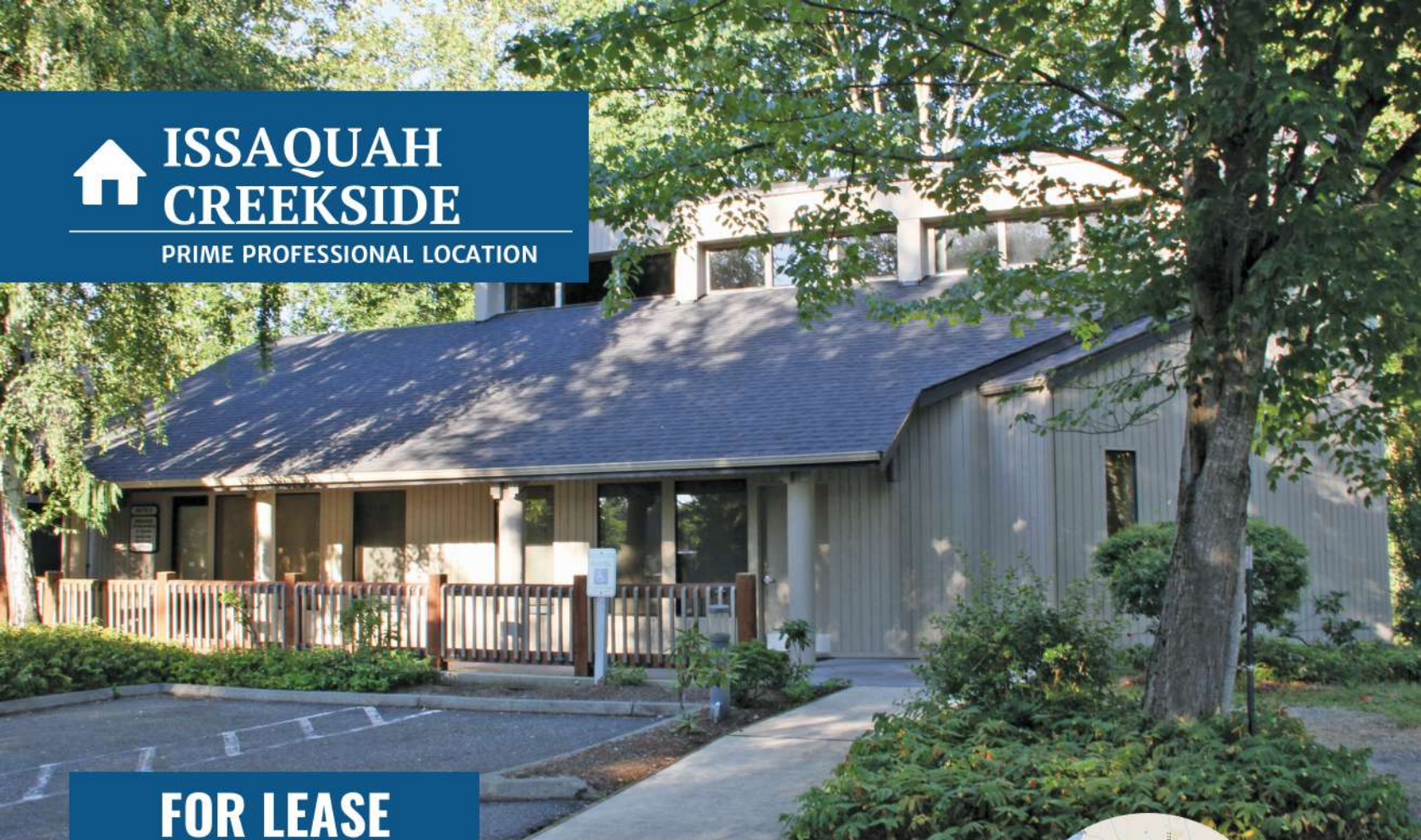

ISSAQUAH CREEKSIDE

PRIME PROFESSIONAL LOCATION



FOR LEASE

Premier location for any professional business.

Excellent for medical, dental, optometry, chiropractic, physical therapy, therapeutic spa, laboratory, law firm, or accounting office.

- + Fantastic Issaquah location with super easy and convenient access to I-90
- + Ample, free on-site parking directly in front of office and easy ADA access
- + Standalone building that has 2 stories with three entrances
- + Approximately 2,387 square feet in an amazing professional community



CALL TODAY!
425.786.1411

PHOTOS



Location, Location, Location
Right in central Issaquah on Gilman Blvd



Ample Space (2 Stories)
Floor plan allows for flexible layout



Issaquah Creek in your Backyard
Serene view from rooms is tranquil Creek



425.786.1411



IssaquahOffice@gmail.com



ISSAQUAH CREEKSIDE

PRIME PROFESSIONAL LOCATION

CALL TODAY! 425.786.1411

PHOTOS



Move in Ready and Turnkey

Wonderful demographics and large growing population in Issaquah



Perfect for Any Use

Attractive views, plenty of sun light, & abundant free parking in central Issaquah



Up to 10 Rooms + 3 Restrooms

Grow and scale your professional business with private rooms & conference room

1st/2nd Floor Available

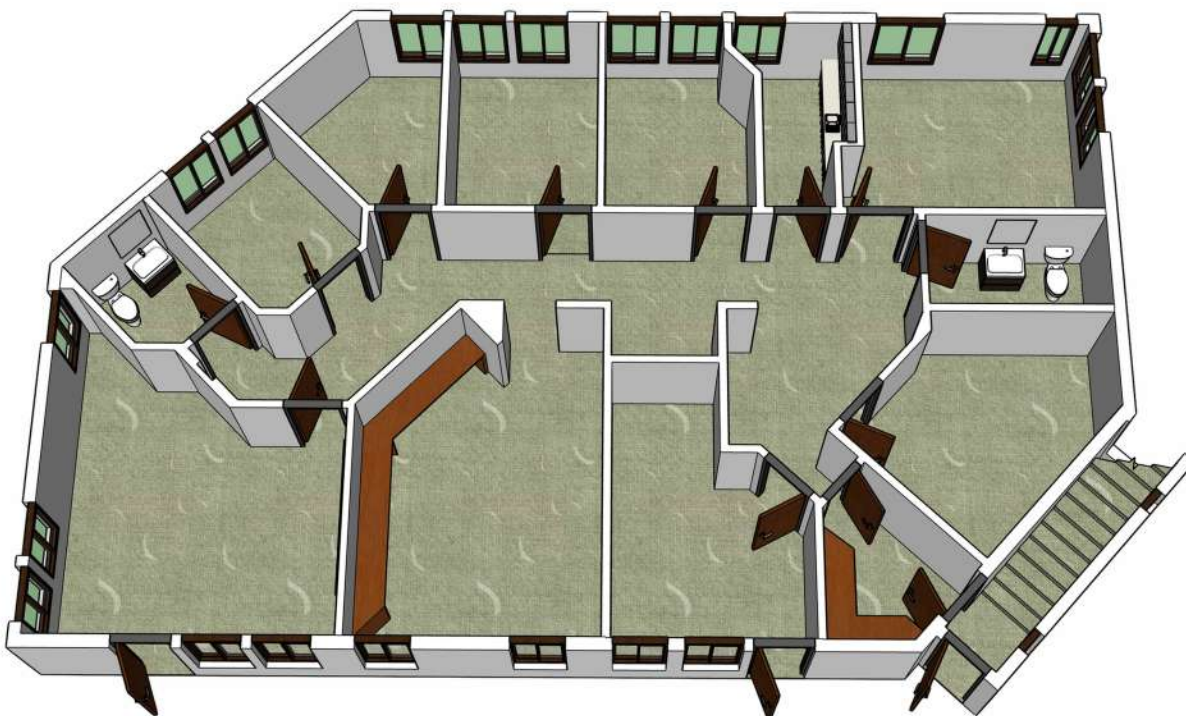

1st Floor: 1732 SF



SCAN ME

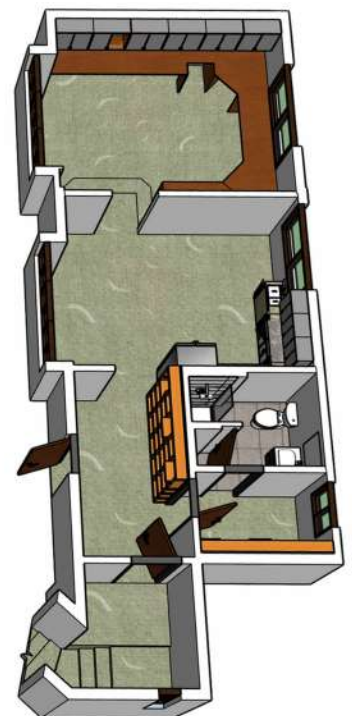

2nd Floor: 655 SF



SCAN ME



425.786.1411



IssaquahOffice@gmail.com

ISSAQUAH CREEKSIDE

PRIME PROFESSIONAL LOCATION

CALL TODAY!
425.786.1411

LOCATION

SURROUNDING OFFICE & AMENITIES



LOCATION OVERVIEW



Within 5 Miles

61,674

2020 Population

65,815

2025 PROJECTED POPULATION

\$200,747

AVERAGE HOUSEHOLD INCOME

\$163,252

MEDIAN HOUSEHOLD INCOME

901

TOTAL BUSINESSES

7,807

TOTAL EMPLOYEES

— BUSINESS PARK BOUNDARY

The Property benefits from shared parking and ingress/egress among all five condo units comprising the greater business