

300
E OSBORN ROAD
PHOENIX, AZ 85012

LEASING OPPORTUNITY

**FOR MORE INFORMATION
PLEASE CONTACT**

TRISHA TALBOT
Managing Director
602.952.3880
ttalbot@ngkf.com

KATHLEEN MORGAN
Managing Director
602.952.3815
kmorgan@ngkf.com



2398 E. Camelback Road, Suite 950 | Phoenix, Arizona 85016
Main: 602.952.3800 | www.ngkf.com

SUITE 100

±6,595 RSF

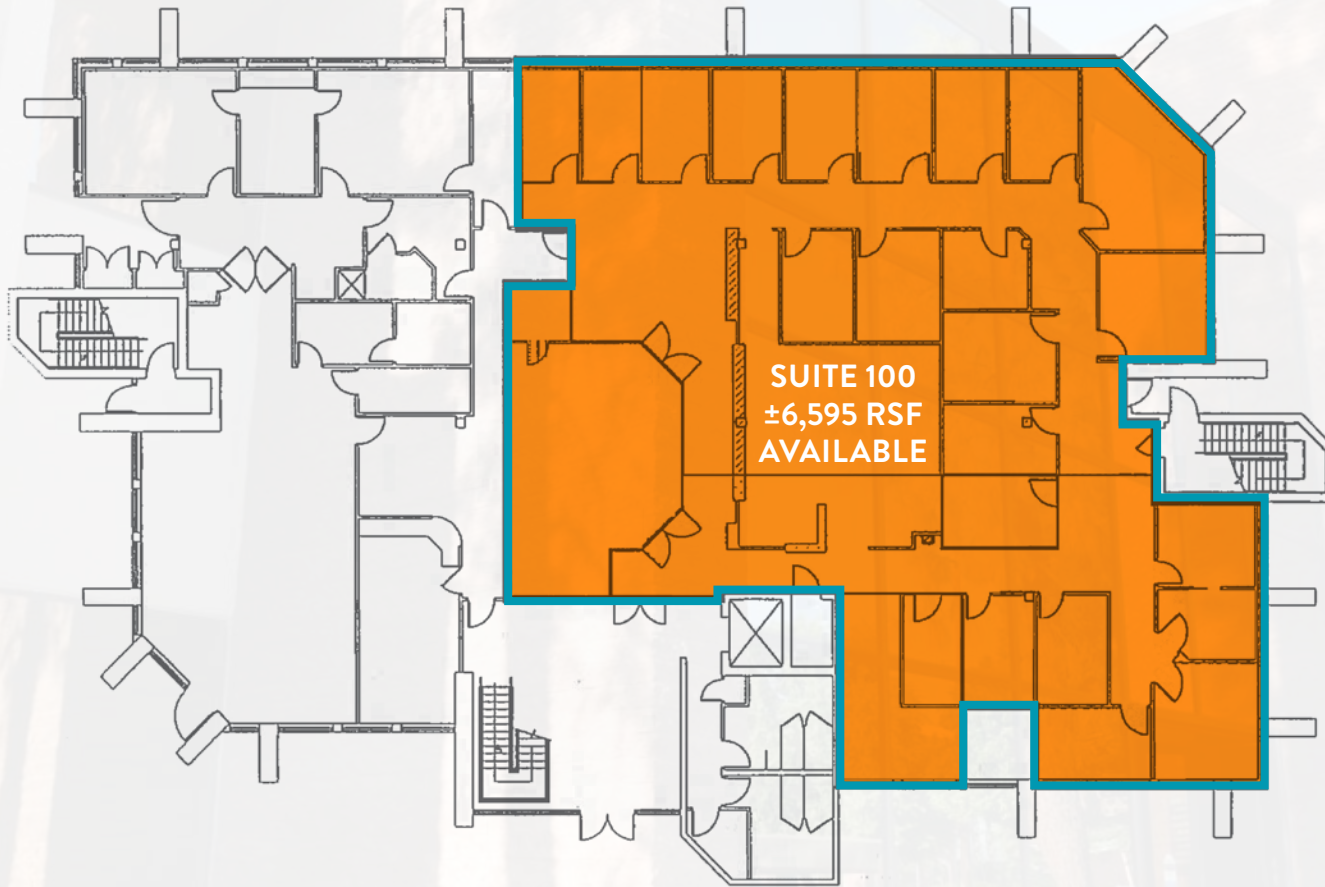

300

E OSBORN ROAD

PHOENIX, AZ 85012

PROPERTY FEATURES

- Multi-story, multi-tenant, medical office building
- ±6,595 RSF Available
- 3% Annual Increases
- Parking Ratio 5.6.00:1,000/SF (107 Spaces)
- Year Built 1982

LEASE RATE

- \$22.50 SF MODIFIED GROSS (Net Electric and Janitorial)
- TI'S AVAILABLE

LEASING OPPORTUNITY

FOR MORE INFORMATION
PLEASE CONTACT

TRISHA TALBOT
Managing Director
602.952.3880
ttalbot@ngkf.com

KATHLEEN MORGAN
Managing Director
602.952.3815
kmorgan@ngkf.com



2398 E. Camelback Road, Suite 950 | Phoenix, Arizona 85016
Main: 602.952.3800 | www.ngkf.com