

Architectural Design by Richard Meier & Partners Architects

SUBLEASE AVAILABLE

\$2.00 PER RSF BROKER BONUS

# 10960 WILSHIRE

[www.10960WILSHIRE.com](http://www.10960WILSHIRE.com)

LOS ANGELES, CA 90024



**BRAD GROSS**

310 689 2255

[brad.gross@cushwake.com](mailto:brad.gross@cushwake.com)

LIC #01098332

**MARQUES WILLIAMS**

310 424 4552

[marques.williams@cushwake.com](mailto:marques.williams@cushwake.com)

LIC #01935506

EXCLUSIVELY OFFERED BY



**AVAILABLE SPACE:** Approx. 40,214 RSF

22<sup>nd</sup> Floor: Approx. 25,998 RSF, encompassing the entire floor

21<sup>st</sup> Floor: Approx. 14,216 RSF, encompassing the majority of the floor

- Interconnecting stairwell links the two floors
- 21<sup>st</sup> & 22<sup>nd</sup> floors can be delivered separately

**RENTAL RATE:** \$3.85, per RSF, per Month, FSG

**SUBLEASE TERM:** Through July 14, 2020. Longer Direct Term Available

**DELIVERY DATE:** January 1, 2018 (anticipated)

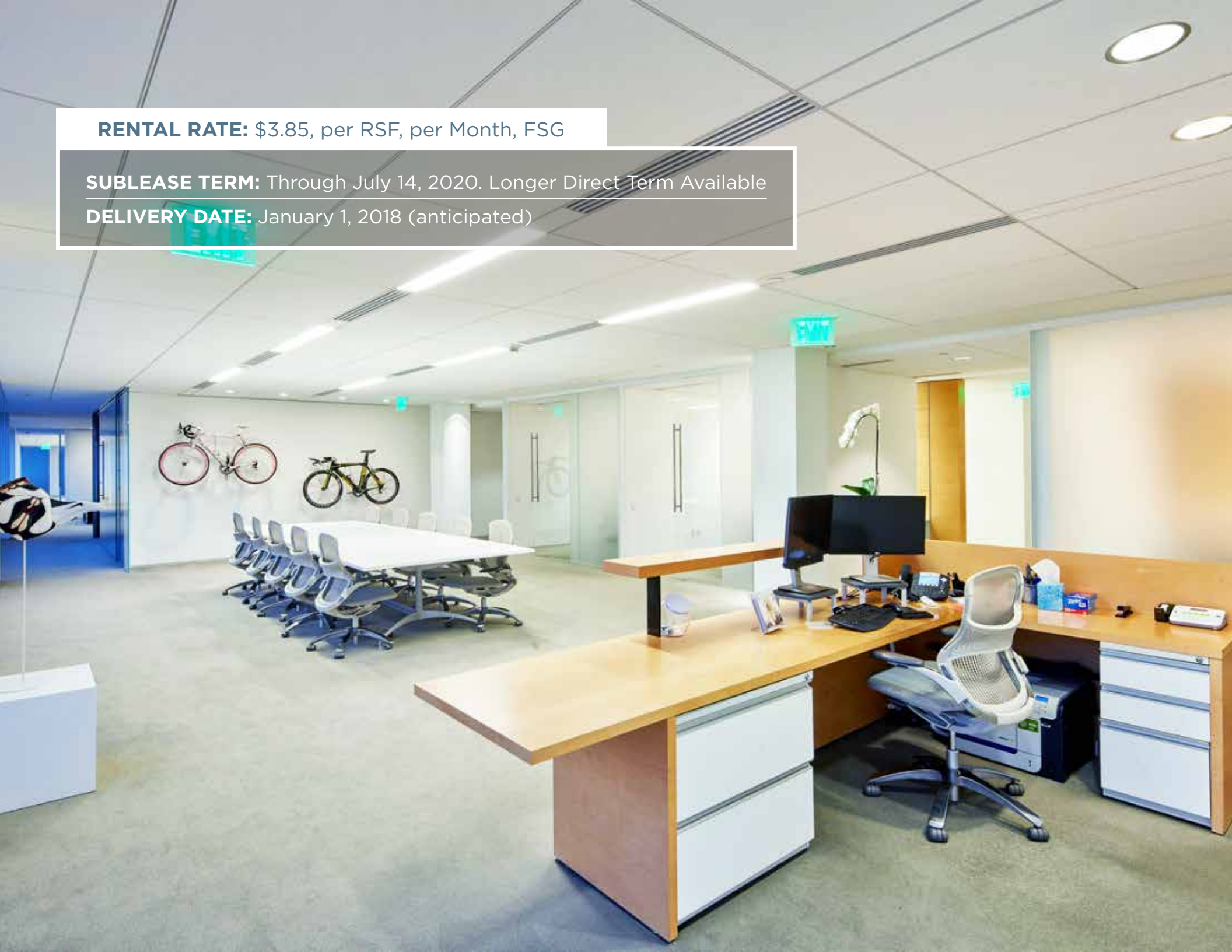



## SPACE DETAILS

- World class architectural design by Richard Meier & Partners Architects, who also designed the renowned Getty Center, Barcelona Museum of Contemporary Art and Museum of Television & Radio.
- Prime Westwood location offering one of the highest concentrations of restaurants, shopping and movie theaters anywhere in Los Angeles
- Unobstructed 360 degree views, offering glorious views from the Mountains to the Coast
- On-Site Equinox Gym, which has been voted “Best Gym in America”, by Fitness Magazine, offering top of the line fitness classes, yoga, pilates, pool, spa, Luxe Lounge and delicious food service at Earthbar
- Continuous window-line throughout, provides natural abounding light.
- Double door elevator ID on both floors

## PARKING

3/1,000 RSF at Prevailing Rates. Additional parking may be available directly though the building

## FURNITURE

Premises is being delivered fully furnished with custom built desking systems and workstations throughout.

# 21<sup>st</sup> FLOOR



# 22<sup>nd</sup> FLOOR

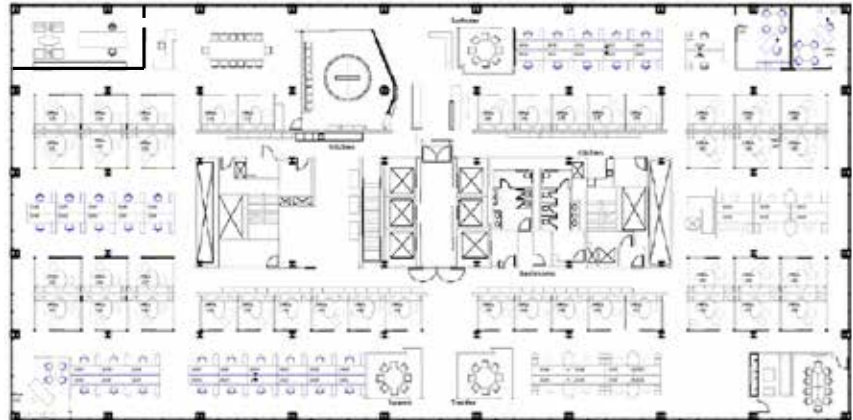



10960 WILSHIRE



**SUBLEASE AVAILABLE**

# 10960 WILSHIRE

[www.10960WILSHIRE.com](http://www.10960WILSHIRE.com)

**LOS ANGELES, CA 90024**

**BRAD GROSS**

310 689 2255

[brad.gross@cushwake.com](mailto:brad.gross@cushwake.com)

LIC #01098332

---

**MARQUES WILLIAMS**

310 424 4552

[marques.williams@cushwake.com](mailto:marques.williams@cushwake.com)

LIC #01935506