

FOR LEASE

±21,500 SF  
**CLASS A OFFICE SPACE**

**120 ROYALL STREET**  
Canton, MA

- NEW OPPORTUNITY
- NEW CAFÉ & LOBBY
- LANDMARK LOCATION
- 24/7 SECURITY
- PRIVATE DECK
- EXPOSED WAFFLE CEILING



# ±21,500 SF CLASS A OFFICE SPACE



## PROPERTY OVERVIEW

120 Royall Street offers ±123,000 SF of office space and is accessible via Exits 1 or 2A off of Interstate 93 in Canton, Massachusetts. Located at the junction of Interstate 95 and Route 128, with a backdrop of the pristine Blue Hills Reservation, the property has easy access to major highways, hotels, restaurants and shopping malls.



## BUILDING SPECIFICATIONS

- + **Total SF:** ±123,000 SF
- + **Available SF:** ±21,500 SF on the first floor
- + **Parking:** 4/1,000 SF



FOR LEASE

120 ROYALL STREET

Canton, MA



**NEW LOBBY**



**FLOOR PLAN**

**FLOOR 1: ±21,500 SF**

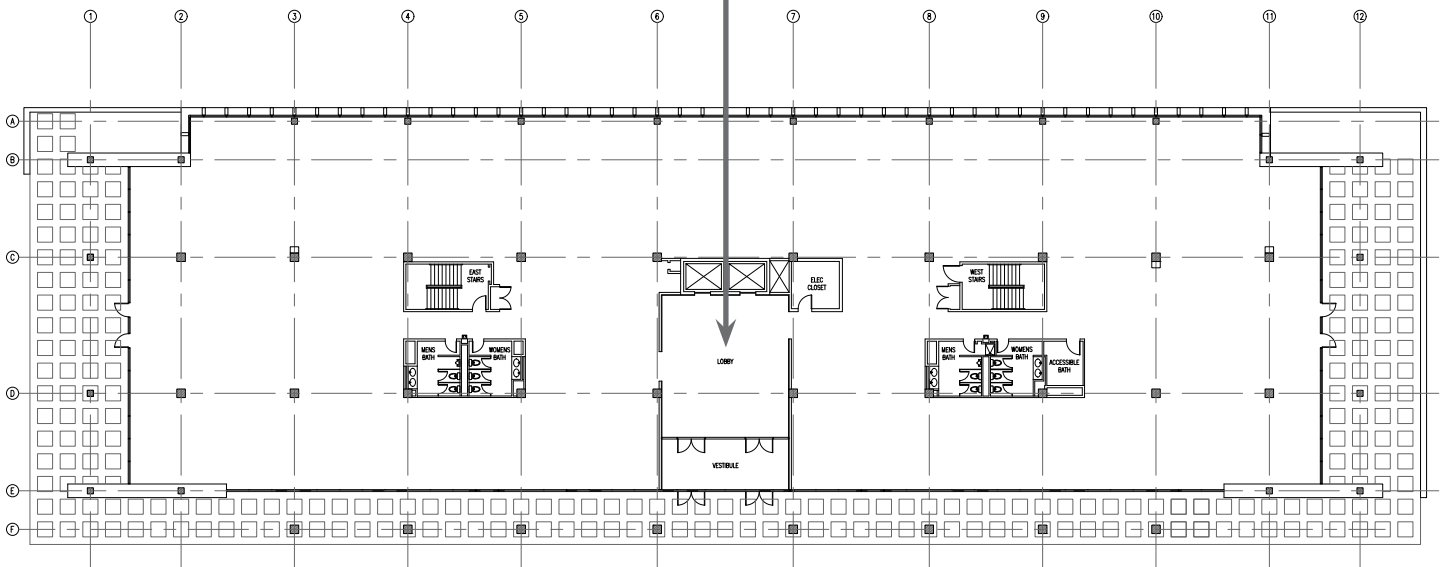

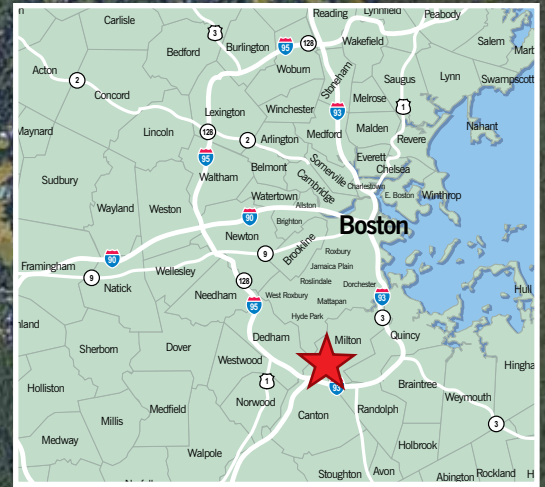

ROYALL STREET

120 ROYALL STREET



## CONTACT US

**ANDY MAJEWSKI**  
Executive Vice President/Partner  
+1 617 912 7024  
andy.majewski@cbre-ne.com

**MATT SICILIANO**  
First Vice President  
+1 617 912 7051  
matt.siciliano@cbre-ne.com

**PATRICK JOYCE**  
Vice President  
+1 617 912 6946  
patrick.joyce@cbre-ne.com

© 2017 CB Richard Ellis – N.E. Partners, LP. This information has been obtained from sources believed reliable. We have not verified it and make no guarantee, warranty or representation about it. Any projections, opinions, assumptions or estimates used are for example only and do not represent the current or future performance of the property. You and your advisors should conduct a careful, independent investigation of the property to determine to your satisfaction the suitability of the property for your needs. Photos herein are the property of their respective owners and use of these images without the express written consent of the owner is prohibited.

CBRE and the CBRE logo are service marks of CBRE, Inc. and/or its affiliated or related companies in the United States and other countries. All other marks displayed on this document are the property of their respective owners.