

65 GRAHAM AVENUE

CORNER OF MOORE STREET | WILLIAMSBURG

ksr
KASSIN SABBAGH REALTY



65 GRAHAM AVENUE

CORNER OF MOORE STREET | WILLIAMSBURG

SIZE

Corner	1,146 SF
Basement	500 SF
Inline	315 SF
Community Facility	1,729 SF

FRONTAGE

32' on Graham Avenue
24' on Moore Street
13' on Inline Space

CEILING HEIGHT

12'

ASKING RENT

Upon Request

POSSESSION

Immediate

COMMENTS

- All uses considered
- Brand new development near Broadway, Lorimer, and Flushing M, J, G subway stations
- Space delivered in white box condition
- ADA Elevator / Bathroom in place

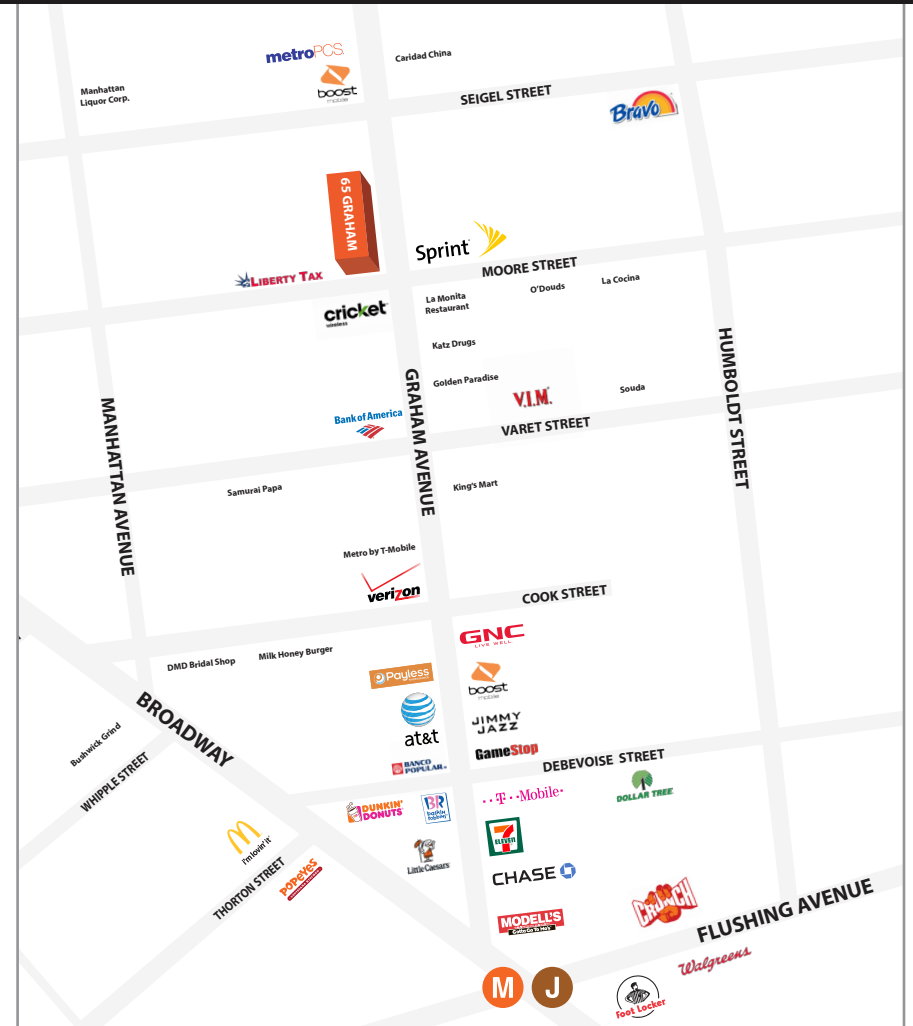

TRANSPORTATION RIDERSHIP REPORT

Station	Annual	Weekday	Weekend
Broadway ^G	1,385,797	4,452	4,592
Lorimer Street ^{J M}	1,619,602	5,161	5,583
Flushing Avenue ^{J M}	2,764,583	8,952	8,914

65 GRAHAM AVENUE

CORNER OF MOORE STREET | WILLIAMSBURG

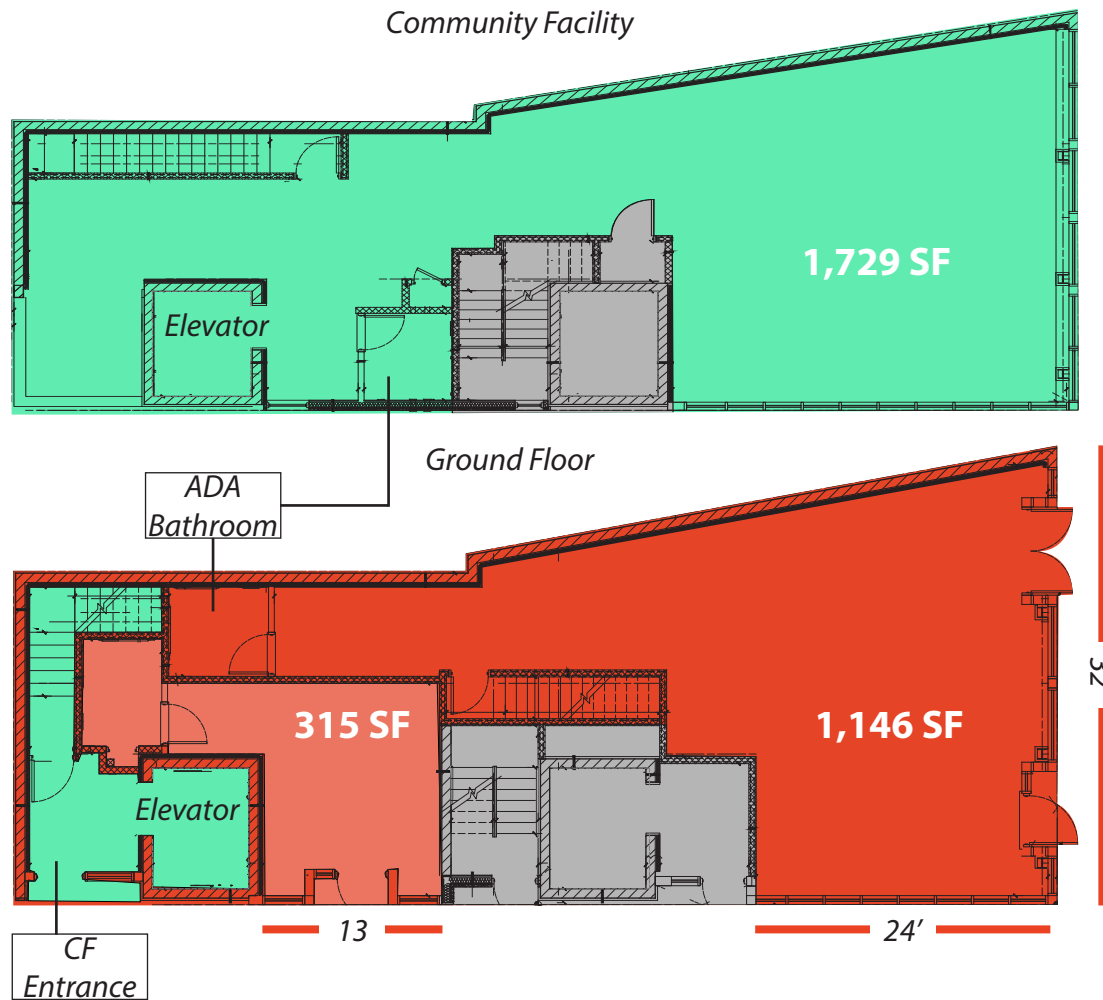

KASSIN SABBAGH REALTY
1385 Broadway 22nd floor
New York, NY 10018
(212) 417 - 9217
www.ksrny.com

CONTACT OUR BROKER(S) FOR MORE INFORMATION

JOSHUA BERKUN

JBerkun@ksrny.com

516.459.9251

All information supplied in this marketing presentation and/or flyer is from sources deemed reliable and is furnished subject to errors, omissions, modifications, removal of listings from sale/lease and to any listing conditions. Any square footage, dimensions, floor plans and/or technical data set forth are approximations and are subject to further elaboration/confirmation.