

ZITTELL & JACOBS PROFESSIONAL PLAZA

455 E. Thousand Oaks Boulevard • Thousand Oaks, California



**MEDICAL OR GENERAL OFFICE
AVAILABLE FOR PURCHASE OR LEASE**

CORY RICHMOND
VICE PRESIDENT
818.444.4915
crichmond@lee-re.com
License ID #01225466



Lee & Associates® - LA North/Ventura, Inc • CID #01191898
A Member of the Lee & Associates® Group of Companies
26050 Mureau Rd., Suite 101, Calabasas, CA 91302
P:818.223.4388 F:818.591.1450 • www.lee-associates.com

No warranty or representation is made to the accuracy of the foregoing information. Terms of sale or lease and availability are subject to change or withdrawal without notice.

ZITTELL & JACOBS PROFESSIONAL PLAZA

MEDICAL OR GENERAL OFFICE AVAILABLE FOR PURCHASE OR LEASE

PROPERTY HIGHLIGHTS

- Convenient access to 101 and 23 Freeways
- Suite 100 perimeter offices have their own HVAC control
- HVAC and electricity available 24/7
- Abundant parking
- Pride of Ownership evident
- Relaxing atmosphere with mature landscaping
- Abundant window line
- Thousand Oaks Boulevard Specific Plan
- Allows for medical or general office uses

AVAILABILITY

SUITE #	R.S.F.	LEASE RATE GENERAL OFFICE	LEASE RATE MEDICAL OFFICE	SALES RATE
102	1,431	Not available for lease	Not available for lease	N/A
100	2,913	\$1.85 MG+E+J	\$2.50 MG+E+J	N/A
100 & 102	4,344	N/A	N/A	Withheld

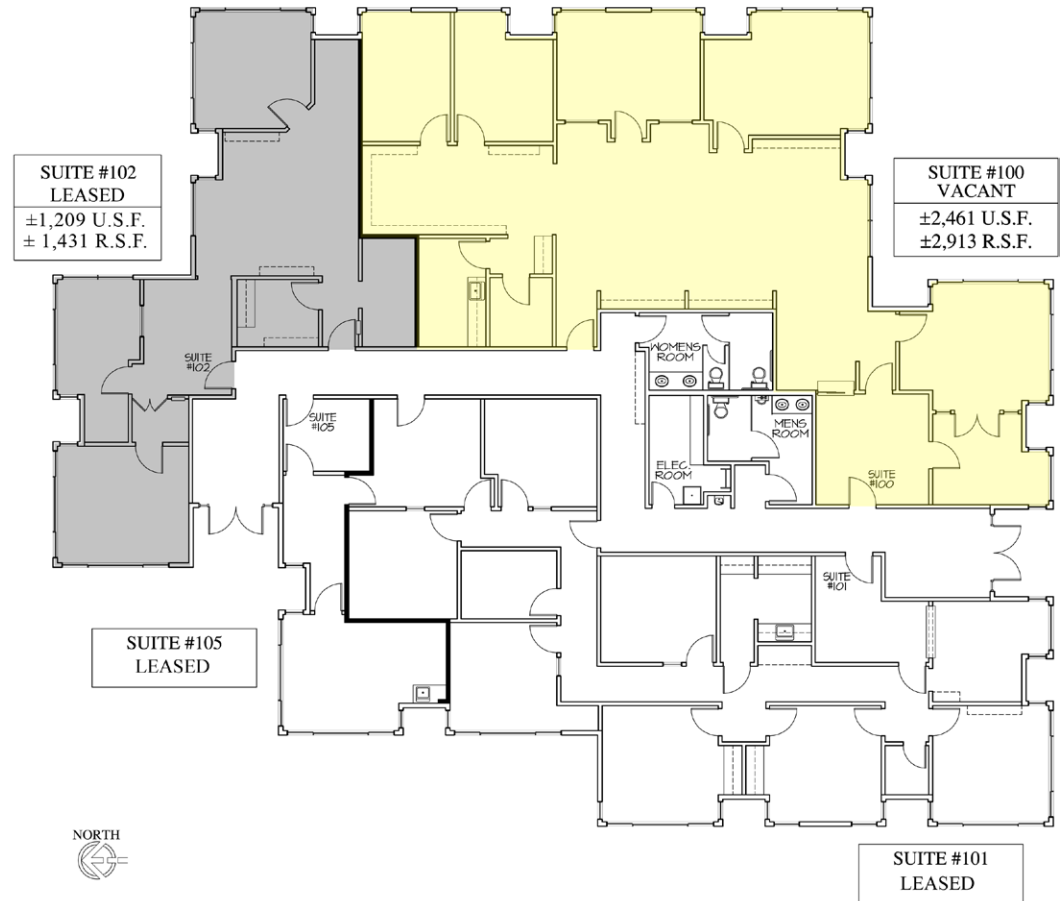

ZITTELL & JACOBS PROFESSIONAL PLAZA

MEDICAL OR GENERAL OFFICE AVAILABLE FOR PURCHASE OR LEASE

AMENITIES AERIAL



For more information
please contact:

CORY RICHMOND
VICE PRESIDENT
818.444.4915
crichmond@lee-re.com
License ID #01225466

LEE & ASSOCIATES®
COMMERCIAL REAL ESTATE SERVICES

Lee & Associates® - LA North/Ventura, Inc. • Corporate ID #01191898
A Member of the Lee & Associates® Group of Companies
26050 Mureau Rd., Suite 101, Calabasas, CA 91302 • P:818.223.4388 F:818.591.1450
www.lee-associates.com

No warranty or representation is made to the accuracy of the foregoing information. Terms of sale or lease and availability are subject to change or withdrawal without notice.