



1,960 - 8,112 sf

Artist's Rendering of 125 Metropolitan Avenue

# Medical. Retail. Restaurant. Fitness. Office Space.

125 Metropolitan Avenue, Williamsburg  
Between Berry & Wythe Streets

# Perfectly Situated at Williamsburg's 50 Yard Line

Tap in to North/South/East Williamsburg and Greenpoint Markets

## 125 Metropolitan Avenue

### Ground Floor Suggested Divisions (Cooking Vent in Place)

Space A	2,245 sf + 1,298 sf Mezz	Space D	3,940 sf + 1,298 sf Mezz
Space B	1,960 sf	Space E	2,740 sf
Space C	2,609 sf		
Total	6,814 sf + 1,298 sf Mezz		

**Ceiling Heights:** 17 ft, 9 ft on Mezzanine

**Frontage:** 21 ft 10 in - 75 ft

**Possession:** Immediate

# 125 METROPOLITAN AVE - SUGGESTED DIVISIONS

Can be combined

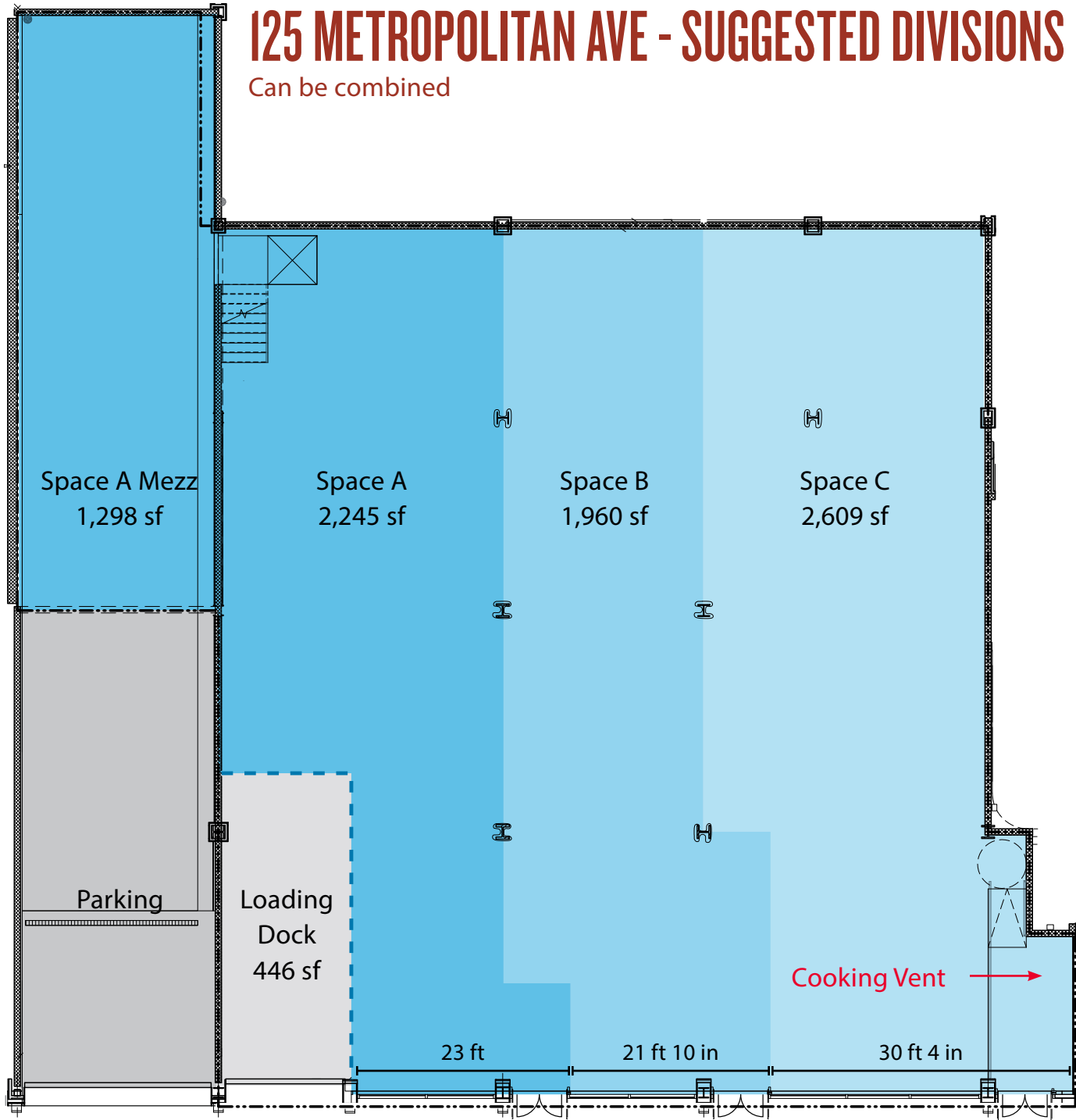

Metropolitan Avenue

# 125 METROPOLITAN AVE - SUGGESTED DIVISIONS

Can be combined

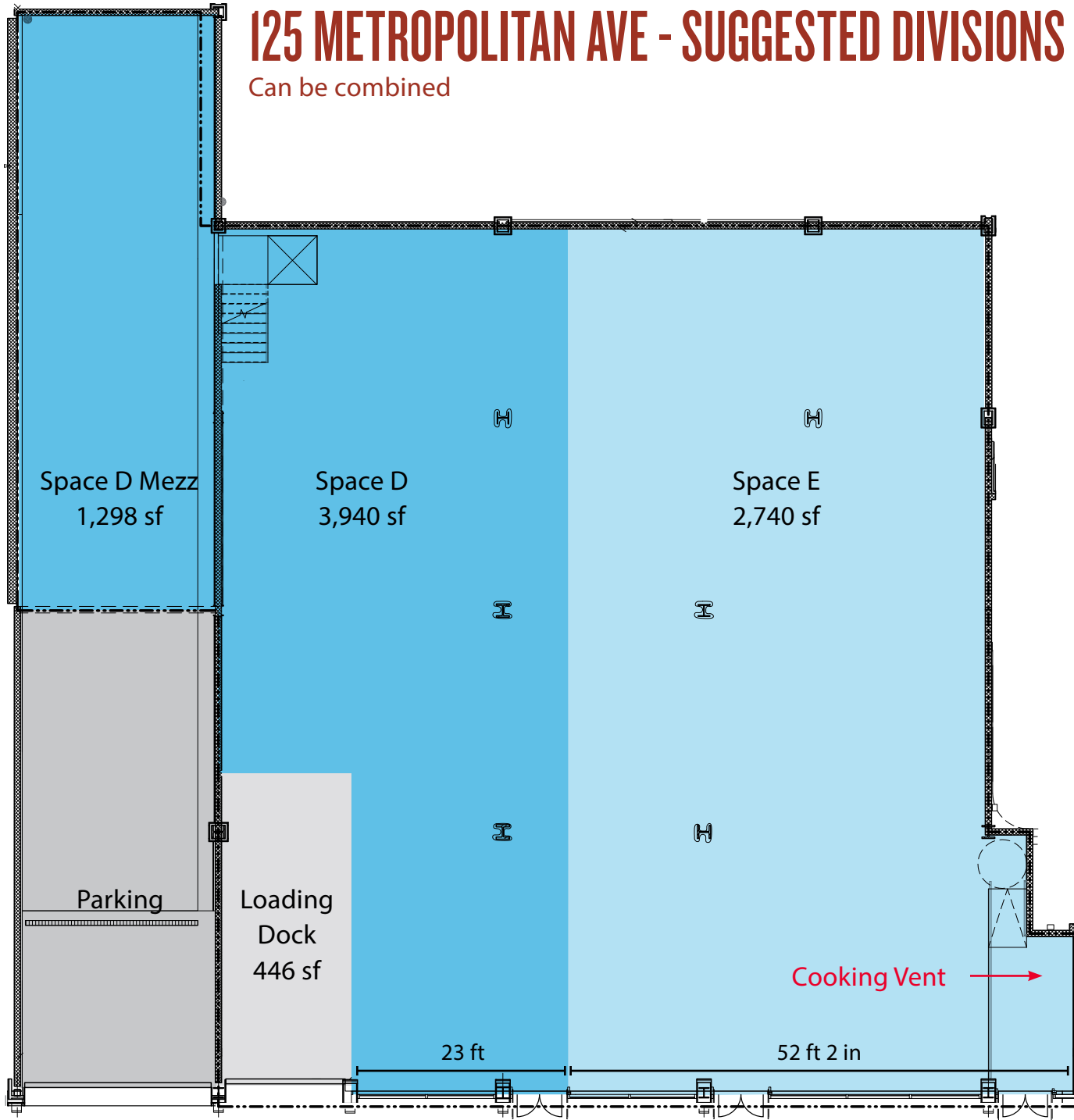

Metropolitan Avenue

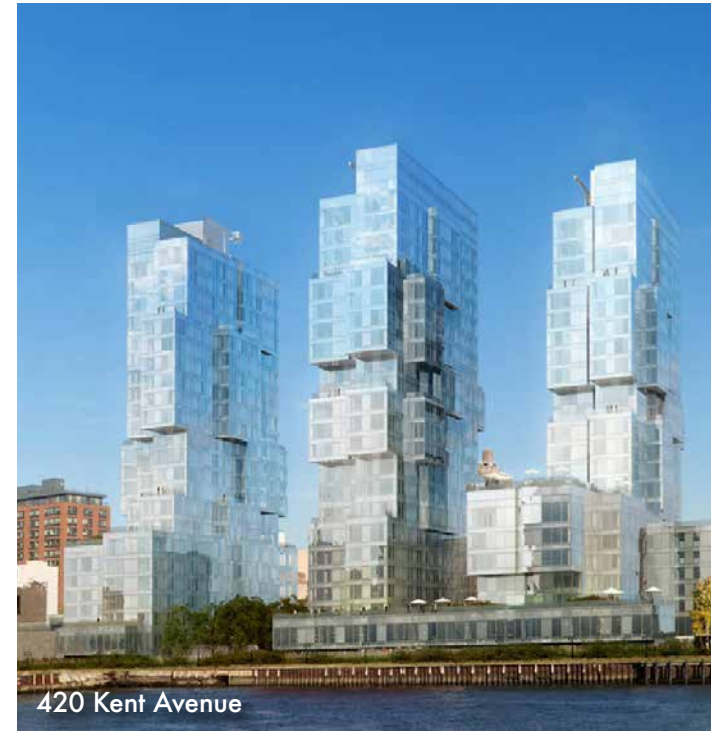

## Join Medical Providers:



### **Williamsburg: In Need of Medical Services**

Among NYC markets, Williamsburg was ranked #6 as a neighborhood with the highest need for a qualified health center (according to a study commissioned by Mayor Bill de Blasio). [\(Click to Read\)](#)



Whole Foods & WeWork



Apple



MUJI



Smorgasburg Food Festival



Nitehawk Cinema



Williamsburg Ferry

# AN ESTABLISHED — MARKET — THRIVING 24/7



New Residential Units

8,671

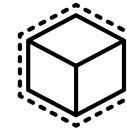

New Residential Space

11.6 Million SF

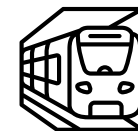

Annual Subway Riders

9.64 Million

Residential Development

Health & Wellness Providers

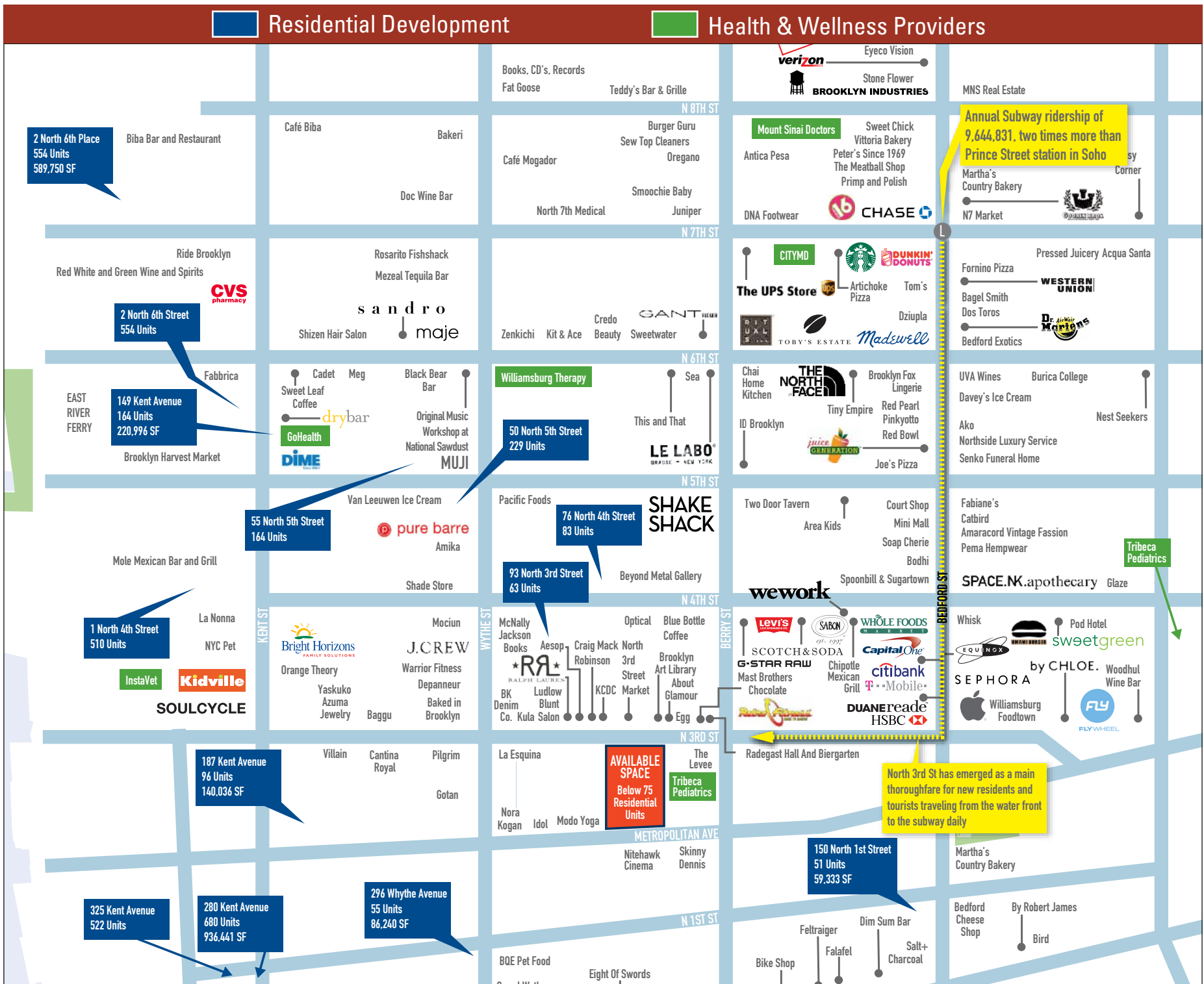

FOR MORE INFORMATION CONTACT EXCLUSIVE AGENT

**John Brod**  
212.400.9521  
jbrod@absre.com

**Mark Tergesen**  
212.400.9528  
mtergesen@absre.com

**Ben Waller**  
212.400.9515  
bwaller@absre.com

