

# FOR LEASE

521 E. Sprague  
Spokane, WA 99202



## U-District Redevelopment Ideal for Office Space, Lab or Technology Uses

## Space for Lease Divisible up to ±17,000 SF in the South U-District

### PROPERTY INFORMATION

- **Pricing:** \$14.00-16.00 / SF / NNN
- **Proposed Upgrades:** New roof, garage doors, additional windows, interior buildout allowance, new HVAC
- **Amenities:** Located adjacent to U-district Pedestrian Bridge, on-site and street parking, visible location

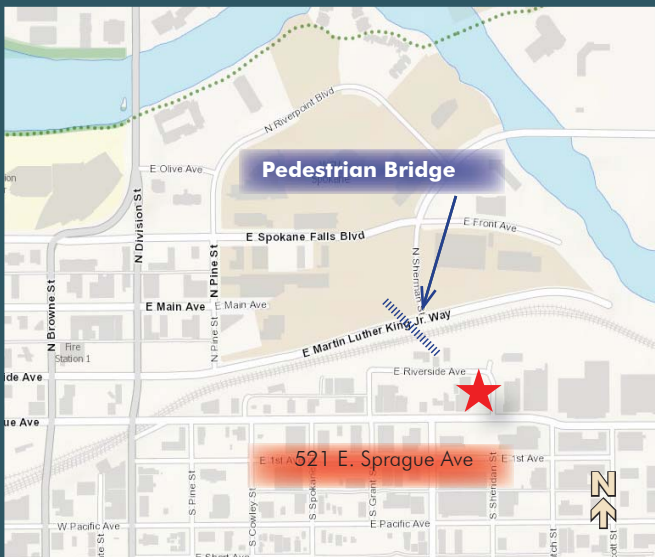

Office space leased here helps support  
Hutton Settlement Children's Home,  
a historic not-for-profit organization  
dedicated to providing a safe  
and loving home for children.  
[www.huttonsettlement.org](http://www.huttonsettlement.org)

Craig Soehren  
509.755.7548 or [craigs@khco.com](mailto:craigs@khco.com)



No warranty or representation, expressed or implied, is made by Kiemle & Hagood Company, its agents or its employees as to the accuracy of the information contained herein. All information furnished is from sources deemed reliable and submitted subject to errors, omissions, change of terms and conditions, prior sale, lease or financing, or withdrawal without notice. No one should rely solely on the above information, but instead should conduct their own investigation to independently satisfy themselves.

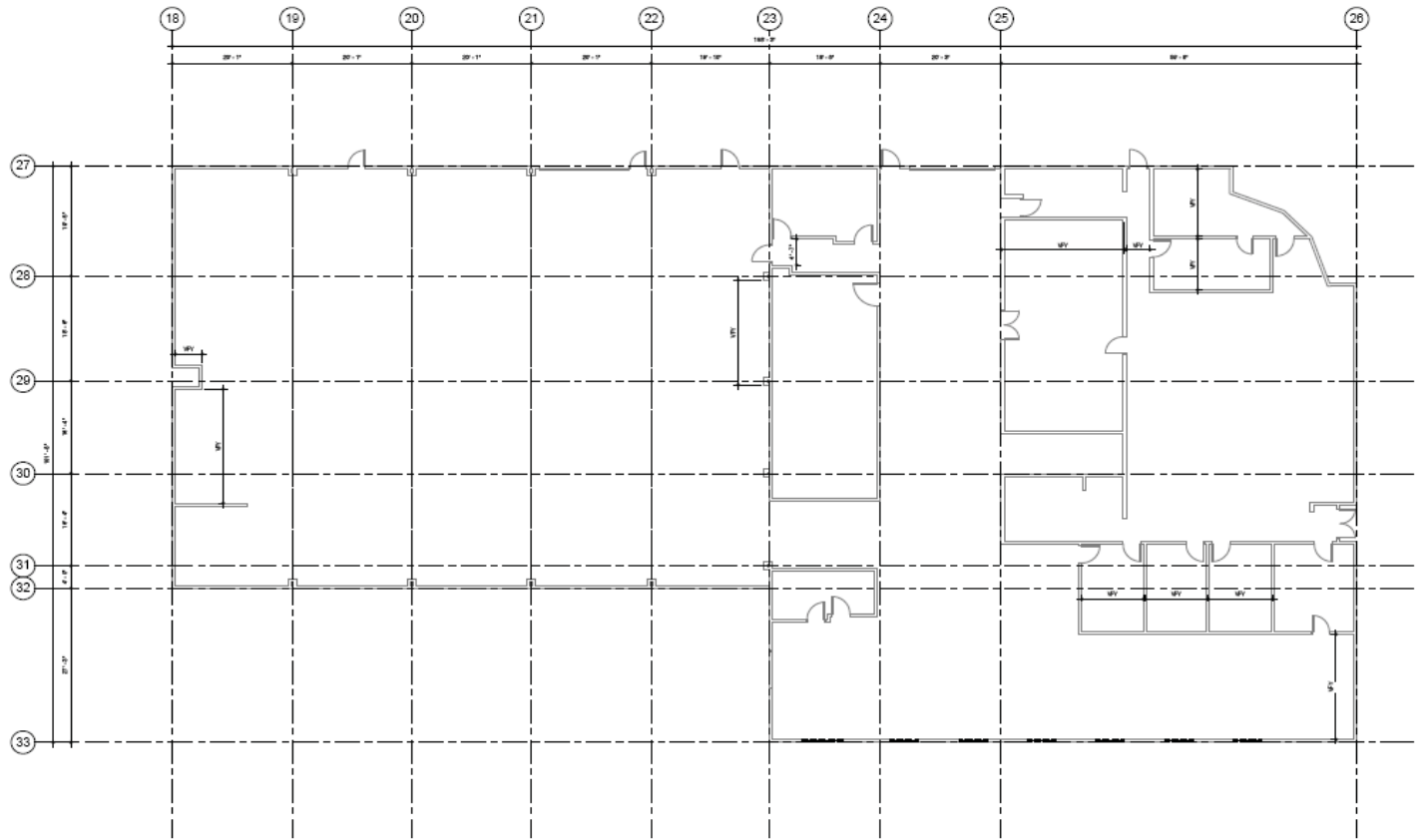

AS BUILT PLAN  
1/8" = 1'-0"

MAIN FLOOR PLAN  
A2.1

521 E SPRAGUE  
621 EAST SPRAGUE  
SPOKANE WASHINGTON 99202  
PARCEL #



uptic studies



**Space for  
Lease  
Divisible up  
to ±17,000 SF  
in the South  
U-District**

**KIEMLE &  
HAGOOD  
COMPANY**

Craig Soehren  
509.755.7548 or craigs@khco.com

 509.838.6541  
khco.com

Kiemle & Hagood Company respects the intellectual property of others:  
If you believe the copyright in your work has been violated through this Website, please contact our office for notice of claims of copyright infringement. For your complaint to be valid under the Digital Millennium Copyright Act of 1998 (DMCA), you must provide the following information when providing notice of the claimed copyright infringement: Identify the material on the Website that you believe infringes your work, with enough detail so that we may locate it on the Website; provide your address, telephone number and email address; provide a statement that you have a good faith belief that the disputed use is not authorized by the copyright owner, its agent, or the law; provide a statement that the information in the notification is accurate, and under penalty of perjury, that the complaining party is authorized to act on behalf of owner of an exclusive right that is allegedly infringed; provide your physical or electronic signature. Upon receiving your complaint, Kiemle & Hagood Company will, upon review, remove content that you believe infringes your copyright if the complaint is found valid.