



±31,816 SF INDUSTRIAL SPACE

FOR LEASE

170 ALEXANDRA WAY | CAROL STREAM, IL 60188

MICHAEL MARCONI, SIOR

847.588.5689

michael.marconi@transwestern.com

JUSTIN LERNER, SIOR

847.588.5665

justin.lerner@transwestern.com

JOE KARMIN

847.588.5670

joe.karmin@transwestern.com

±31,816 SF INDUSTRIAL SPACE

FOR LEASE

170 ALEXANDRA WAY | CAROL STREAM, IL 60188



SPECIFICATIONS

- Building Size: ±38,616 SF
- Available Size: ±31,816 SF
- Land Area: ±2.5 AC
- Office Area: ±4,500 SF
- Ceiling Height: ±24'
- Loading: 1 Int Dock / 1 Covered Ext Dock / 2 DID
- Bay Size: 32' x 40'
- Power: 400 Amps
- Parking: 38 Cars
- Year Built: 1995
- Heating: Gas Forced Units
- Sprinklered: Fully
- Real Estate Taxes: \$1.39 PSF (2017)
- Lease Rate: \$5.50 PSF Net

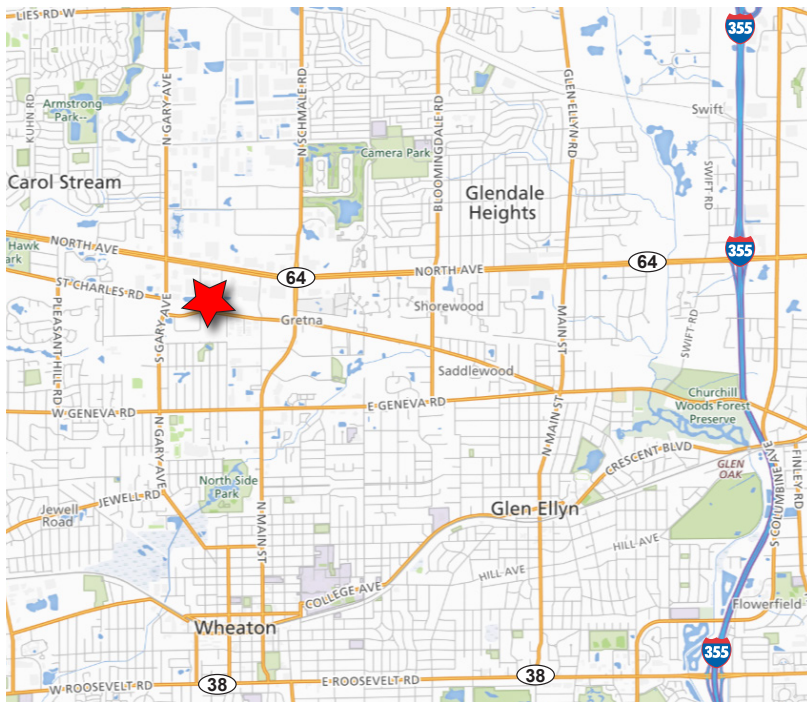

HIGHLIGHTS

- High-image facility right off of North Avenue
- Unique showroom / bullpen
- Large land site
- Well-maintained building
- Low DuPage County taxes
- Great access to I-355 via North Avenue

MICHAEL MARCONI, SIOR
 847.588.5689
 michael.marconi@transwestern.com

JUSTIN LERNER, SIOR
 847.588.5665
 justin.lerner@transwestern.com

JOE KARMIN
 847.588.5670
 joe.karmin@transwestern.com

±31,816 SF INDUSTRIAL SPACE

FOR LEASE

170 ALEXANDRA WAY | CAROL STREAM, IL 60188

T TRANSWESTERN®

SITE PLAN

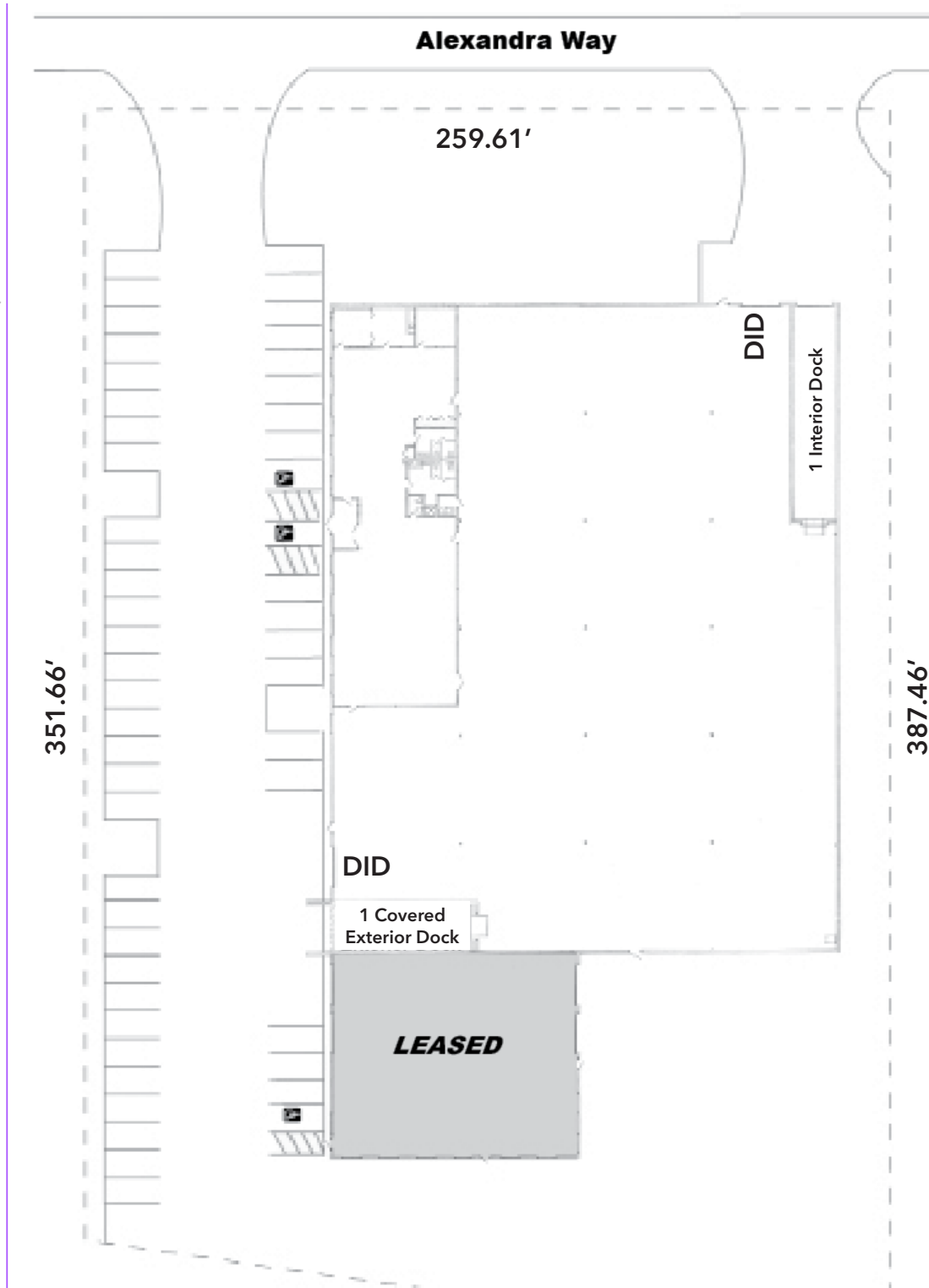

MICHAEL MARCONI, SIOR

847.588.5689

michael.marconi@transwestern.com

JUSTIN LERNER, SIOR

847.588.5665

justin.lerner@transwestern.com

JOE KARMIN

847.588.5670

joe.karmin@transwestern.com

The information provided herein was obtained from sources believed reliable; however, Transwestern makes no guarantees, warranties or representations as to the completeness or accuracy thereof. The presentation of this property is submitted subject to errors, omissions, change of price or conditions, prior sale or lease, or withdrawal without notice. Copyright © 2019 Transwestern.