

PATRIOT PARK VII
565 Space Center Drive
COLORADO SPRINGS, CO 80915



PATRIOT
EQUITIES

NOW AVAILABLE FOR LEASE



Peter Scoville
Principal
(719) 418-4063
pscoville@coscommercial.com

Greg Phaneuf
Principal
(719) 418-4064
gphaneuf@coscommercial.com

 **CUSHMAN &
WAKEFIELD**

**Colorado Springs
Commercial**

PATRIOT PARK VII

565 Space Center Drive

COLORADO SPRINGS, CO 80915



PATRIOT
EQUITIES

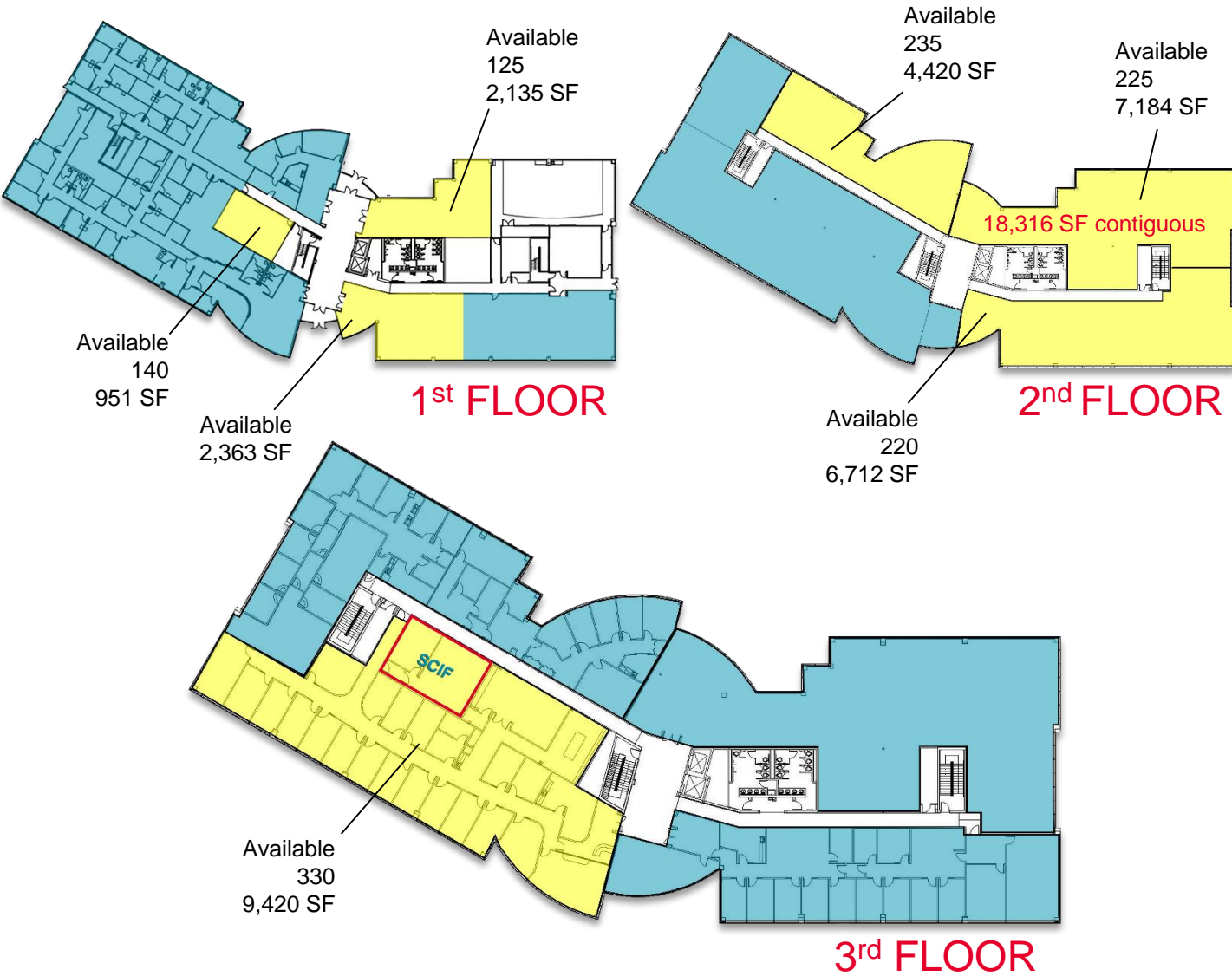

BUILDING FEATURES

BUILDING QUALITIES

BUILDING SIZE	89,624 RSF
AVAILABLE SPACE	951-18,316 RSF
LEASE RATE	From \$15.50 per RSF NNN
EXPENSES	\$7.80 per RSF (2017 estimate)
TENANT IMPROVEMENTS	Negotiable
PARKING	4 spaces per 1,000 RSF
YEAR CONSTRUCTED	2009

- Located in Patriot Park, the preeminent government contractor business park in Colorado Springs.
- Adjacent to Peterson AFB – easy access to north and west gates.
- Within ten minutes of Colorado Springs Airport.
- Restaurants, hotels, banks and full array of amenities in close proximity.
- Common conference facility and building workout room with showers and lockers.

Peter Scoville
Principal
(719) 418-4063
pscoville@coscommercial.com

Greg Phaneuf
Principal
(719) 418-4064
gphaneuf@coscommercial.com



Colorado Springs
Commercial