



Carolyn Avenue Land

3108 & 3118 S. Carolyn Avenue, Sioux Falls, SD

Property Features

- Two parcels of commercial land to be sold together
- Up to 109,732 total sq. ft. for sale
- Approximately 220 feet of Carolyn Avenue frontage
- Zoned C-4 Regional Commercial
- Near 41st Street & I-29
- **Pre-approved site for Wyndham Wingate & Wyndham Hawthorn hotels**

Pricing

- **List price reduced to \$9.00/sq. ft.**
- 2017 Real Estate Taxes are \$12,516.00

Location

- Located on S. Carolyn Avenue one block from 41st Street
- Some of the area neighbors include: Empire Mall, Century Theaters, Carnival Brazilian Grill, Outback Steakhouse, Menard's, Chili's, Microtel, Candlewood Suites, Staybridge Suites, My Place Hotel

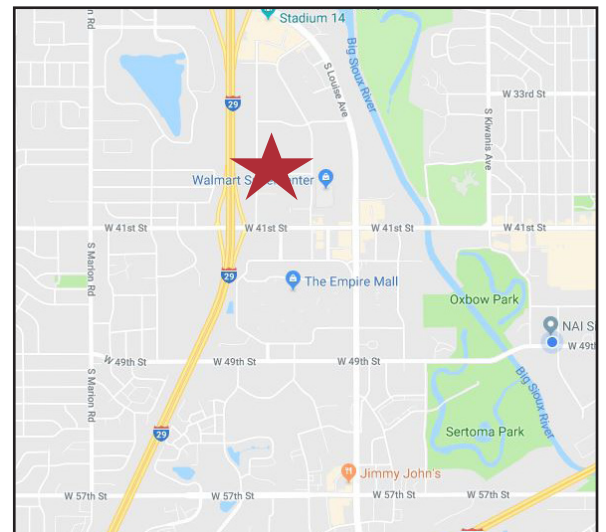

Michael Martin
Broker Associate

+1 605 444-7105 Office
+1 605 261-2777 Cell
mmartin@naisiouxfalls.com

NO WARRANTY OR REPRESENTATION, EXPRESS OR IMPLIED, IS MADE AS TO THE ACCURACY OF THE INFORMATION CONTAINED HEREIN, AND THE SAME IS SUBMITTED SUBJECT TO ERRORS, OMISSIONS, CHANGE OF PRICE, RENTAL OR OTHER CONDITIONS, PRIOR SALE, LEASE OR FINANCING, OR WITHDRAWAL WITHOUT NOTICE, AND OF ANY SPECIAL LISTING CONDITIONS IMPOSED BY OUR PRINCIPALS NO WARRANTIES OR REPRESENTATIONS ARE MADE AS TO THE CONDITION OF THE PROPERTY OR ANY HAZARDS CONTAINED THEREIN ARE ANY TO BE IMPLIED.

2500 W. 49th Street, Suite 100
Sioux Falls, SD 57105
+1 605 357 7100
naisiouxfalls.com

For Sale Commercial Land

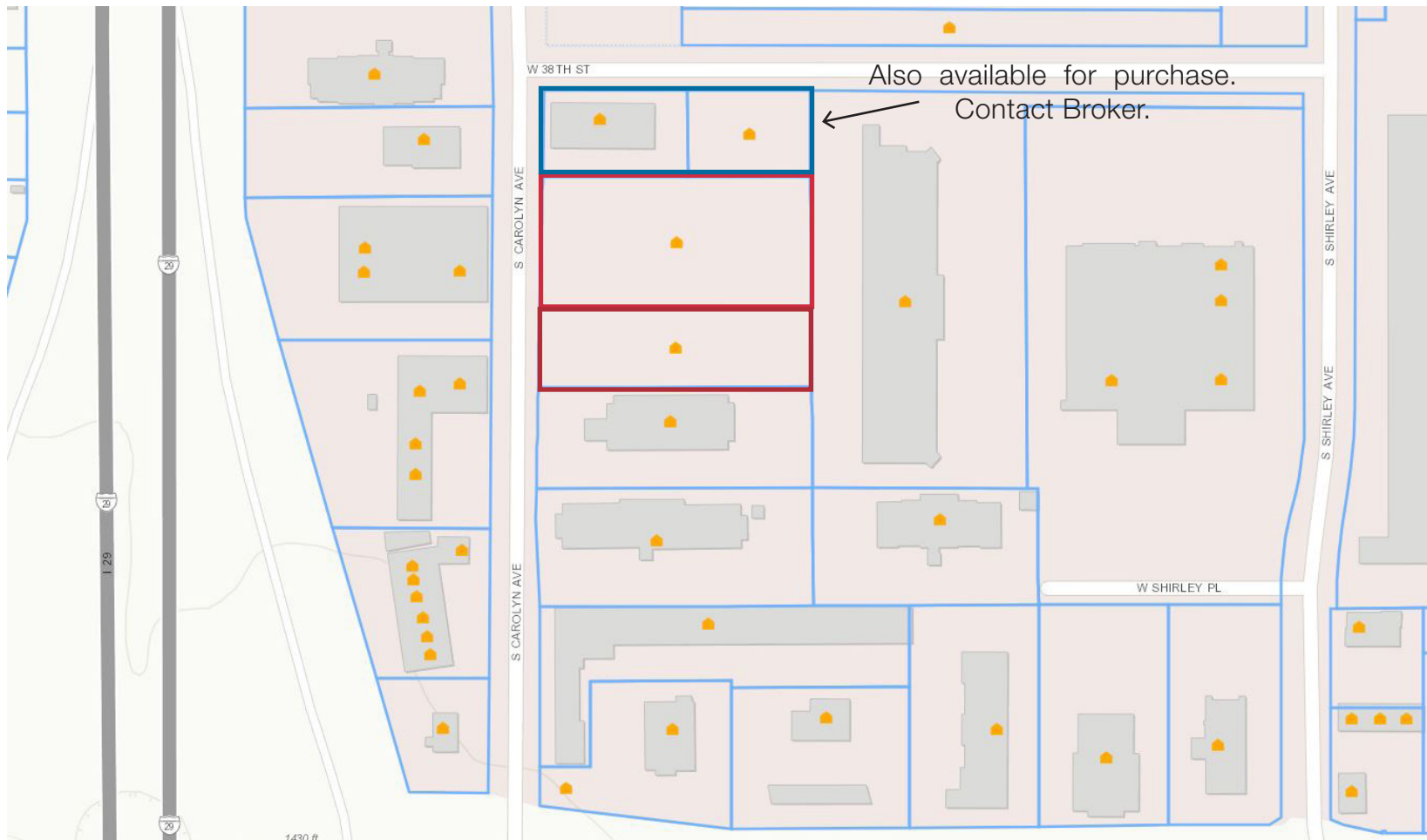

For Sale
Commercial Land



NAISioux Falls

2500 W. 49th Street, Suite 100
Sioux Falls, SD 57105
+1 605 357 7100
naisiouxfalls.com