

SORENSEN RESEARCH PARK 7

FOR LEASE

4246 SOUTH RIVERBOAT ROAD | SALT LAKE CITY, UT



PRIME CENTRAL VALLEY LOCATION

www.cbre.com/saltlakecity

CBRE

PROPERTY OVERVIEW

EASILY ACCESSIBLE CENTRAL VALLEY LOCATION

- Availability:
 - First Floor: 10,689 RSF (available 11/01/2021)
 - Second Floor: 7,677 - 19,866 RSF
 - Fourth Floor: 29,284 RSF
- Lease Rate: \$21 - \$23/RSF, Full Service Gross
- Suites ready for immediate occupancy
- Parking Ratio: 5/1,000 SF
- Close to countless amenities including shopping centers, Meadow Brook Golf Course and Jordan River Parkway
- Excellent access to I-15 and I-215 freeways
- Lockers and showers available for tenants' use



FLOOR PLANS

FIRST FLOOR

SUITE 100 :: 10,689 RSF

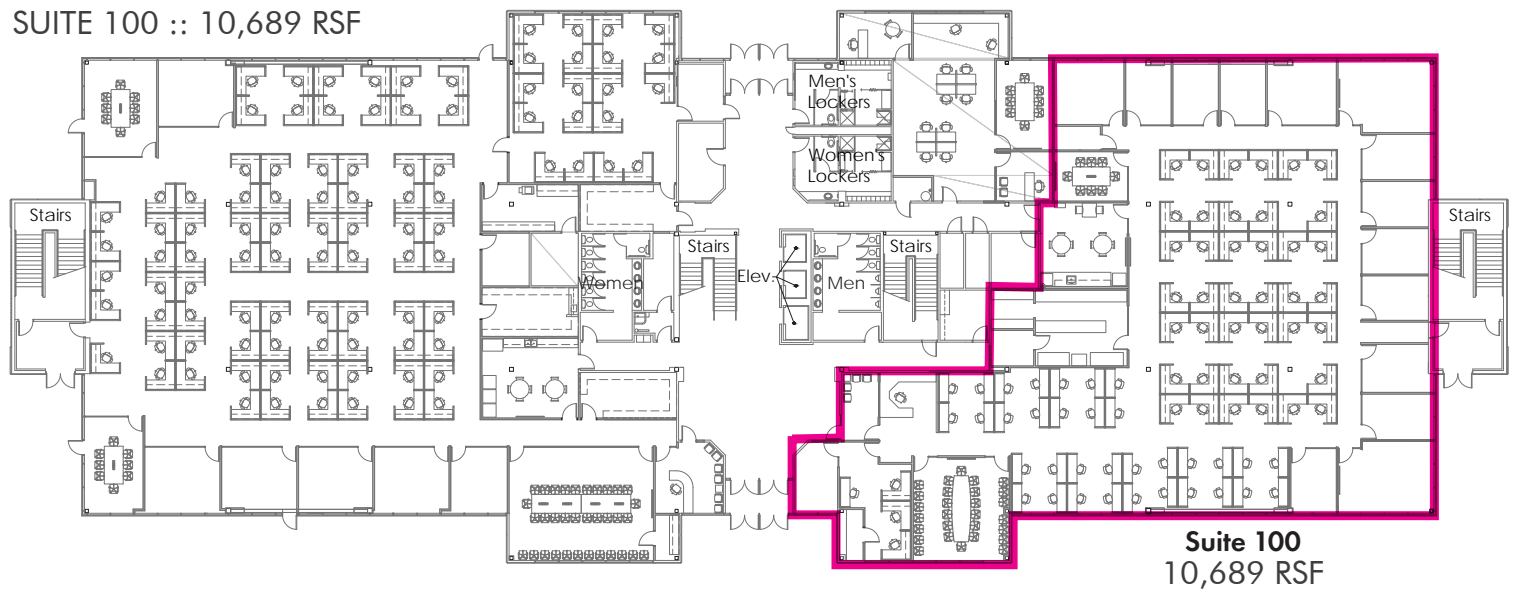

Suite 100
10,689 RSF

SECOND FLOOR

SUITE 210 & 250 :: 7,677 - 19,866 RSF

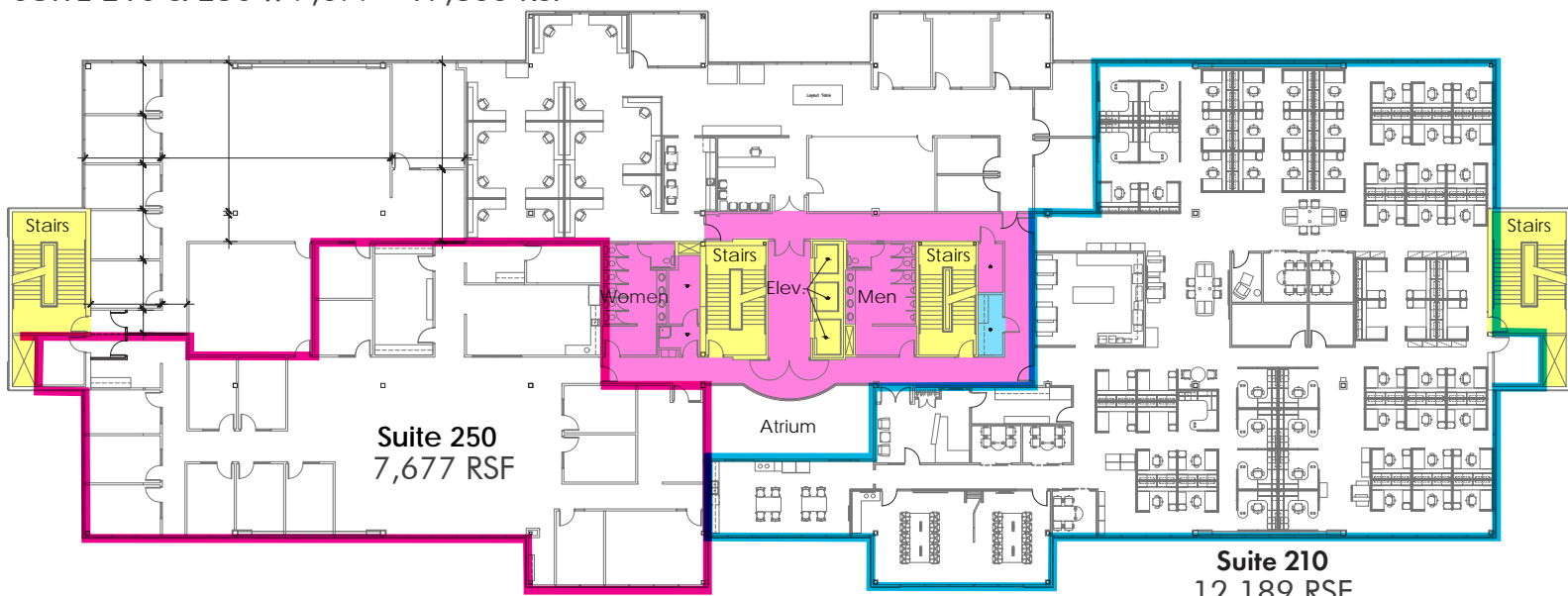

Suite 250
7,677 RSF

Suite 210
12,189 RSF

FOURTH FLOOR

SUITE 400 :: 29,284 RSF



Suite 400

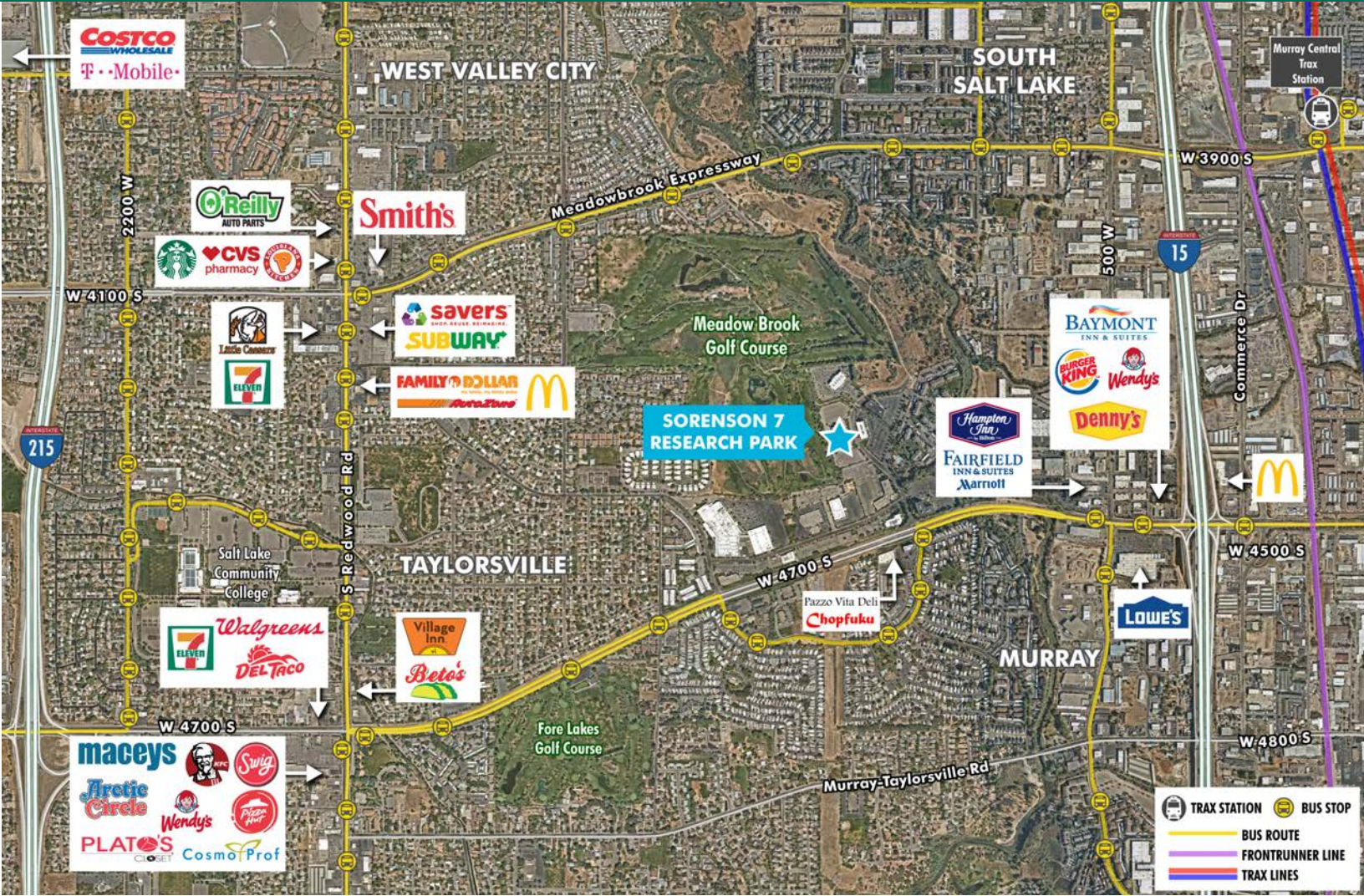

CONTACT INFO

ERIC SMITH
 Senior Vice President
 +1 801 869 8008
 eric.smith@cbre.com

LAURIE ADAIR
 Vice President
 +1 801 869 8009
 laurie.adair@cbre.com

© 2021 CBRE, Inc. All rights reserved. This information has been obtained from sources believed reliable, but has not been verified for accuracy or completeness. You should conduct a careful, independent investigation of the property and verify all information. Any reliance on this information is solely at your own risk. CBRE and the CBRE logo are service marks of CBRE, Inc. All other marks displayed on this document are the property of their respective owners, and the use of such logos does not imply any affiliation with or endorsement of CBRE. Photos herein are the property of their respective owners. Use of these images without the express written consent of the owner is prohibited.

