

# SORRENTO MESA COMMERCE CENTER

6915 FLANDERS DRIVE • 10320 • 10340 CAMINO SANTA FE • SAN DIEGO, CA 92121



***Voit***

REAL ESTATE SERVICES



# SITE PLAN



## PROPERTY FEATURES

- » ±43,583 SF multi-tenant Industrial park
- » High visibility location on the corner of Camino Santa Fe and Flanders Drive
- » Great access to Interstate 805 via Mira Mesa Boulevard
- » Quality technology, life science and industrial tenancy
- » 14' to 16' clearance
- » 200 amps 3-phase power per suite
- » 12'x10' ground level truck doors
- » HVAC offices
- » 3.85/1,000 parking ratio
- » Close proximity to numerous amenities including restaurants and services
- » New motivated ownership

## AVAILABILITY

ADDRESS	SIZE	RENT	COMMENTS
10320 Camino Santa Fe, Suite A	± 1,750 SF	\$1.40 SF NNN	Two (2) offices, restroom. One ground level truck door.



# FLOOR PLAN

## 10320 CAMINO SANTA FE, SUITE A

- » ±1,750 SF industrial space for lease
- » Office space (2)
- » 12'x10' grade level door (1)
- » Restrooms (1)
- » \$1.40 NNN (NNN = \$0.33)
- » Available May 1, 2018

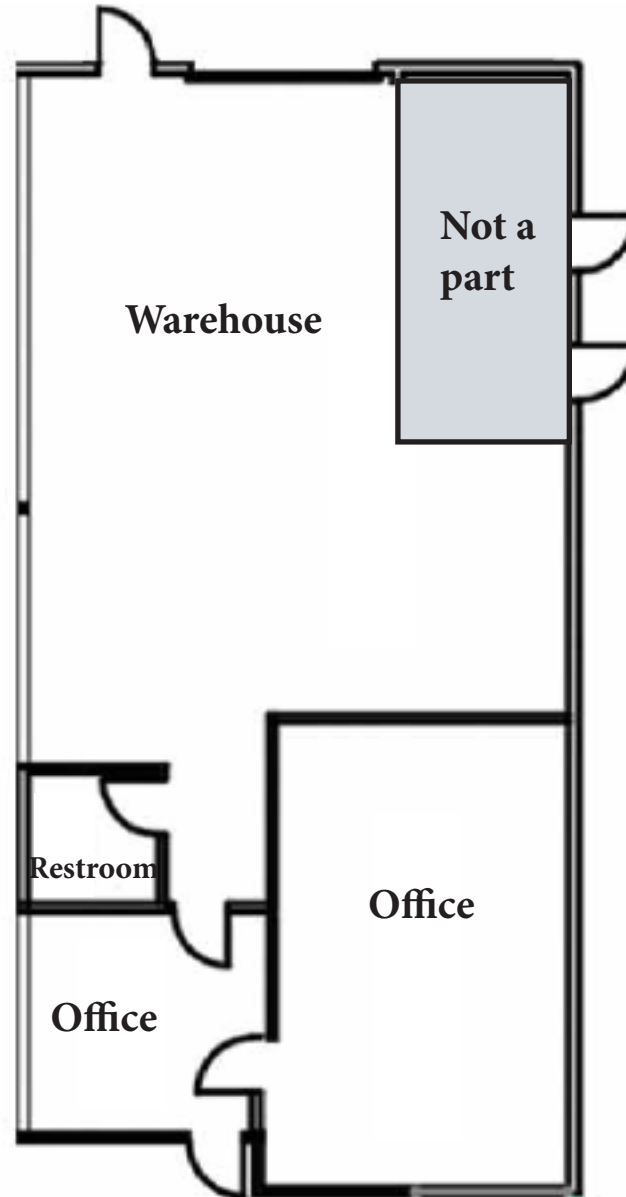



# SORRENTO MESA COMMERCE CENTER

6915 FLANDERS DRIVE • 10320 • 10340 CAMINO SANTA FE • SAN DIEGO, CA 92121

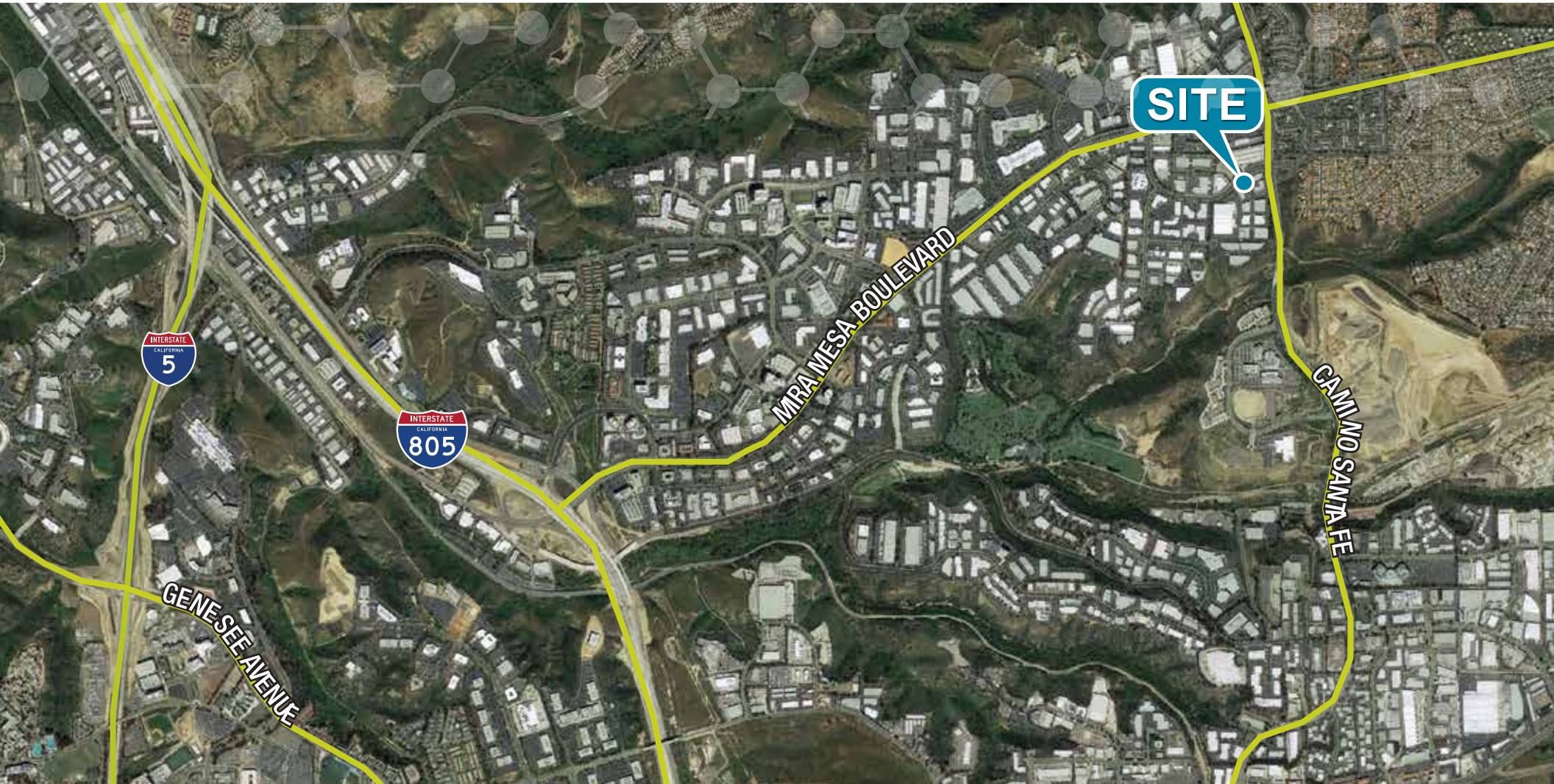

**WESTON YAHN**  
858.458.3321  
wyahn@voitco.com  
Lic. #01975469

**TODD HOLLEY, SIOR**  
858.458.3349  
tholley@voitco.com  
Lic. #01046508

4180 La Jolla Village Drive, Suite 100, La Jolla, CA 92037 • 858.453.0505 • 858.408.3976 Fax • Lic # 01991785 | [www.voitco.com](http://www.voitco.com)

Licensed as a Real Estate Salespersons by the CA Bur of Real Estate. The information contained herein has been obtained from sources we deem reliable. While we have no reason to doubt its accuracy, we do not guarantee it.  
©2018 Voit Real Estate Services, Inc. All Rights Reserved. Real People. Real Solutions.® is a registered trademark of Voit Real Estate Services.

**Voit**  
REAL ESTATE SERVICES