

# OAKRIDGE BUSINESS CENTER

FOR LEASE  
**5,000 SF**

1209 W N CARRIER PKWY, SUITE 302  
GRAND PRAIRIE, TX 75050



## BUILDING SPECIFICATIONS

Address:	1209 W N Carrier Pkwy, Suite 302 Grand Prairie, TX 75050
Suite size:	5,000 SF
Office:	1,943 SF
Warehouse	3,057 SF
Clear Height	16'
Truck Loading:	1 Dock high, 1 ramp
Comments:	Oakridge Business Center offers excellent, high visibility, front park/rear load, office/flex space located on Carrier Pkwy in the Great Southwest Industrial Park. Space sizes range from 3,000-100,000 SF in a four building project totaling 328,243 SF providing dock high and ramped loading door configurations

FOR MORE INFORMATION,  
PLEASE CONTACT:

Mark Graybill, SIOR, CCIM  
Principal  
O: 972.934.4000  
C: 214.914.5537  
[mgraybill@lee-associates.com](mailto:mgraybill@lee-associates.com)

Colton Rhodes  
Associate  
O: 972.934.4017  
C: 325.660.2636  
[crhodes@lee-associates.com](mailto:crhodes@lee-associates.com)



LEASED BY:



# For Lease

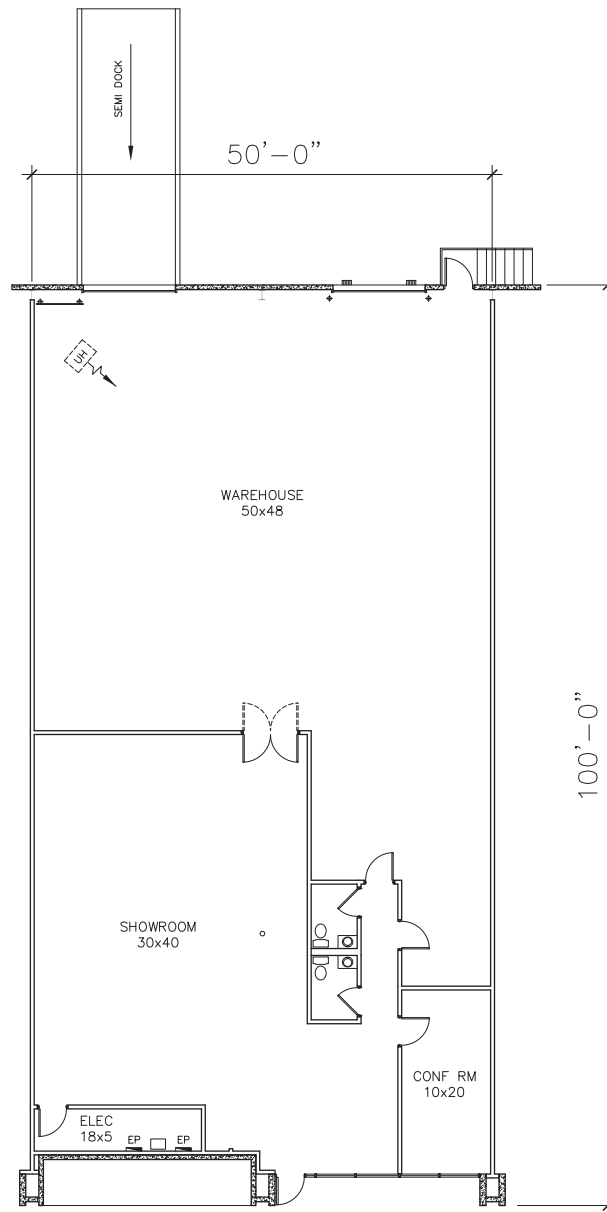

FOR MORE INFORMATION,  
PLEASE CONTACT:

Mark Graybill, SIOR, CCIM  
Principal  
O: 972.934.4000  
C: 214.914.5537  
mgraybill@lee-associates.com

Colton Rhodes  
Associate  
O: 972.934.4017  
C: 325.660.2636  
crhodes@lee-associates.com

