

Bridgeview Business Park

4 Stewart Court, Denville, NJ



FOR LEASE

PROPERTY SPECS:

- Total Size:** 13,750 SF
- Office space – 7,450 SF
 - Assembly space – 2,700 SF
 - Warehouse space – 3,600 SF
- Asking Price:** \$13.95 PSF NNN
- Taxes:** \$3.08 PSF
- Land Area:** 2.26 acres
- Parking:** 46 cars (3.3/1,000 SF ratio)
- Ceiling Height:** 14' Clear
- Loading:** 2 Tailboards
- Year Built:** 1983
- Power:** 400 Amps/480V/3 phase
- Sewer:** Municipal



For more information, please contact:

Brian Wilson
bwilson@resource-realty.com

Scott Peck, SIOR
speck@resource-realty.com

973-299-0900

Exclusive Leasing Agent:



Resource Realty
Corporate Real Estate Services

www.resource-realty.com

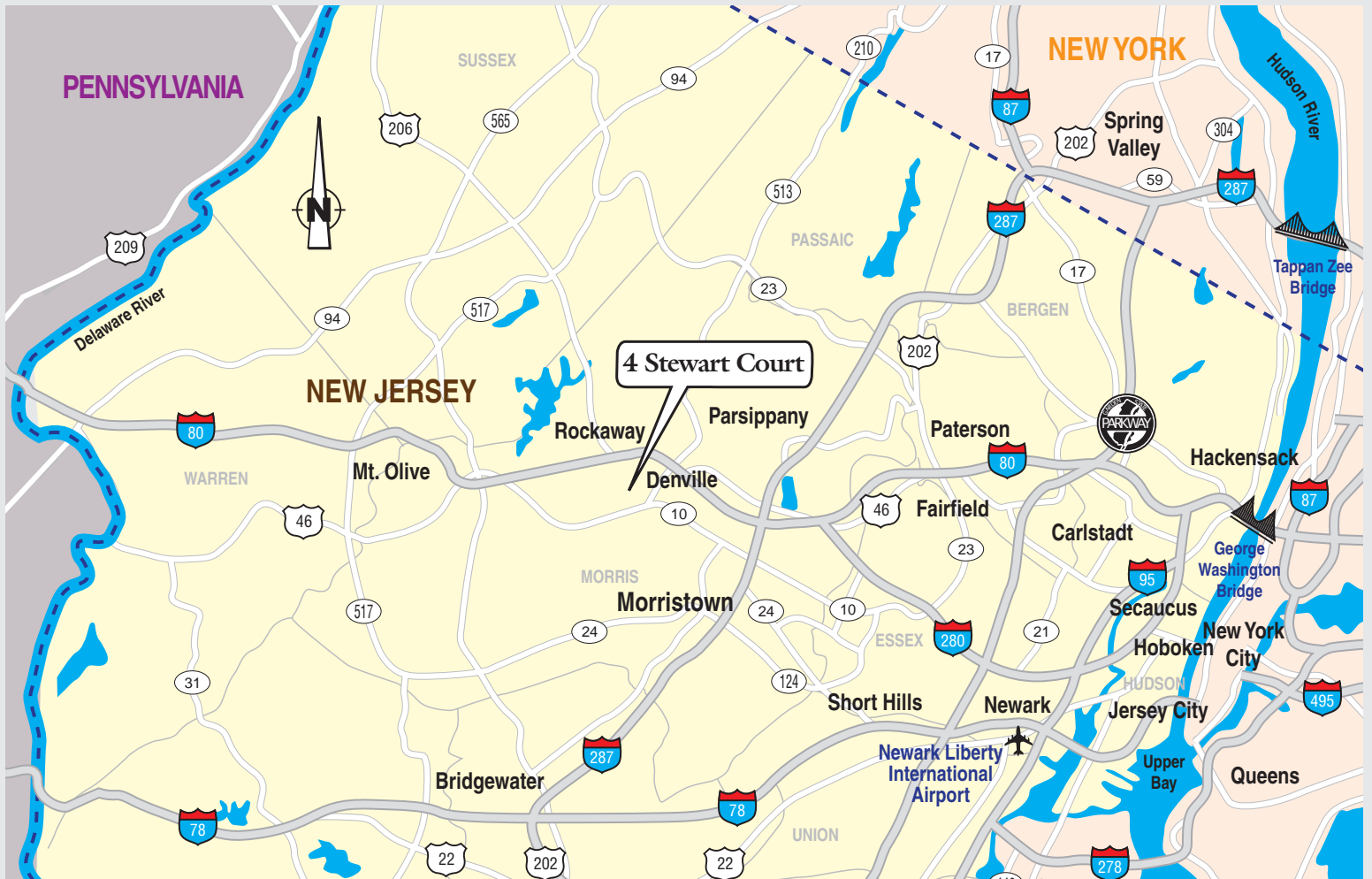
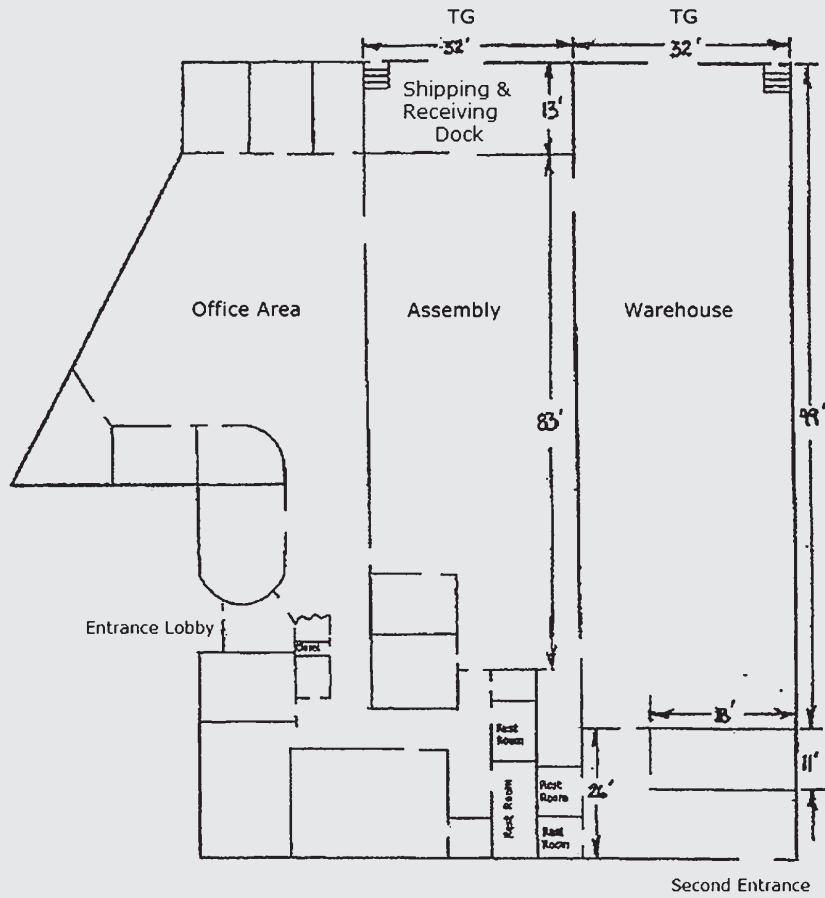

All information furnished is from sources deemed reliable. No representation is made as to the accuracy thereof and it is submitted subject to error, omission, change of price, prior sale or lease and withdrawal without notice. Any commission due cooperating brokers is subject to all of the terms and conditions upon which we and our clients have agreed.