

MILL CREEK DISTRIBUTION CENTER

21840 76th Avenue S, Kent



For Lease



42,000 SF total; 2,906 SF office

33 dock-high doors and 2 grade-level doors

21'-22' clear height

Lease rates: \$0.43/SF shell, NNN; \$0.75/SF office, NNN

M-3 heavy industrial zoning

Trailer positions are available

Available November 1, 2015

Contact

Doug Klein, SIOR
Senior Vice President, Partner
206.248.7348
dklein@kiddermathews.com

Kraig Heeter
Vice President
206.248.7313
kheeter@kiddermathews.com

kiddermathews.com

Owned by

IndCor Properties

This information supplied herein is from sources we deem reliable. It is provided without any representation, warranty or guarantee, expressed or implied as to its accuracy. Prospective Buyer or Tenant should conduct an independent investigation and verification of all matters deemed to be material, including, but not limited to, statements of income and expenses. Consult your attorney, accountant, or other professional advisor.

km Kidder Mathews

Mill Creek Distribution Center

Site Plan

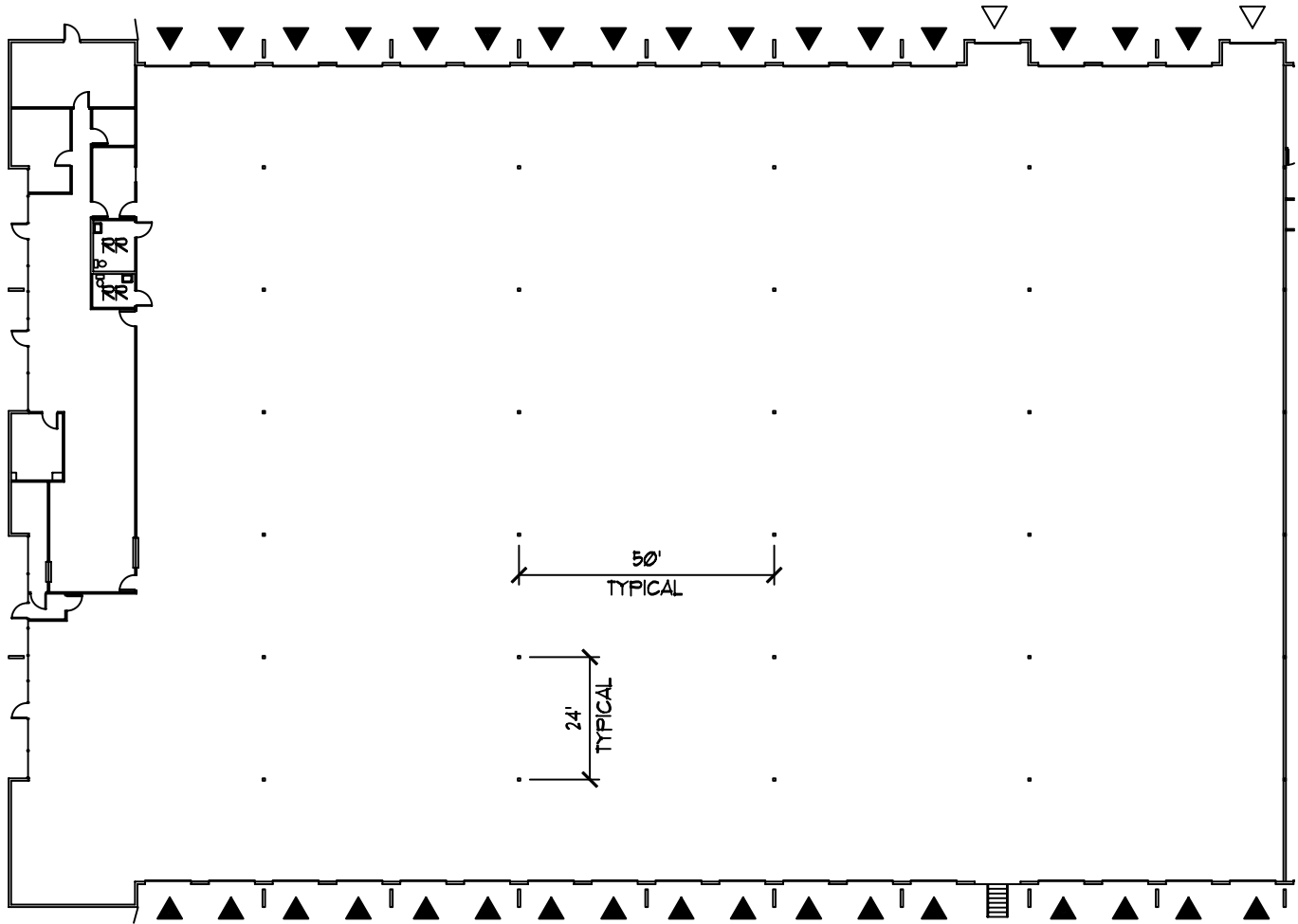

MILL CREEK DISTRIBUTION CENTER III
21840 16th AVENUE SOUTH
KENT, WASHINGTON



Contact

Doug Klein, SIOR
Senior Vice President, Partner
206.248.7348
dklein@kiddermathews.com

Kraig Heeter
Vice President
206.248.7313
kheeter@kiddermathews.com

kiddermathews.com

Owned by

IndCor Properties

This information supplied herein is from sources we deem reliable. It is provided without any representation, warranty or guarantee, expressed or implied as to its accuracy. Prospective Buyer or Tenant should conduct an independent investigation and verification of all matters deemed to be material, including, but not limited to, statements of income and expenses. Consult your attorney, accountant, or other professional advisor.

km Kidder Mathews

Mill Creek Distribution Center

Floor Plan

Mill Creek Distribution Center

A 226,000 SF industrial park developed in 1989 and 1990 and features tremendous access to I-5 and SR-167 via 76th Avenue S and S 212th Street. The park is designed with tenants who require extensive use of dock doors for their operation and is unique as a result of the availability of trailer parking for most spaces. The park is professionally managed and leased by Kidder Mathews.

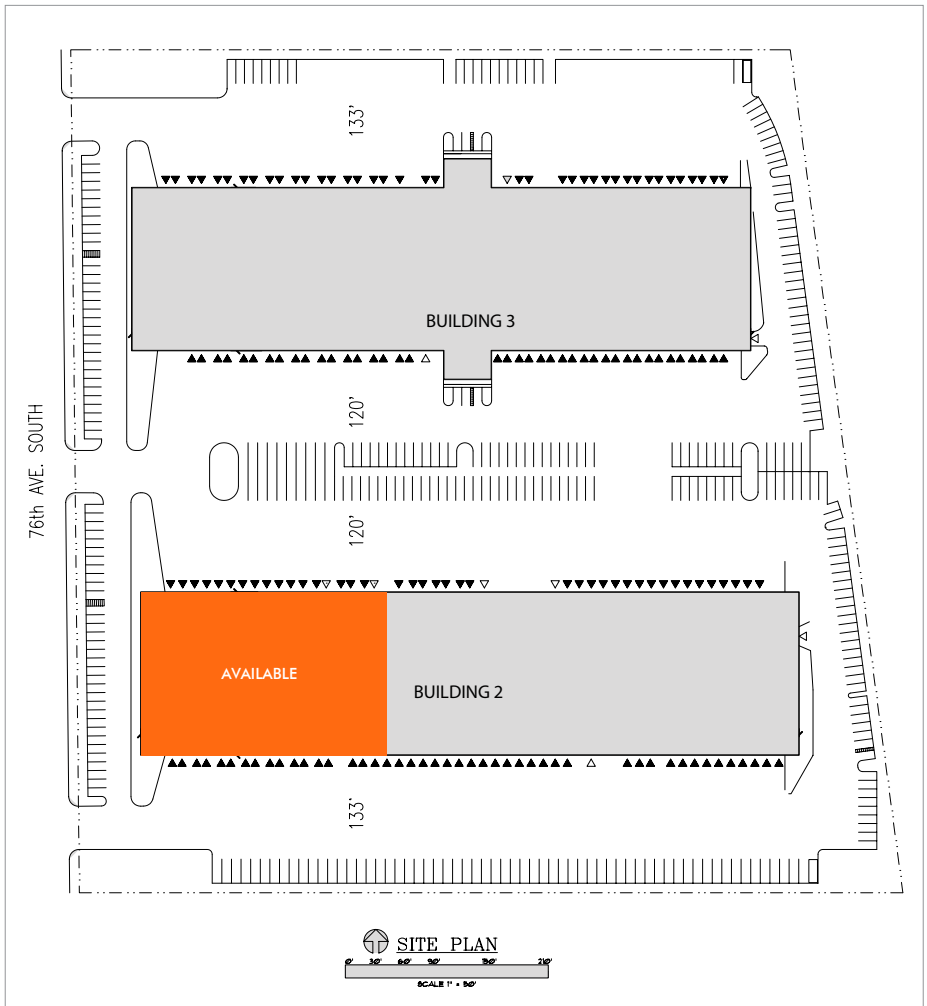

Contact

Doug Klein, SIOR

Senior Vice President, Partner

206.248.7348

dklein@kiddermathews.com

Kraig Heeter

Vice President

206.248.7313

kheeter@kiddermathews.com



kiddermathews.com

Owned by

IndCor Properties

This information supplied herein is from sources we deem reliable. It is provided without any representation, warranty or guarantee, expressed or implied as to its accuracy. Prospective Buyer or Tenant should conduct an independent investigation and verification of all matters deemed to be material, including, but not limited to, statements of income and expenses. Consult your attorney, accountant, or other professional advisor.

km Kidder Mathews