

International Center

6121 Westwood Blvd, Orlando, FL 32821



EQUITY
INVESTMENT
SERVICES

PROPERTY SUMMARY



PROPERTY HIGHLIGHTS

- Endcap Drive-Thru Coming Soon
- 1,440 SF up to 10,130 SF Available
- The entire exterior of the property was recently renovated
- Frontage on both International Drive & Westwood Blvd
- Positioned nearby huge traffic generators such as Sea World, Orange County Convention Center, and "I-Drive"
- Located just off SR 528 at a signalized intersection with 3 ingress/egress points including a left-in turn
- The intersection see over 30,000 vehicles per day and 90,000 vehicles per day on SR 528

OFFERING SUMMARY

Lease Rate:	Negotiable
Available SF:	1,440 - 10,130 SF
Lot Size:	7.29 Acres
Building Size:	45,596 SF

DEMOGRAPHICS	1 MILE	3 MILES	5 MILES
Total Households	1,600	10,150	41,724
Total Population	3,500	26,457	117,945
Average HH Income	\$48,149	\$80,854	\$78,521

Nick Barbato
407.573.0711 x309
nbarbato@eisre.com

Eric Portnoy
407.573.0711 x310
eportnoy@eisre.com



7575 Dr. Phillips Blvd, Ste 390
Orlando, FL 32819
www.eisre.com

International Center

6121 Westwood Blvd, Orlando, FL 32821



EQUITY
INVESTMENT
SERVICES

PROPERTY PHOTOS



Nick Barbato
407.573.0711 x309
nbarbato@eisre.com

Eric Portnoy
407.573.0711 x310
eportnoy@eisre.com



7575 Dr. Phillips Blvd, Ste 390
Orlando, FL 32819
www.eisre.com

International Center

6121 Westwood Blvd, Orlando, FL 32821



EQUITY
INVESTMENT
SERVICES

SPACES AVAILABLE



**Not to scale*
WESTWOOD BOULEVARD

LEGEND

Available

Nick Barbato
407.573.0711 x309
nbarbato@eisre.com

Eric Portnoy
407.573.0711 x310
eportnoy@eisre.com



7575 Dr. Phillips Blvd, Ste 390
Orlando, FL 32819
www.eisre.com

International Center

6121 Westwood Blvd, Orlando, FL 32821



EQUITY
INVESTMENT
SERVICES

SPACES AVAILABLE

LEASE INFORMATION

Lease Type:	NNN
Total Space:	1,440 - 10,130 SF

Lease Term:	Negotiable
Lease Rate:	Negotiable

AVAILABLE SPACES

SUITE	TENANT	SIZE	TYPE	RATE	DESCRIPTION
6177	Available	3,000 - 10,130 SF	NNN	Negotiable	-
6165	Available	3,630 - 10,130 SF	NNN	Negotiable	-
6145	Available	1,440 SF	NNN	Negotiable	Under Lease
6141	Available	1,500 SF	NNN	Negotiable	-
6131	Available	5,478 SF	NNN	Negotiable	-
6125	Available	2,800 SF	NNN	Negotiable	-

Nick Barbato
407.573.0711 x309
nbarbato@eisre.com

Eric Portnoy
407.573.0711 x310
eportnoy@eisre.com



7575 Dr. Phillips Blvd, Ste 390
Orlando, FL 32819
www.eisre.com

International Center

6121 Westwood Blvd, Orlando, FL 32821



EQUITY
INVESTMENT
SERVICES

DRIVE THRU SITE PLAN

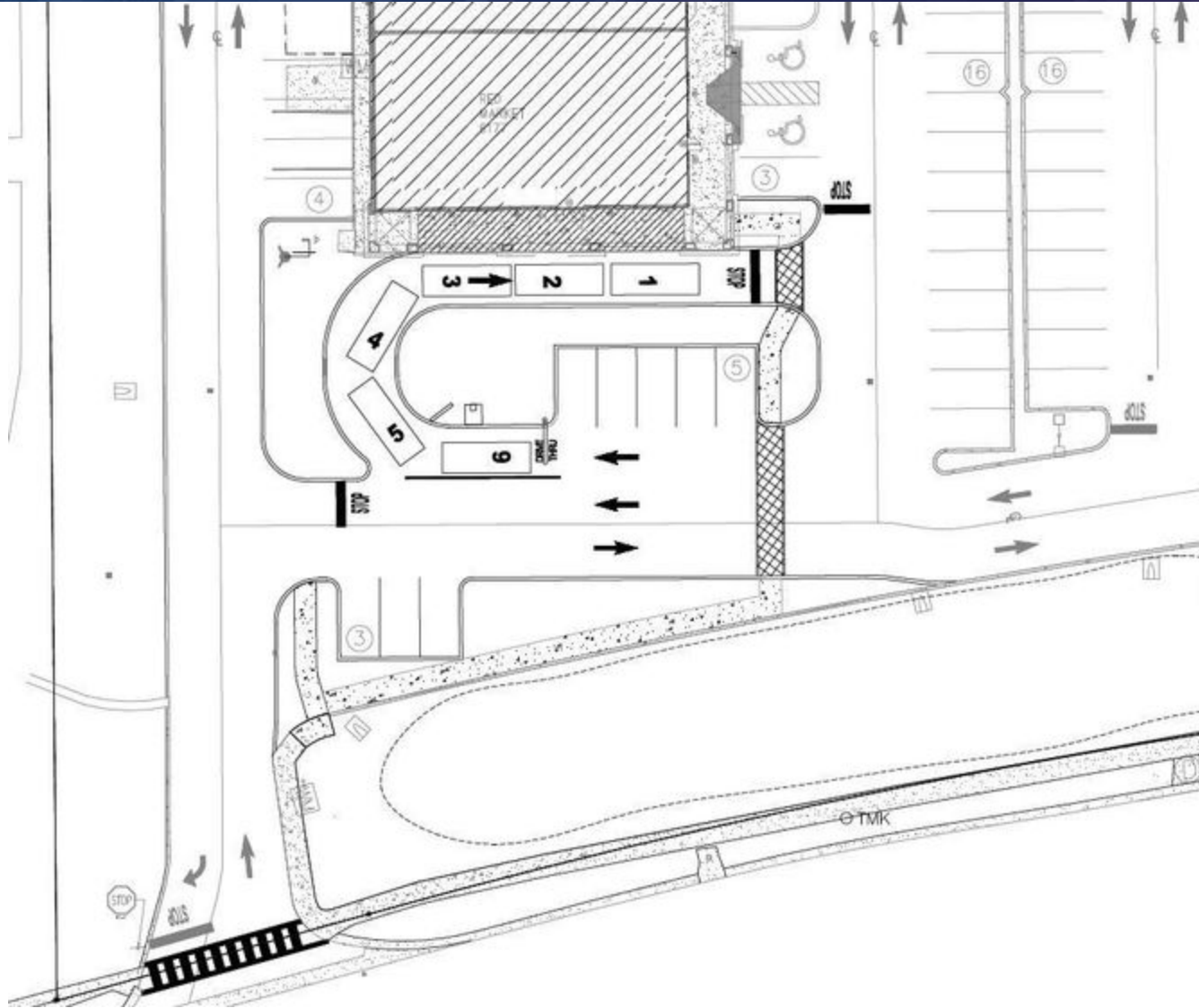

Nick Barbato
407.573.0711 x309
nbarbato@eisre.com

Eric Portnoy
407.573.0711 x310
eportnoy@eisre.com



7575 Dr. Phillips Blvd, Ste 390
Orlando, FL 32819
www.eisre.com

International Center

6121 Westwood Blvd, Orlando, FL 32821



EQUITY
INVESTMENT
SERVICES

SITE PLAN

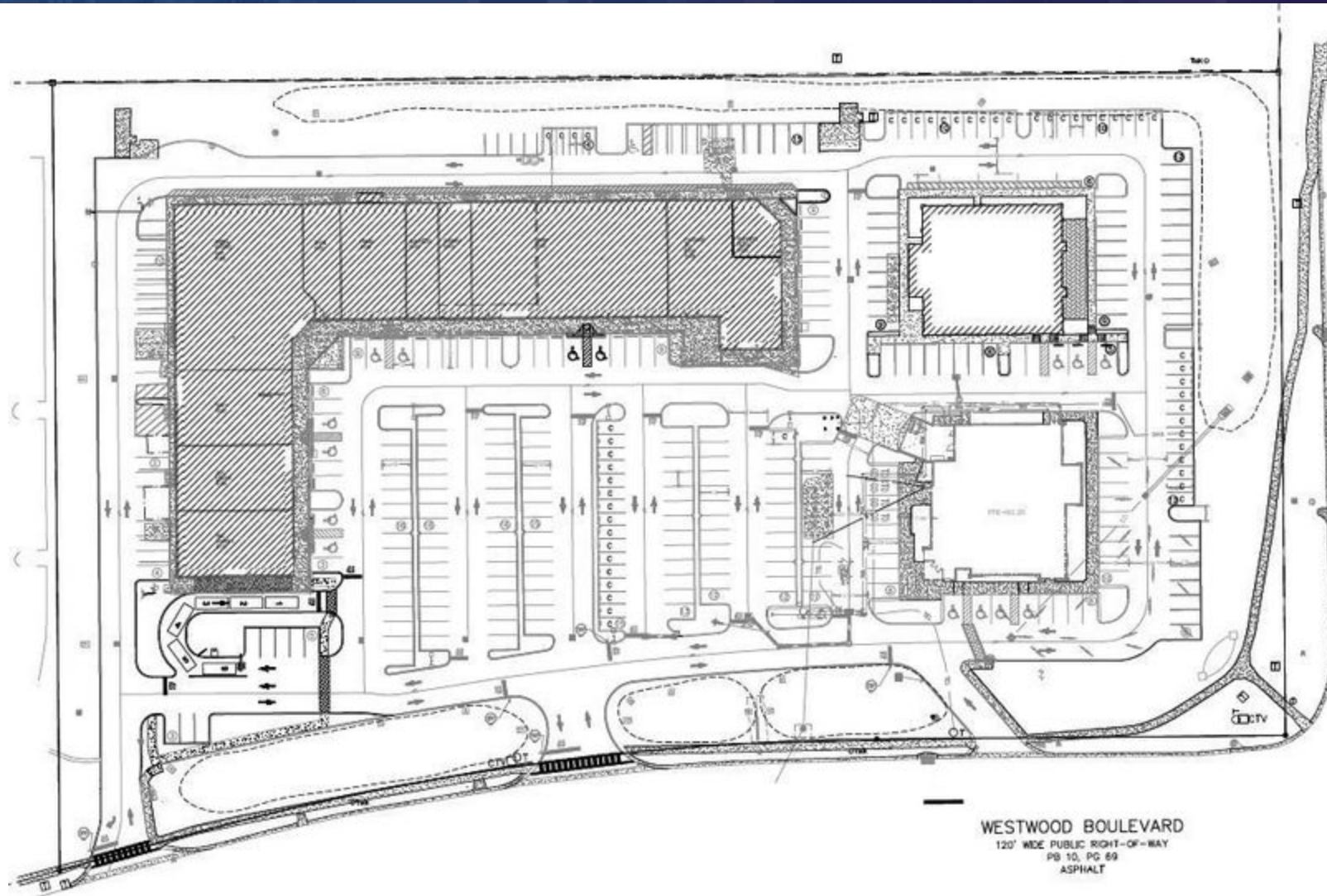

Nick Barbato
407.573.0711 x309
nbarbato@eisre.com

Eric Portnoy
407.573.0711 x310
eportnoy@eisre.com



7575 Dr. Phillips Blvd, Ste 390
Orlando, FL 32819
www.eisre.com

International Center

6121 Westwood Blvd, Orlando, FL 32821



EQUITY
INVESTMENT
SERVICES

AREA MAP



Map data ©2020 Google Imagery ©2020, CNES / Airbus, Lake County, Landsat / Copernicus, Maxar Technologies, U.S. Geological Survey

Nick Barbato
407.573.0711 x309
nbarbato@eisre.com

Eric Portnoy
407.573.0711 x310
eportnoy@eisre.com



7575 Dr. Phillips Blvd, Ste 390
Orlando, FL 32819
www.eisre.com

International Center

6121 Westwood Blvd, Orlando, FL 32821



EQUITY
INVESTMENT
SERVICES

DEMOGRAPHICS MAP & REPORT

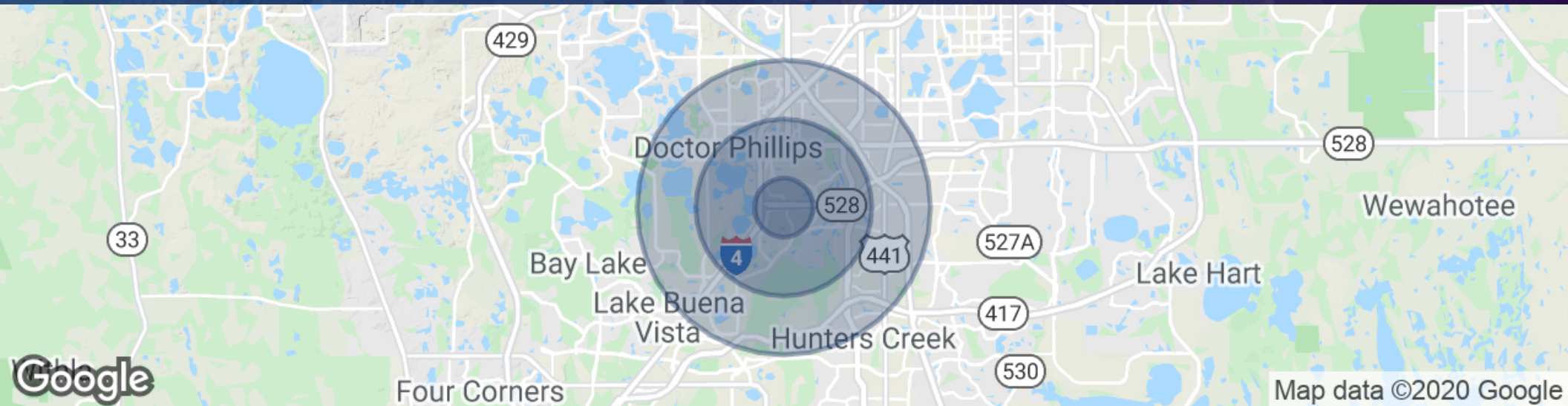

POPULATION	1 MILE	3 MILES	5 MILES
Total Population	3,500	26,457	117,945
Average age	36.2	36.3	35.3
Average age (Male)	35.9	35.7	35.1
Average age (Female)	39.0	37.8	36.0
HOUSEHOLDS & INCOME	1 MILE	3 MILES	5 MILES
Total households	1,600	10,150	41,724
# of persons per HH	2.2	2.6	2.8
Average HH income	\$48,149	\$80,854	\$78,521
Average house value	\$646,330	\$489,126	\$431,445

Nick Barbato

407.573.0711 x309
nbarbato@eisre.com

Eric Portnoy

407.573.0711 x310
eportnoy@eisre.com



7575 Dr. Phillips Blvd, Ste 390
Orlando, FL 32819
www.eisre.com