

420 Lexington Avenue

Grand Central Retail



Midtown, New York

Conquer The Crowds

Grand Central Market

European-style gourmet shopping experience, features 13 local vendors



Grand Central Terminal Entrance

750 K
People Pass Through Daily

2ND
Busiest Subway Station In New York City

9TH
Most Visited Attraction Worldwide

Graybar Building Entrance

7.5 K
Built-in Office Tenants

EQUINOX
Highest Grossing Location

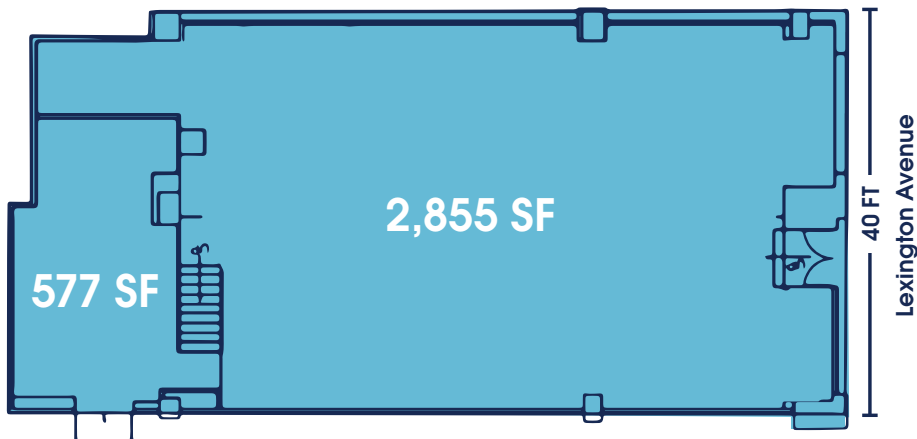

Mezzanine can be made available for storage 23-FT ceilings

420
Lexington
Avenue

Surrounded by
40 M SF
 of office space,
 comprised of
160 K
 employees

Steps from Grand Central
 Station servicing the
S4567 trains with
46 M+
 riders annually,
 along with
630 K
 weekly commuters on



**Exclusive
 Leasing
 Agents**

Mitchell N. Friedel | 212.372.0719
 mfriedel@ngkf.com

Adam Weinblatt | 212.372.2103
 aweinblatt@ngkf.com



The information contained herein has been obtained from sources deemed reliable but has not been verified and no guarantee, warranty or representation, either express or implied, is made with respect to such information. Terms of sale or lease and availability are subject to change or withdrawal without notice. 125 Park Avenue, New York, NY 10017.



COMING SOON