

MUD BAY OPENING SOON!

MUD BAY TO JOIN TRADER JOE'S, JOANN FABRIC AND CRAFT, OFFICE DEPOT, AND ORANGE THEORY FITNESS AT THIS WELL LOCATED SHOPPING CENTER IN LYNNWOOD! (SEE SITE PLAN FOR RETAIL OPPORTUNITIES)



TRADER JOE'S



LYNNWOOD CENTER

19701 HIGHWAY 99 | LYNNWOOD, WA 98036

JOHN CHELICO
206.859.4500
johnc@jshproperties.com

AARON BENNETT
206.859.4500
aaronb@jshproperties.com

 JSH | PROPERTIES, INC.
206.859.4500 | [WWW.JSHPROPERTIES.COM](http://www.jshproperties.com)

THE INFORMATION CONTAINED HEREIN HAS BEEN GIVEN TO US BY SOURCES WE DEEM RELIABLE, WE HAVE NO REASON TO DOUBT ITS ACCURACY, BUT WE DO NOT GUARANTEE IT. ALL INFORMATION SHOULD BE VERIFIED PRIOR TO PURCHASE OR LEASE.

LYNNWOOD CENTER SITE MAP

5824	Joann Fabric	42,583
709-A	Rent-A-Center	3,900
709-DEF	Mud Bay Pet Supply	5,544
709-K	Dollar Tree	9,957
19705-B	Trader Joe's	12,425
19705-A	Available	30,085
19705-B	Available	11,395
723-I	Orangetheory Fitness	3,549
09	Office Depot	21,636
723-A	Gentle Dental	3,682
723-B	Available	1,700
723-C	Available	1,605
723-D	Kung Fu Tea	1,030
723-E	H&R Block	1,320
723-F	Puget Sound Blood Center	4,824
723-G	Available	2,185
723-H	Available	2,271

 AVAILABLE 

2019 DEMOGRAPHICS

	1 MILE	3 MILE	5 MILE
Population	18,317	127,490	291,827
Daytime Population	22,832	117,770	229,020
Households	7,393	50,910	113,446
Avg. Household Income	\$75,275	\$103,010	\$111,757

 **MUD BAY**
OPENING SOON!

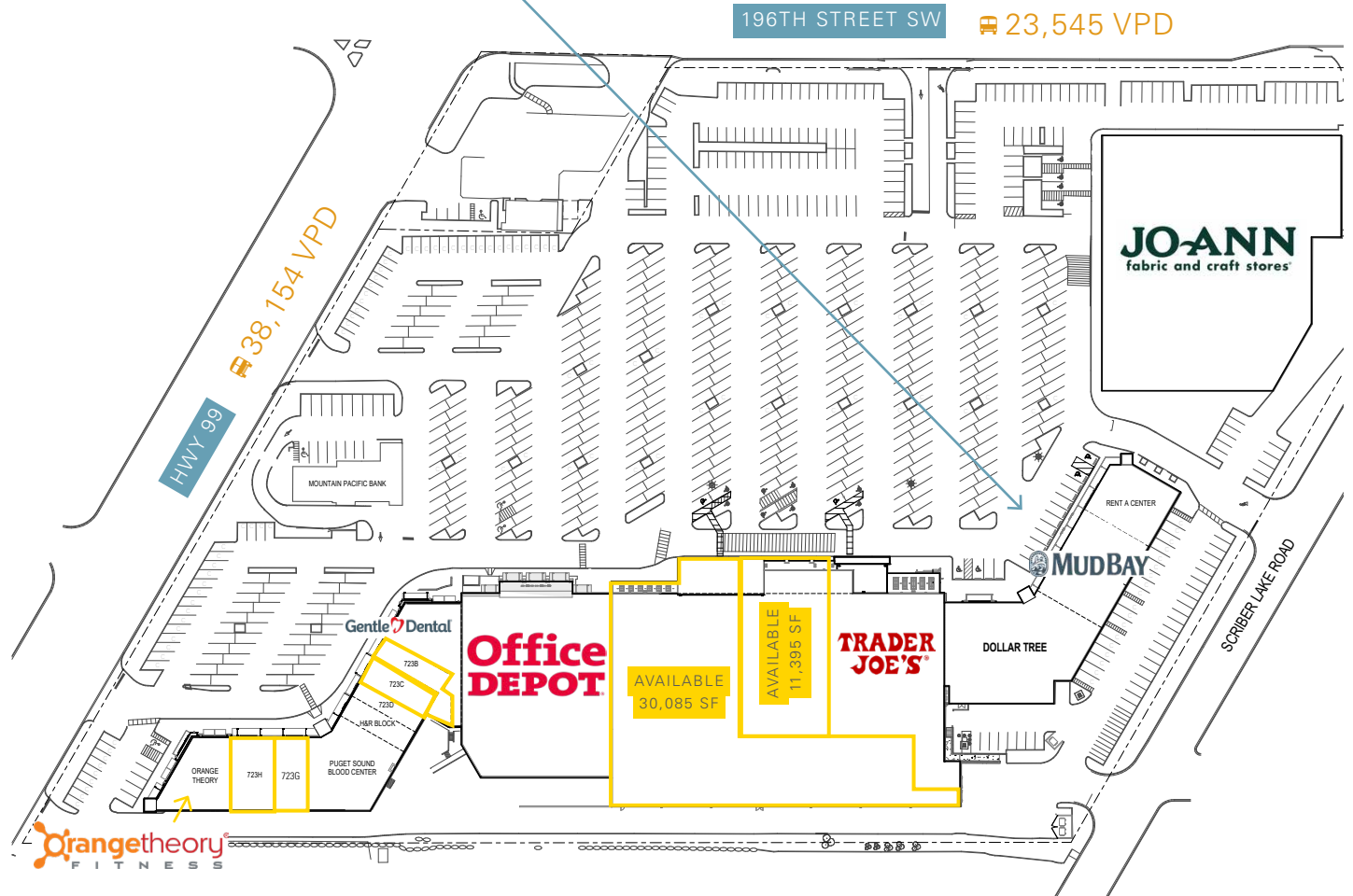

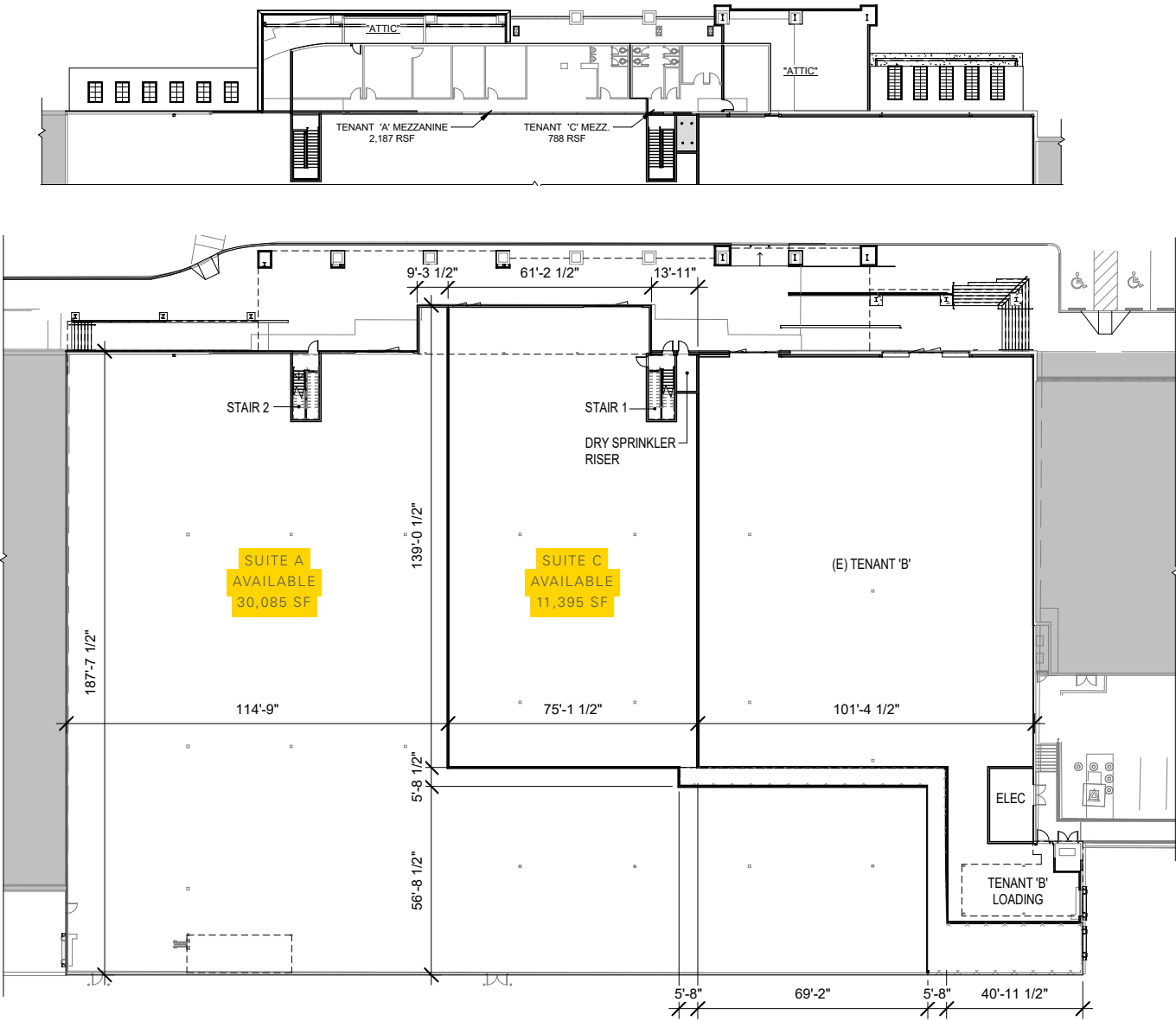



Great visibility at intersection of 196th Street SW and Highway 99!
 Traffic counts over 38,000 cars per day on Hwy 99 and over 23,500 cars on 196th Street SW