

# FOR LEASE

## 67,848 SF INDUSTRIAL SPACE



Warehouse Solutions  
for Last-Mile Logistics

13875 Corporate Woods Trail | Earth City, MO 63045



### Property Summary

<b>Location</b>	Great visibility from Earth City Expressway.	<b>Loading</b>	Rear loading
<b>Total Building</b> <b>Available Space</b> Office Area	213,898 SF <b>67,848 SF</b> 1,297 SF	<b>Clear height</b>	30'
<b>Auto Parking</b>	200 spaces	<b>Sprinkler</b>	ESFR system
<b>Truck docks</b>	9 Dock Doors 1 oversized drive-in door	<b>Column Spacing</b>	40' X 40'

**LEASE RATE: \$4.25/SF, NNN**



**Katie Haywood**  
First Vice President  
314-655-5838  
katie.haywood@cbre.com

**Will Mura**  
Senior Associate  
314-655-5826  
will.mura@cbre.com

**Scott Cordes**  
Vice President  
972-823-2813  
scordes@clny.com



[www.clny.com/industrial](http://www.clny.com/industrial)

13875 Corporate Woods Trail | Earth City, MO 63045

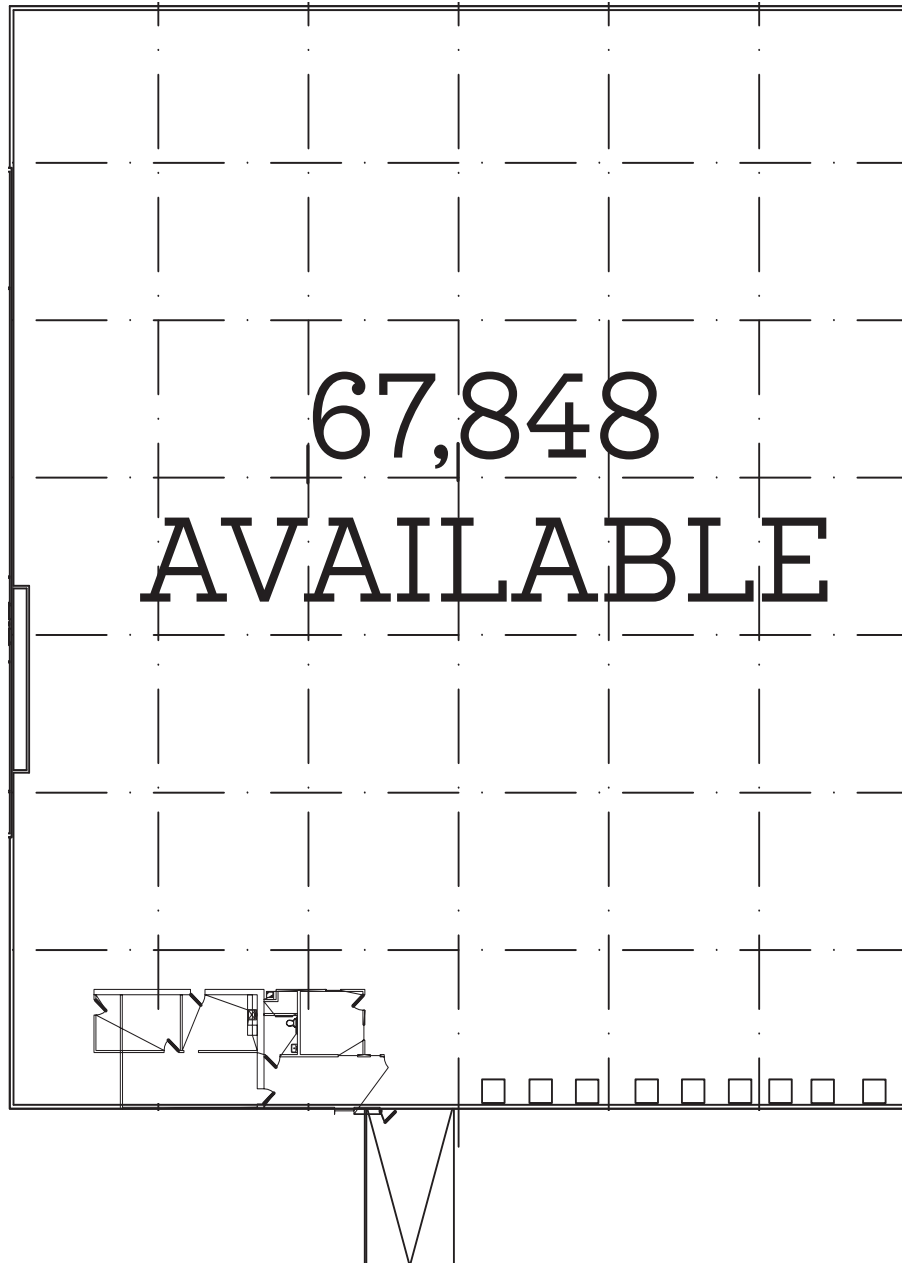

**CBRE**

**Katie Haywood**  
First Vice President  
314-655-6052  
katie.haywood@cbre.com

**Will Mura**  
Senior Associate  
314-655-5826  
will.mura@cbre.com

**Scott Cordes**  
Vice President  
972-823-2813  
scordes@clny.com

13875 Corporate Woods Trail | Earth City, MO 63045

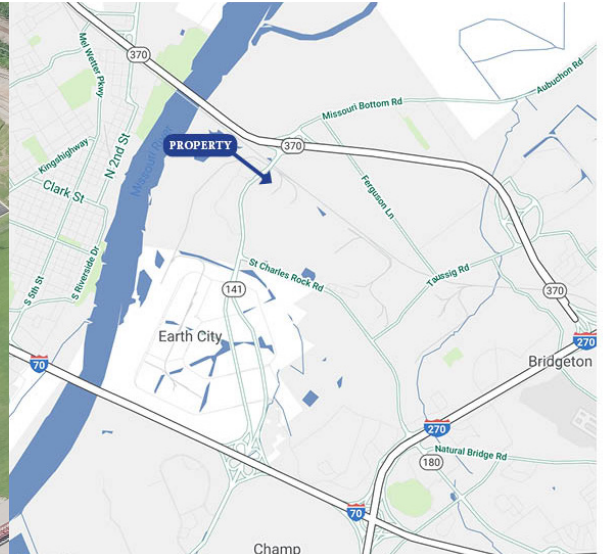
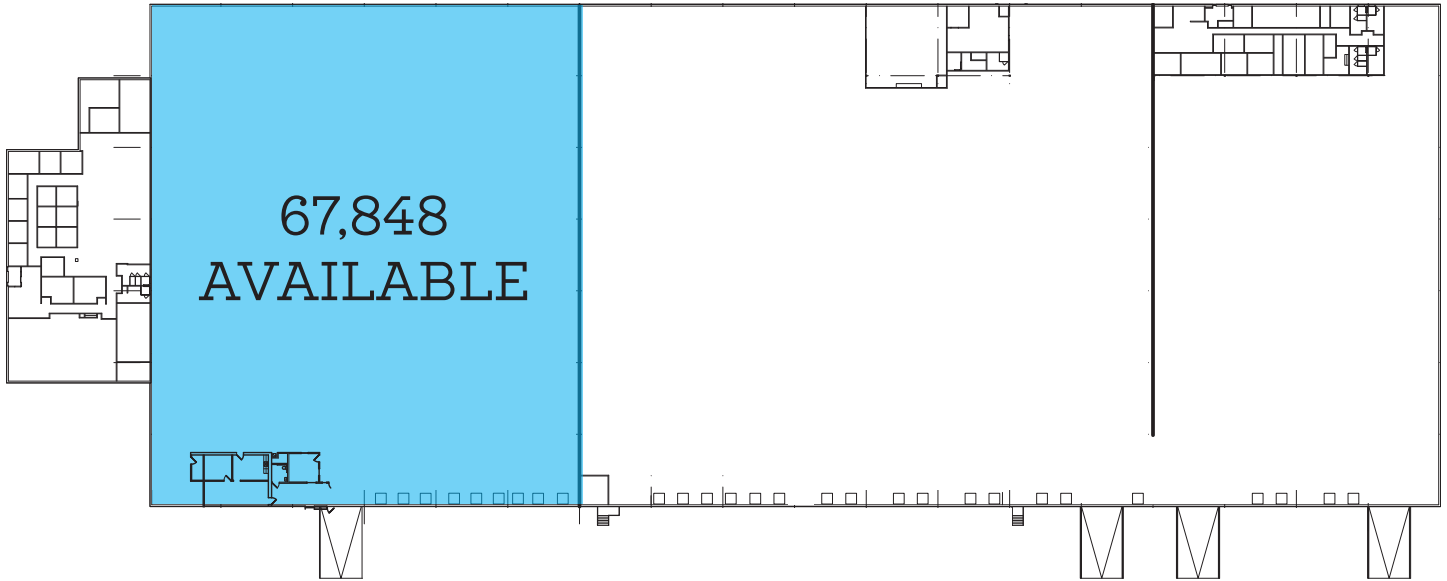

# CBRE

**Katie Haywood**  
First Vice President  
314-655-6052  
katie.haywood@cbre.com

**Will Mura**  
Senior Associate  
314-655-5826  
will.mura@cbre.com

**Scott Cordes**  
Vice President  
972-823-2813  
scordes@clny.com

13875 Corporate Woods Trail | Earth City, MO 63045

**95.5%**  
Stabilized Leased\*

**48.9M**  
Square Feet

**406**  
Buildings

**984**  
Tenants

**20**  
Major Markets

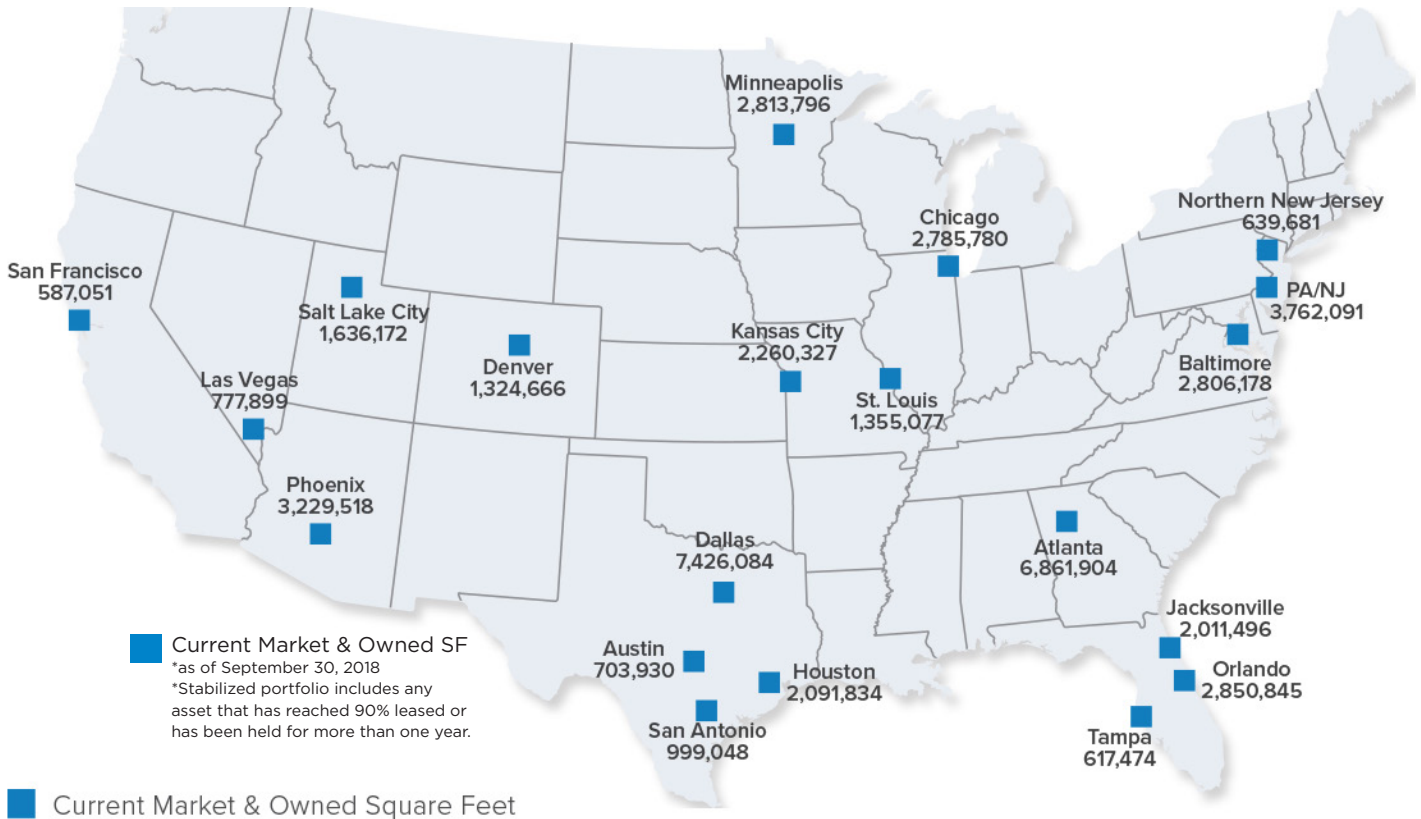

© 2018 CBRE, Inc. All rights reserved. This information has been obtained from sources believed reliable, but has not been verified for accuracy or completeness. You should conduct a careful, independent investigation of the property and verify all information. Any reliance on this information is solely at your own risk.

**CBRE**

**Katie Haywood**  
First Vice President  
314-655-6052  
katie.haywood@cbre.com

**Will Mura**  
Senior Associate  
314-655-5826  
will.mura@cbre.com

**Scott Cordes**  
Vice President  
972-823-2813  
scordes@clny.com