



## Industrial for Lease

**Property Name:**

**Location:** 28025 Oakland Oaks Court

**City, State:** Wixom, MI

**Cross Streets:** Grand River Ave.

**County:** Oakland

**Zoning:** IRO

### BUILDING SIZE / AVAILABILITY

**Total Building Sq. Ft.:** 32,500

**Available Sq. Ft.:** 32,500

**Building Type:** Built

**Available Shop Sq. Ft.:** 28,500

**Available Office Sq. Ft.:** 4,000

**Mezzanine:** N/A

**Office Dim:** N/A

**Shop Dim:** N/A

### PROPERTY INFORMATION

**Clear Height:** 22'

**Grade Level Door(s):** 2: 14 x 16

**Truckwells or Docks:** 2

**Exterior Construction:** Block/Steel

**Structural System:** Steel

**Air-Conditioning:** N/A

**Heating:** Gas

**Availability:** Immediately

**Power (Amps/Volts):** 1200 Amps, 480 Volts

**Freestanding:** Yes

**Rail:** No

**Security:** No

**Interior:** Yes

**Lighting:** N/A

**Bay Sizes:** 50'

**Restrooms:** 4

**Cranes:** No

**Parking:** 32, Ample

**Year Built:** 1994

**Sprinklers:** Yes

**Signage:** None

**Exterior:** No

**Roof:** Membrane

**Floors:** N/A

**Floor Drains:** No

**Acreage:** 1.940

**Land Dimensions:** N/A

### PRICING INFORMATION

**Lease Rate:** \$6.25

**Lease Type:** NNN

**Lease Term:** N/A

**Improvement Allowance:**

**Mthly Rate:** N/A

**Taxes:**

**Parcel #:** 22-07-326-048

**Options:** N/A

**TD:** N/A

**Deposit:** N/A

**Assessor #:** N/A

**Tenant Responsibility:**

### COMMENTS

Beautiful corporate image facility. Modern office floor plan. Clean painted shop with heavy power and buss duct. Easy access to I-96.

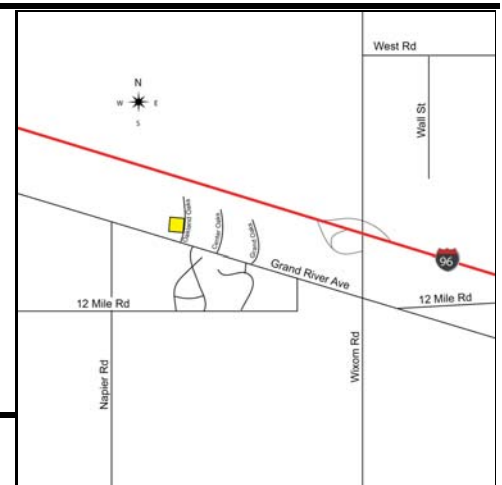

**Broker:** Signature Associates

**Agent(s):**

Jim Montgomery, (248) 359-0614, jmontgomery@signatureassociates.com