

Middlesex Business Center

100 Corporate Court
South Plainfield, NJ 07080



GROSS LEASABLE AREA
429,000 sf

Building Specifications

- Size:** 30,000 - 60,000 square feet per building
- Built:** 1982-1987
- Ceiling Height:** 9'/ 18' clear warehouse areas
- Floor loads:** 225 lbs. psf
- Loading dock:** 1/ 6,000 square feet in flex buildings
- Electrical capacity/voltage:** 100 amp/ 6,000 square feet
- Base building cooling/heating:** Individual RTU HVAC units with economizers
- Life safety:** Fully-sprinklered
- Elevators:** No
- Parking:** 2.5/ 1,000 - 4.0/ 1,000 depending on building
- Building hours of operation:** 24/7
- Security:** Yes

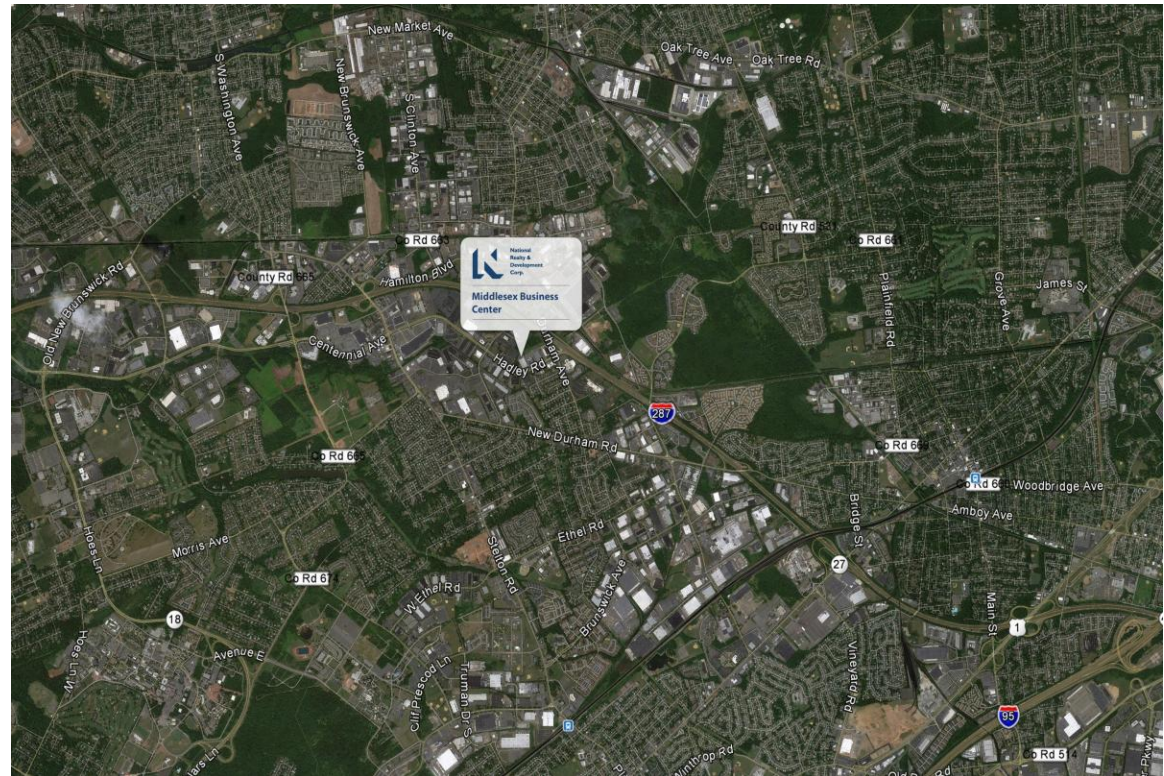

Details

- Middlesex Business Center consists of an 11-building office complex and is one of the premier corporate parks in central New Jersey.
- The complex is directly off I-287 and within 6-miles of the NJ Turnpike and Garden State Parkway.
- Adjacent to the Hadley Center shopping center which features Target, Dick's Sporting Goods, Kohl's, Marshalls, Regal Cinemas, and numerous restaurants including, Five Guys, Brickhouse Tavern & Tap and Joe's Crabshack.
- 10-miles from the New Brunswick campus of Rutgers State University.
- Ample on-site parking is available.

Middlesex Business Center

100 Corporate Court
South Plainfield, NJ 07080



Space Available

Building 600: 12,450 sf

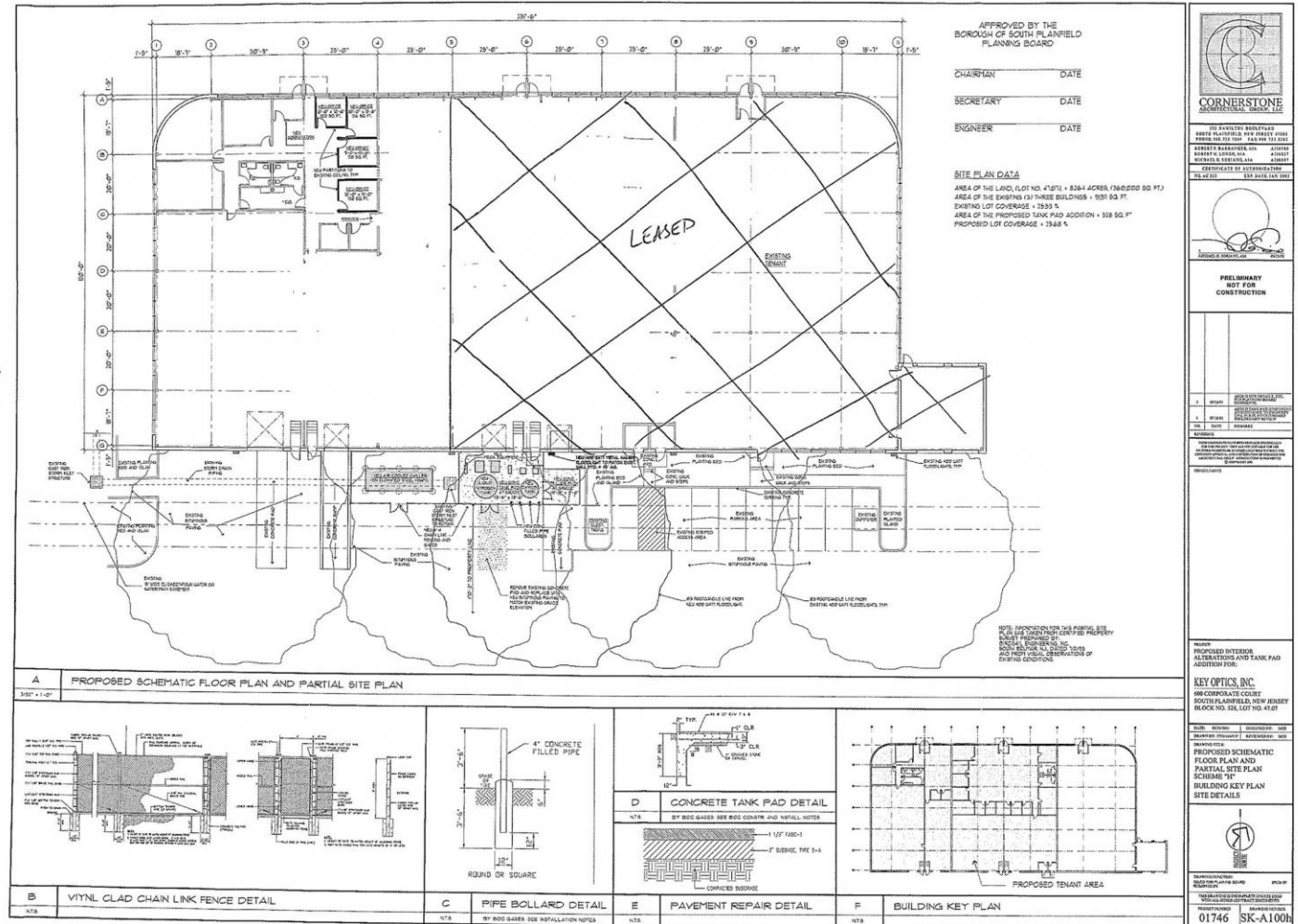

Middlesex Business Center

100 Corporate Court
South Plainfield, NJ 07080



Middlesex Business Center

100 Corporate Court
South Plainfield, NJ 07080



Middlesex Business Center

100 Corporate Court
South Plainfield, NJ 07080

Leasing Contacts



Brian F. Sekel

914.272.8033

brian.sekel@nrdc.com