

WEST VILLAGE

NEW YORK
NY

165 CHARLES STREET



CONCEPTUAL RENDERING

SPACE DETAILS

LOCATION

Northeast corner of West Street

APPROXIMATE SIZE

Ground Floor 1,673 SF*

**Plaza area available to commercial/retail unit*

APPROXIMATE FRONTAGE

120 FT of wraparound

CEILING HEIGHT

Ground Floor 12 FT

TERM

Long term

POSSESSION

Immediate

SITE STATUS

Formerly Classic Sofa

NEIGHBORS

Perry St, Narrow by Dorian Ashe, The Spotted Pig, Aria Wine Bar, Brodo Broth Co., Joe & The Juice, The Otheroom, Eli Klein Gallery, RedFarm, Barbuto, La Casa Femme, L'Artusi, Bongo, The Rusty Knot, and Wallsé

COMMENTS

At the base of a Richard Meier's 22-unit condominium building, awarded the 2005 Housing Design Award from the American Institute of Architects

Floor-to-ceiling windows offer great visibility from West Street and views of the Hudson River

Ideal uses include office space, art gallery, showroom, creative, café (without cooking requiring a vent), lounge/wine bar, medical, and physical therapy tenants

GROUND FLOOR

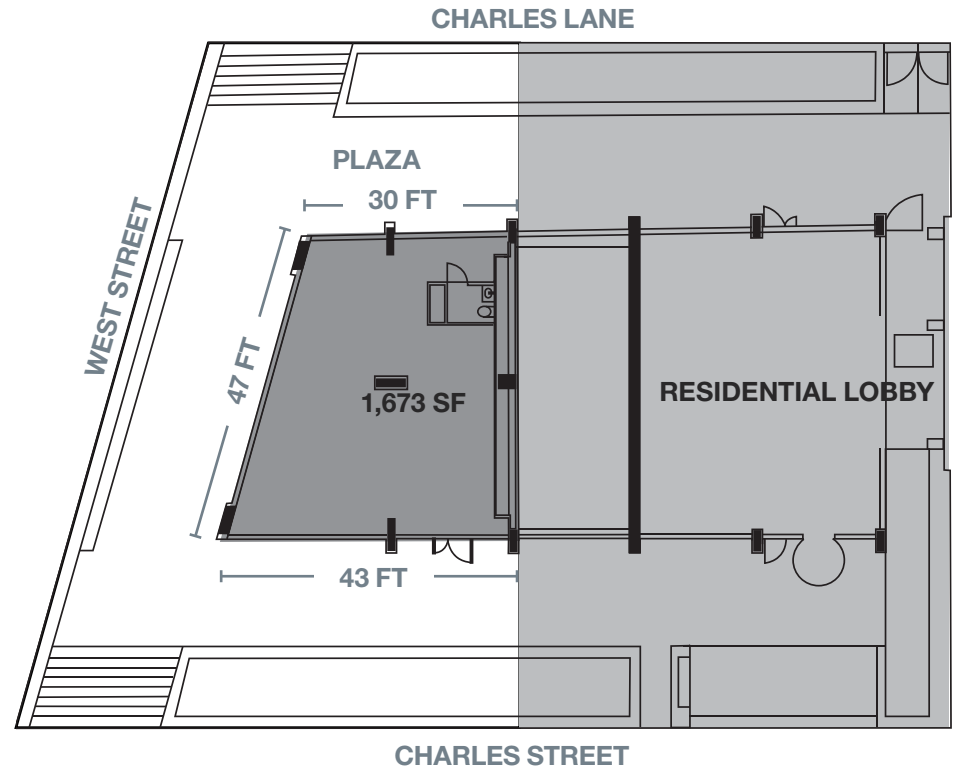

- PLAZA AREA AVAILABLE TO COMMERCIAL/RETAIL UNIT
- COMMERCIAL/RETAIL UNIT
- RESIDENTIAL AREA

AREA NEIGHBORS



AREA RETAIL



CONTACT EXCLUSIVE AGENTS

SAL FERRIGNO
212.372.2185
sferrigno@ngkf.com

LUCAS KOOYMAN
212.372.2384
lkooyman@ngkf.com



NGKF.COM

© 2019 NEWMARK KNIGHT FRANK RETAIL. The information contained herein has been obtained from sources deemed reliable but has not been verified and no guarantee, warranty or representation, either express or implied, is made with respect to such information. Terms of sale or lease and availability are subject to change or withdrawal without notice.