

LAND

SWC I-27 & 19TH ST.  
LUBBOCK, TX

FOR SALE / BTS



RICK CANUP, REALTORS®  
Each office is Independently Owned and Operated

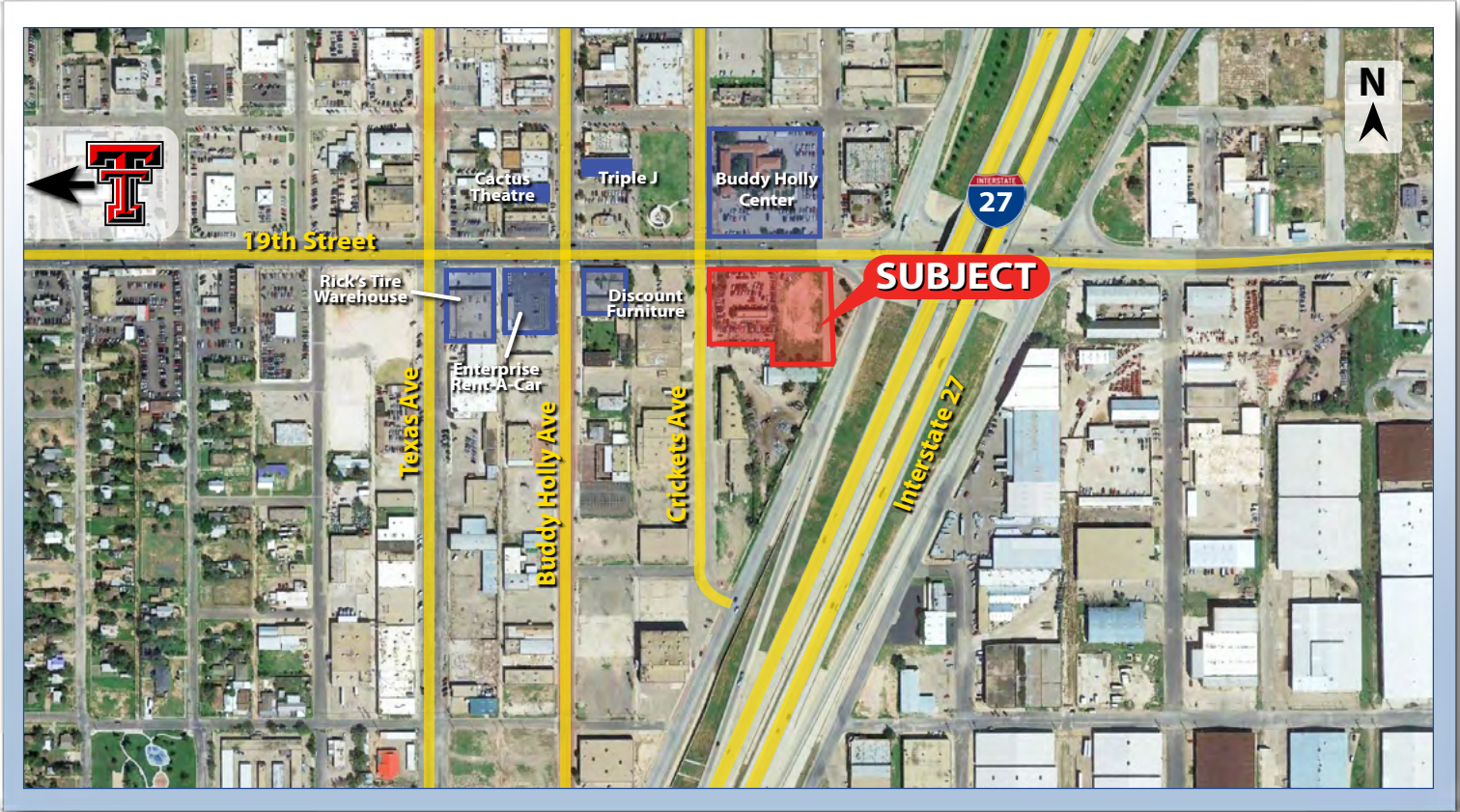

PROPERTY INFORMATION

DESCRIPTION:

A PRIME tract of land located in a highly trafficked region of central Lubbock. This property is an ideal location for convenient store, restaurant, and retail use.

LOCATION:

This tract fronts Interstate-27, a highly trafficked thoroughfare connecting Amarillo, TX to Lubbock, TX. This property also fronts 19th Street across from the Buddy Holly Center, Triple J Chophouse, and the Cactus Theater. This tract is less than 2 miles east of Texas Tech University and the newly developed Overton Park.

SF:

1.812 acres

PRICE:

\$14.00 per sq. ft. or Build-to-Suit

FLOOD ZONE:

Tract is NOT located in a flood zone.



Beau Tucker, CCIM  
The Land Man  
806.784.3298 direct  
806.470.3944 cell  
BTucker@CBCWorldwide.com

LAND

SWC I-27 & 19TH ST.  
LUBBOCK, TX

FOR SALE / BTS



RICK CANUP, REALTORS®  
Each office is Independently Owned and Operated

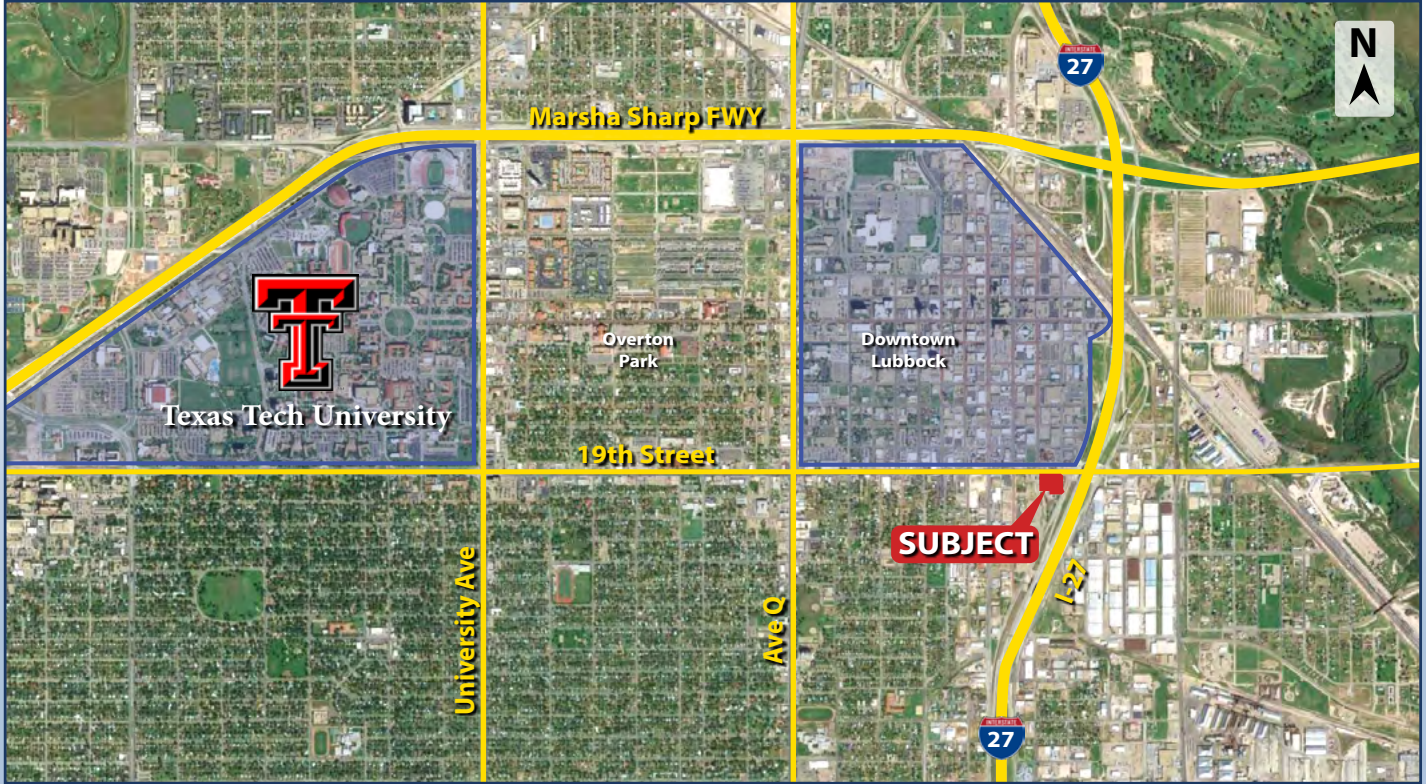

LUBBOCK FACTS

- Lubbock is home to a "Soon to be" Tier One research institution: **Texas Tech University** whose undergraduate enrollment is expected to grow 2.5% annually.
- **Five colleges and universities** with 40,000 students enrolled annually.
- **580,000+ people live within a 90-minute drive** time who look to Lubbock for shopping, entertainment, and medical services.



Coldwell Banker Commercial Rick Canup, Realtors®

806.793.0888

4924 S. Loop 289 Lubbock, TX 79414

CBC Lubbock.com  
CBC Worldwide.com

© 2015 Coldwell Banker Real Estate LLC, dba Coldwell Banker Commercial Affiliates. All Rights Reserved. Coldwell Banker Real Estate LLC, dba Coldwell Banker Commercial Affiliates fully supports the principles of the Equal Opportunity Act. Each Office is Independently Owned and Operated. Coldwell Banker Commercial and the Coldwell Banker Commercial Logo are registered service marks owned by Coldwell Banker Real Estate LLC, dba Coldwell Banker Commercial Affiliates.