



1954 S. TROY



FOR RENT | INDUSTRIAL

THREE-STORY LIGHT INDUSTRIAL WAREHOUSE BUILDING FOR MANUFACTURING, WELDING, CUSTOM CABINETS/COUNTERS, STORAGE, ARTISANS AND MANY OTHER USES! NEXT DOOR TO CTA PINK LINE KEDZIE STATION AND MINUTES FROM THE EISENHOWER EXPRESSWAY!

LOCATION | 1954 S. TROY AVE. CHICAGO, IL 60647

SPACE AVAILABLE | 2,259 - 5,758 SF

MONTHLY RENT | STARTING AS LOW AS \$895 / MONTH

CEILING HEIGHT | 9 - 12 FT.

ZONING | C1-2



CONTACT

TERRI COX

312-337-1001 xt. 2028
tcox@matanky.com

DON WAGENER

312-337-1001 xt. 2014
dwagener@matanky.com

1954 S. TROY

1954 SOUTH TROY AVENUE, CHICAGO, ILLINOIS 60647

1ST FLOOR

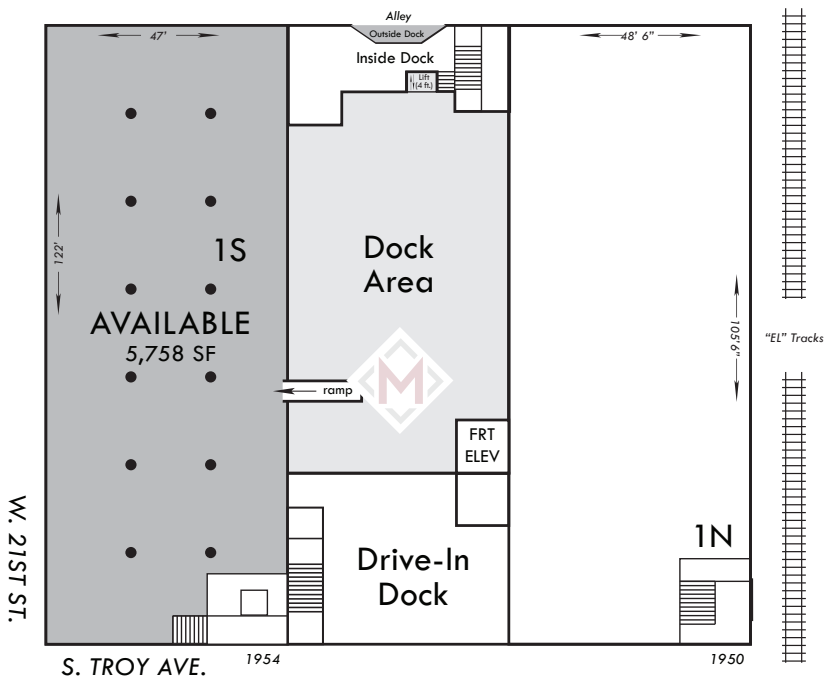

2ND FLOOR

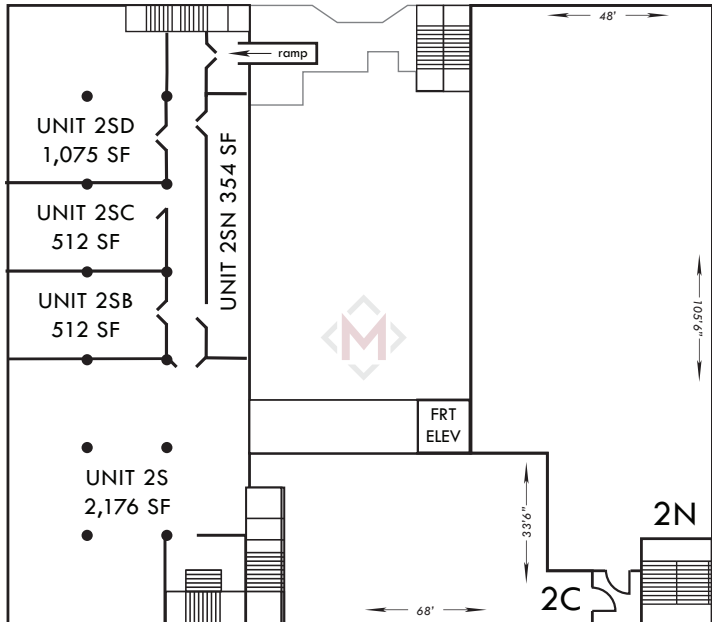

3RD FLOOR

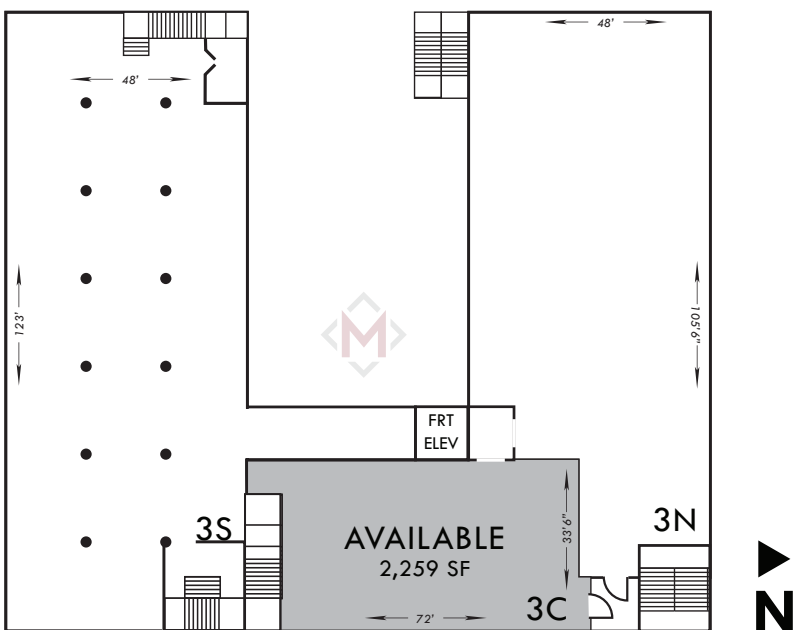

SITE PLAN



LOCATION



312-337-1001



TERRI COX | DON WAGENER

JOIN US ON:



MATANKY REALTY GROUP

WWW.MATANKY.COM