



Denver Health

601 Broadway | Denver, Colorado 80203

Property Overview

- 1,011 SF retail space available in the new Denver Health Support Services building
- Join Thump Coffee, Potbelly Sandwich Shop, and FedEx
- High foot traffic due to neighborhood density and proximity to Central Business District
- Strong growth in population and area demographics
- Several new multi-family developments under construction
- Excellent visibility and exposure to over 40,000 daily vehicles

Lease Rate: \$30.00/SF NNN

Property Facts

Available SF:	1,011 SF
Year Built:	2017
Zoning:	C-MX-16

For more information:

Dorit Makovsky Fischer

303 565 3025
dfischer@shamesmakovsky.com

Hayden Hirschfeld

303 565 3048
hhirschfeld@shamesmakovsky.com

1400 Glenarm Place, Suite 100
Denver, CO 80202
303 534 5005

naishamesmakovsky.com

NO WARRANTY OR REPRESENTATION, EXPRESS OR IMPLIED, IS MADE AS TO THE ACCURACY OF THE INFORMATION CONTAINED HEREIN, AND THE SAME IS SUBMITTED SUBJECT TO ERRORS, OMISSIONS, CHANGE OF PRICE, RENTAL OR OTHER CONDITIONS, PRIOR SALE, LEASE OR FINANCING, OR WITHDRAWAL WITHOUT NOTICE, AND OF ANY SPECIAL LISTING CONDITIONS IMPOSED BY OUR PRINCIPALS. NO WARRANTIES OR REPRESENTATIONS ARE MADE AS TO THE CONDITION OF THE PROPERTY OR ANY HAZARDS CONTAINED THEREIN ARE ANY TO BE IMPLIED.

For Lease

6th & Broadway Denver, Colorado



Traffic Counts

Vehicles/Day

Broadway & Speer Boulevard 44,012

Broadway & 6th Avenue 40,385

*Source: CoStar

For more information:

Dorit Makovsky Fischer

303 565 3025

dfischer@shamesmakovsky.com

Hayden Hirschfeld

303 565 3048

hhirschfeld@shamesmakovsky.com

Floor Plan

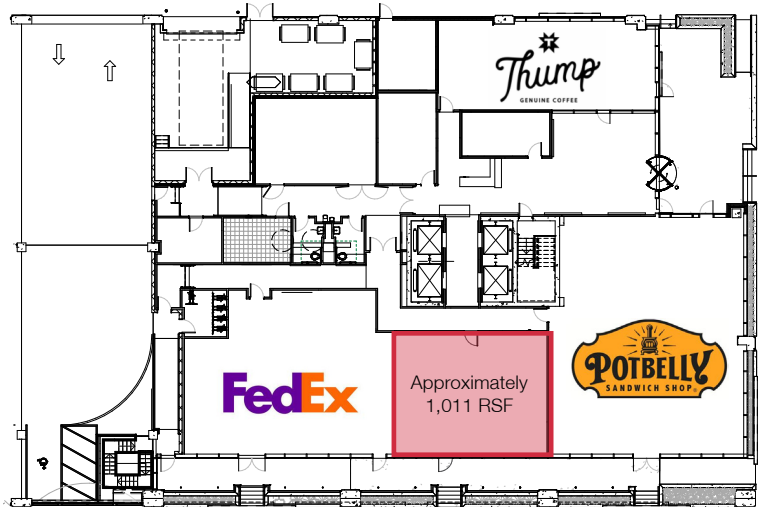

Demographics

	1 Mile	3 Mile	5 Mile
Population	40,738	232,385	543,453
Average Household Income	\$25,150	\$115,234	\$240,587
Daytime Employees	41,568	261,314	403,741

*Source: SitesUSA

1400 Glenarm Place, Suite 100
Denver, CO 80202
303 534 5005

naishamesmakovsky.com

NAIShames Makovsky