174 Conselyea Street

EAST WILLIAMSBURG
BROOKLYN, NY

NEWMARK



Property Details

Location

Noth block between Graham Avenue and Humboldt Street

Approximate Size

Ground Floor 750 SF
Basement 750 SF

Frontage

14 FT on Conselyea Street

Term

Long term

Possession

Immediate

Site Status

Currently vacant

Neighbors

Brooklyn Harvest Market, Carmine's, Mother's, Uncle Louie G, Cross County Savings Bank, Hungry Ghost Coffee, Variety Coffee Roasters, Concord Hill and C Town Supermarkets

Comments

Located steps from bustling Graham Avenue and the **L** Train with 2,709,511 annual riders

High 14 FT ceilings and full basement

Use Group 6 allows for multitude of businesses

Space includes sky light

Ground Floor

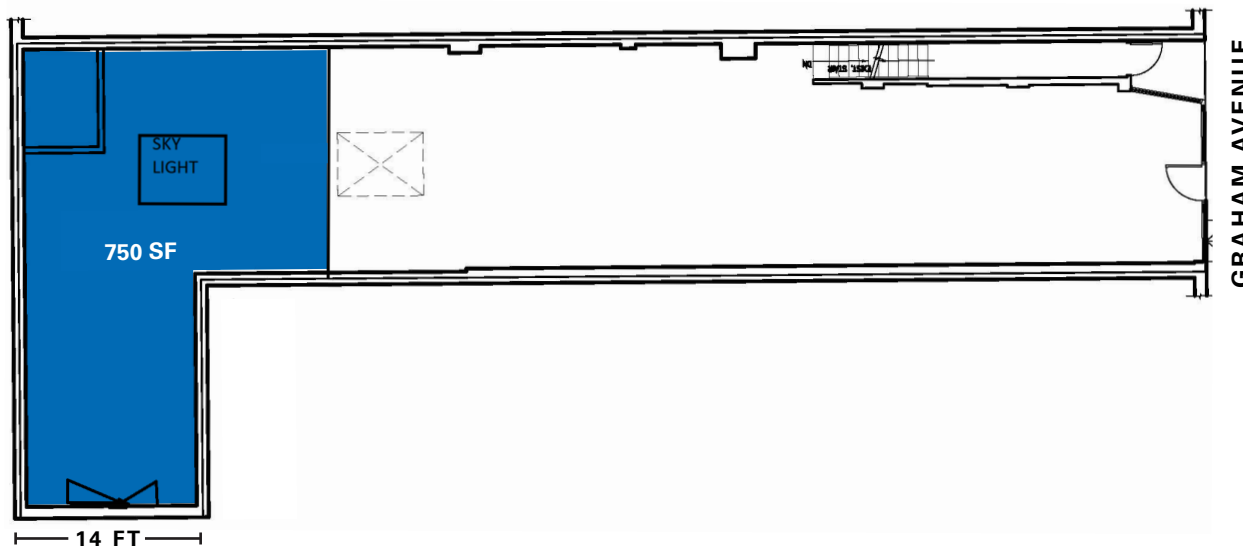

CONSELYEA STREET

Ground Floor

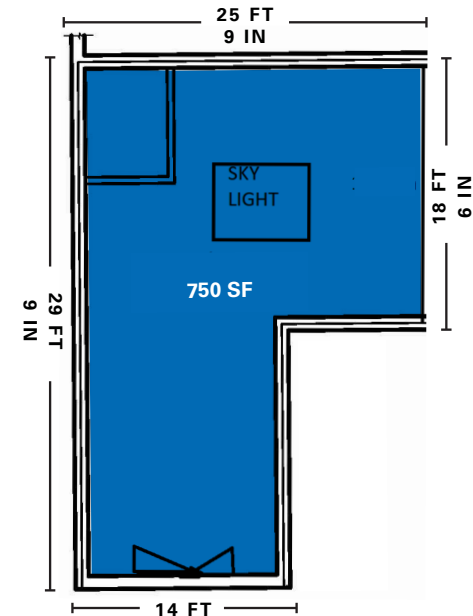

CONSELYEA STREET

NEWMARK

Interior Photos



Demographics



Estimated Daytime Population

0.25 miles	8,674
0.5 miles	31,299
1 mile	120,787

Median Household Income

0.25 miles	\$110,375
0.5 miles	\$94,059
1 mile	\$83,024

Total Households

0.25 miles	1,634
0.5 miles	6,286
1 mile	23,197

Average Household

Expenditure on Apparel	
0.25 miles	\$3,561.66
0.5 miles	\$3,282.69
1 mile	\$3,039.75

Average Household Expenditure on Food at Restaurants

0.25 miles	\$6,602.01
0.5 miles	\$5,899.57
1 mile	\$5,400.88

CONTACT

David Dubinsky
 t 212-916-2932
 david.dubinsky@nrmk.com

Barry Fishbach
 t 212-331-0115
 barry.fishbach@nrmk.com

nrmk.com