



**PROPERTY HIGHLIGHTS**

- New to market: 1.5 acre parcel fronting SR 14 in Streetsboro
- Signalized access with great visibility from RT 303 and SR 14
- Tremendous traffic counts on SR 14
- Part of the major national retail alleyway with nearby highway access
- Redevelopment opportunity

**TRADE AREA DEMOGRAPHICS**

	POPULATION	AVG. HH INCOME	DAYTIME EMPLOYEES
<b>3 Miles</b>	17,771	\$85,173	10,645
<b>5 Miles</b>	44,640	\$114,181	24,853
<b>7 Miles</b>	123,453	\$96,714	69,767
<b>10 Minute</b>	94,876	\$102,488	58,978

**QUICK LINKS** *(click to view)*

3401 Richmond Rd., Suite 200  
Beachwood, OH 44122  
[www.passovgroup.com](http://www.passovgroup.com)

**FOR MORE INFORMATION, CONTACT: 216.831.8100**

Lidia Richani / [lrchani@passovgroup.com](mailto:lrchani@passovgroup.com)



The information contained herein was obtained from sources believed to be reliable. Passov Real Estate Group makes no guarantees, warranties or representations as to the completeness or accuracy thereof. The presentation of this property is submitted subject to errors, omissions, change of price or condition, prior sale or lease, or withdrawal without notice. All information should be verified prior to purchase or lease.

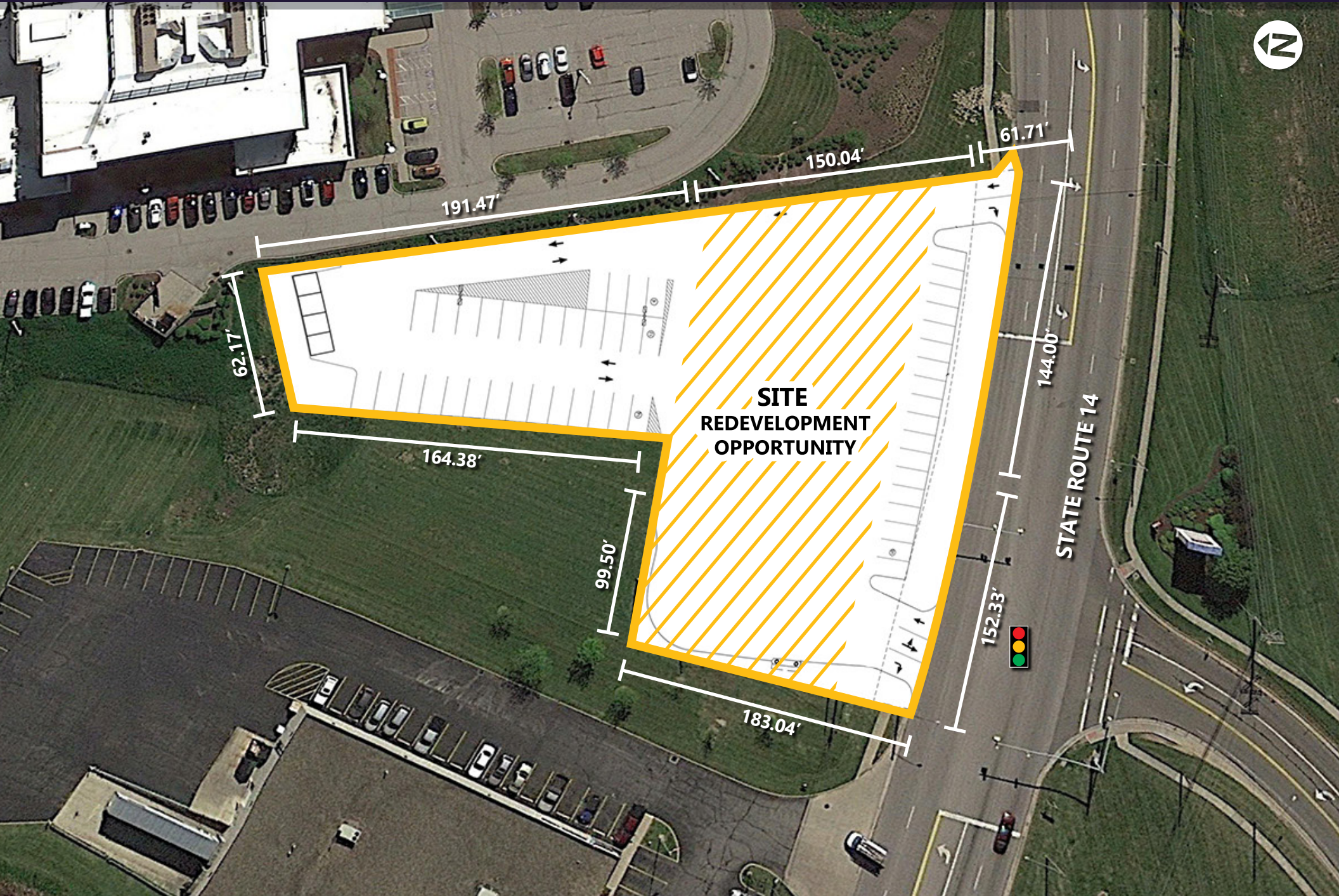

**SITE  
REDEVELOPMENT  
OPPORTUNITY**

STATE ROUTE 14



