

FOR LEASE | UNIT D

SHOWROOM/OFFICE/ WAREHOUSE/RETAIL

4211

S. NATCHES COURT

OXFORD-SANTA FE BUSINESS PARK :: ENGLEWOOD, CO 80110



PROPERTY FEATURES

- + 3' x 8' backlit identification sign
- + Drive-in loading doors (10'x10')
- + On-site management
- + Close to Riverpoint Shopping Center, banks, restaurants, Target and Costco
- + Free tenant and customer parking
- + 200 yards to Oxford Light Rail Station
- + Available November 1, 2015
- + Individual meter in each unit for gas and electricity

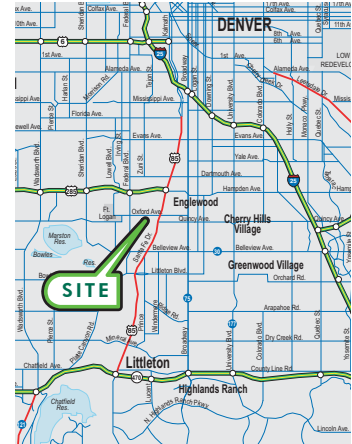

www.cbre.com/denver

CBRE

FOR LEASE UNIT D

4211
S. NATCHES COURT
OXFORD-SANTA FE BUSINESS PARK



SITE PLAN

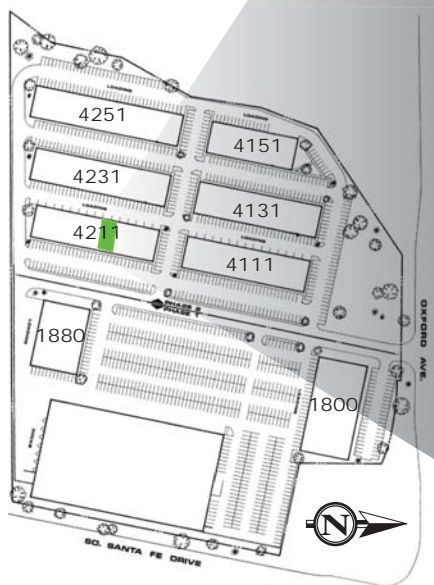

DRIVE-IN

RR



BUILDING DETAILS

AVAILABLE:	2,400 SF
OFFICE AREA:	925 SF
LOADING:	1 roll up door
ELECTRICAL:	100 amps, 3 phase
CLEARANCE:	12'
YEAR BUILT:	1983-1984
LEASE RATE:	\$10.50/SF NNN
NNN EXPENSES:	\$2.50/SF



CONTACT US

MURRAY PLATT, SIOR

First Vice President
+1 720 528 6413
murray.platt@cbre.com

PAUL KLUCK, SIOR

First Vice President
+1 720 528 6405
paul.kluck@cbre.com

© 2015 CBRE, Inc. The information contained in this document has been obtained from sources believed reliable. While CBRE, Inc. does not doubt its accuracy, CBRE, Inc. has not verified it and makes no guarantee, warranty or representation about it. It is your responsibility to independently confirm its accuracy and completeness. Any projections, opinions, assumptions or estimates used are for example only and do not represent the current or future performance of the property. The value of this transaction to you depends on tax and other factors which should be evaluated by your tax, financial and legal advisors. You and your advisors should conduct a careful, independent investigation of the property to determine to your satisfaction the suitability of the property for your needs.

Photos herein are the property of their respective owners and use of these images without the express written consent of the owner is prohibited.