

1 PENN PLAZA

PARTIAL 24TH FLOOR



SUBLEASE

TERM: Thru June 29, 2022

RENT: Negotiable

SIZE: 10,282 SF

SPACE FEATURES:

- Vacant
- Furnished
- Built with 9 perimeter offices, conference room, huddle room, training room for 30, pantry and open area for 20 workstations

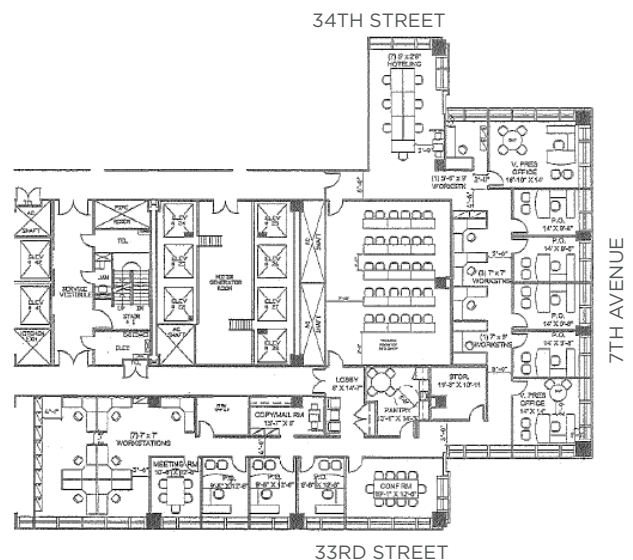

YARDEN DRIMMER
212 328 4220
yarden.drimmer@cushwake.com

CONOR GOLDEN
212 841 5938
conor.golden@cushwake.com

MATT FISHER
212 328 4258
matthew.fisher@cushwake.com



A full commission computed and earned in accordance with the rates and conditions of our agency agreement with our principal, when received from our principal, will be paid to a cooperating broker who consummates a sublease which is unconditionally executed and delivered by and between sublandlord and subtenant. (A copy of the rates and conditions referred to above are available upon request.)

SPACE PHOTOS

**1 PENN
PLAZA**
PARTIAL 24TH FLOOR

