

Northgate Plaza

460 Washington Road, Washington, PA 15301



Available Space

- 14,700 SF (Former Save-A-Lot Space) - Approximately 104' x 140'
- 2,800 SF (Former Special Occasions)

Property Highlights

- Ideally located just off the I-70/I-79 interchange in Washington County
- Northgate Plaza is located across from the Old Mill Shops and is in close proximity to Trinity Point, Strabane Square, Washington Mall and Oak Spring Center

AVERAGE DAILY TRAFFIC

Route 19	21,987
----------	--------

DEMOGRAPHICS

	3-MILES	5-MILES
Population	30,783	52,080
Avg. HH Income	\$49,335	\$54,028

NET CHARGES (\$2.29/SF)

CAM:	\$1.07/SF
Real Estate Taxes:	\$0.95/SF
Insurance:	\$0.27/SF

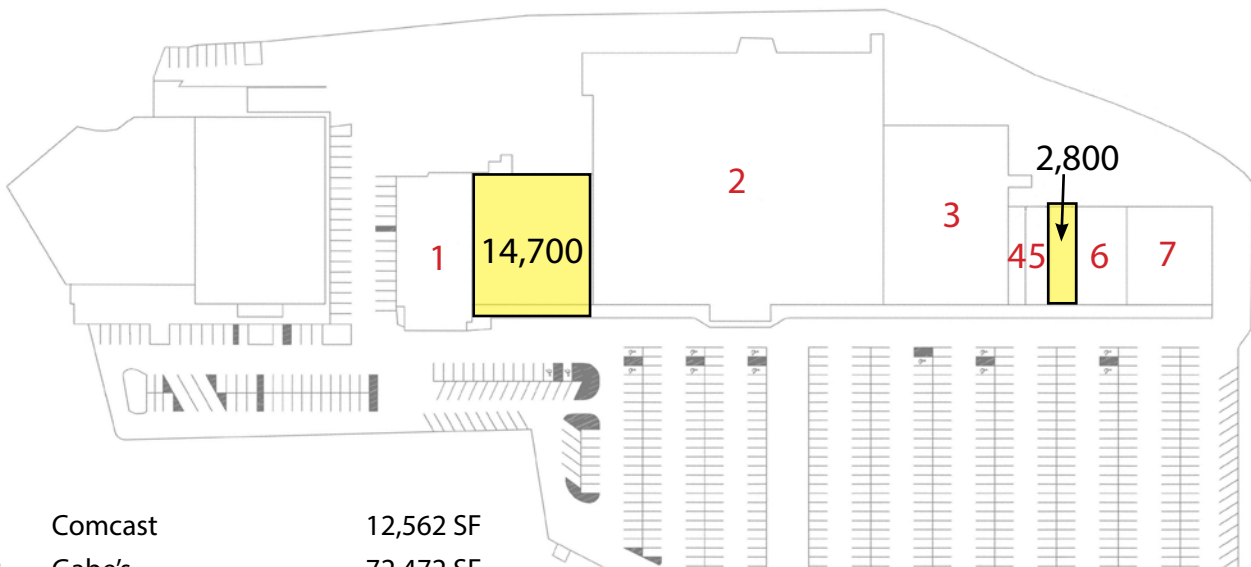
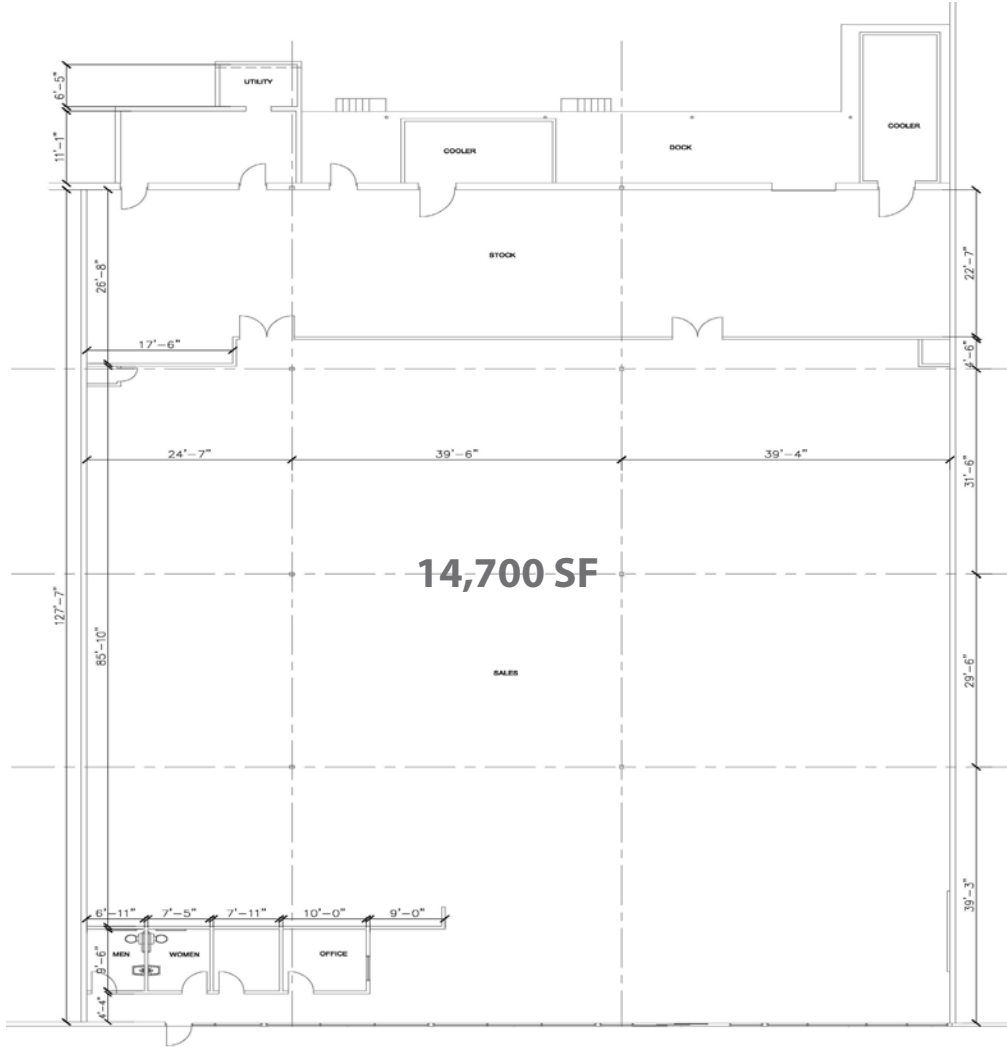

- | | | |
|---|------------------------|-----------|
| 1 | Comcast | 12,562 SF |
| 2 | Gabe's | 72,472 SF |
| 3 | Pool City | 21,600 SF |
| 4 | CosmoPro | 2,000 SF |
| 5 | Keller Williams Realty | 2,200 SF |
| 6 | Katsur Dental | 5,000 SF |
| 7 | Med Express | 8,000 SF |



For more information please contact:

Arthur J. DiDonato, Jr.
Senior Vice President, Retail Brokerage

Oxford Realty Services, Inc.

412.261.0200, ext 3436

adidonato@oxfordrealtyservices.com

OXFORD

REALTY SERVICES, INC.

2545 Railroad Street - Suite 300

Pittsburgh, PA 15222

www.oxfordrealtyservices.com

Although all information furnished regarding property for sale, rental or financing is from sources deemed reliable, such information has not been verified, and no express representation is made nor is any to be implied as to the accuracy thereof, and it is submitted subject to errors, omissions, change of price, rental or other conditions, prior sale, lease or financing, or withdrawal without notice. Rental terms and all dimensions are approximate and specifications are subject to change without notice. Oxford Realty Services, Inc., an independent real estate services company.