



# BALTIMORE, MD

**The Rotunda** is a newly restored iconic Baltimore office building built in the 1920's. 293,996 SF of storefront retail and office space occupy the historic 3-story structure and its outbuildings. This includes 379 modern luxury apartments, and a 7-story parking garage. The entire complex surrounds a central plaza designed for outdoor dining and local community gathering. We've brought all the benefits of living in Charm City into one convenient location.

## KEY TENANTS

- MOM's Organic Market
- Cinebistro Theater
- Brick Bodies Gym
- Starbucks
- Walgreens
- Pet Valu
- Massage Envy
- Xfinity
- The UPS Store
- MOD Pizza

## PARKING SPACES

+/- 1,000

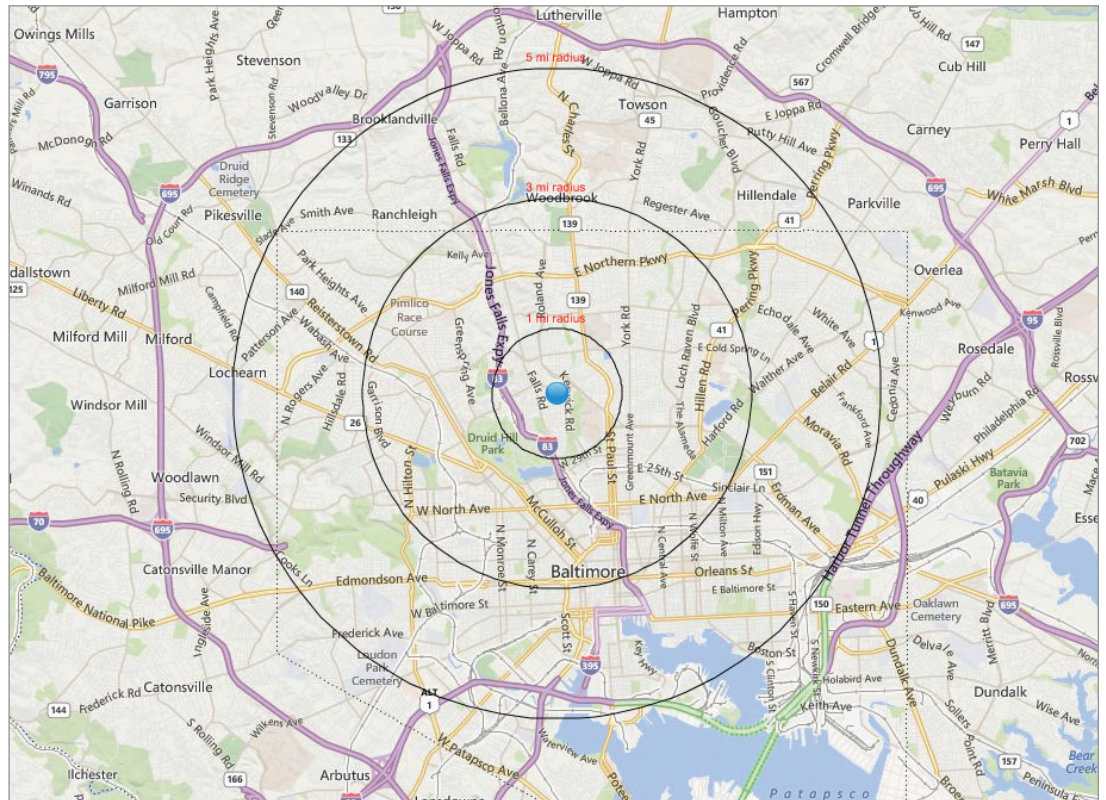

## DEMOGRAPHICS

	1 MI.	3 MI.	5 MI.
POPULATION	29,931	254,473	619,950
AVG. HOUSEHOLD INCOME	\$ 102,054	\$ 73,540	\$ 79,814



[www.hekemian.com](http://www.hekemian.com)

505 Main Street / Hackensack, NJ / 07602 / 201-487-1500

# The Rotunda

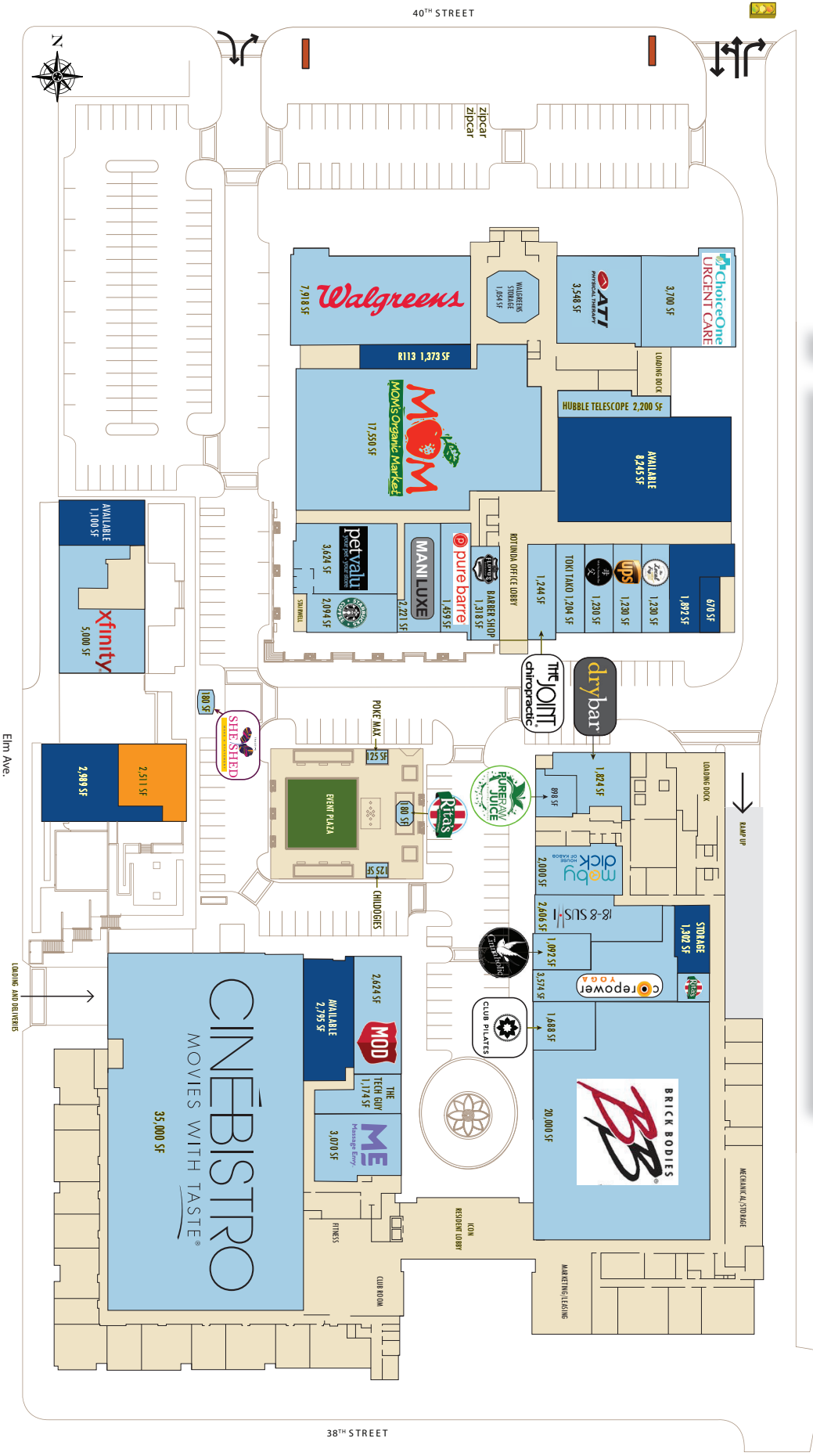

Alli Oliver / (410) 626-9607 / aoliver@aoretail.com