

TRIBECA LOFT PERFECT
FOR CREATIVE OFFICE

Second Floor.....800 SF approx.
Third Floor.....1,800 SF approx.
Ceilings (Second Floor).....9'
Ceilings (Third Floor).....10' 6"
Term.....5 Years
Possession.....Arranged
Price.....\$11,500/month



225-227 WEST BROADWAY
BETWEEN FRANKLIN & WHITE STREETS



 **SINVIN**
COMMERCIAL REAL ESTATE & ADVISORY

FEATURES:

- Kitchen, bathroom, large open area, and office
- A/C/E Subway on the corner
- Bright natural light within the space
- Located on a charming Tribeca block
- Floors must be leased together
- Private keyed separate entrance
- Full commission to procuring broker

NEIGHBORS INCLUDE:

- Maman
- Rag & Bone
- Bouley Botanical
- Distilled
- Cafe Clementine
- Terra Wine Bar
- J. Crew
- James Perse
- Steven Alan
- Sweet Lilly

CONTACT:

Steve Rappaport
646.673.8750
steve@sinvin.com



225-227 WEST BROADWAY



 **SIN VIN**
COMMERCIAL REAL ESTATE & ADVISORY

SECOND FLOOR

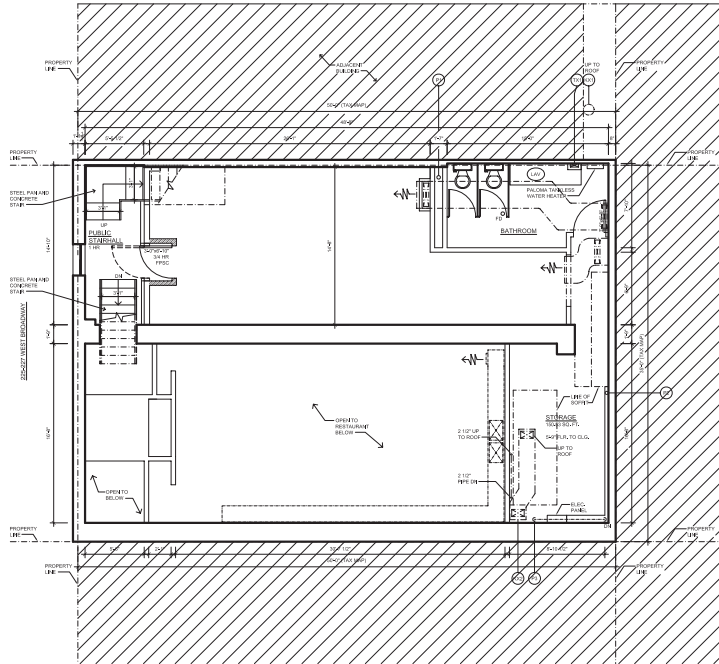

THIRD FLOOR

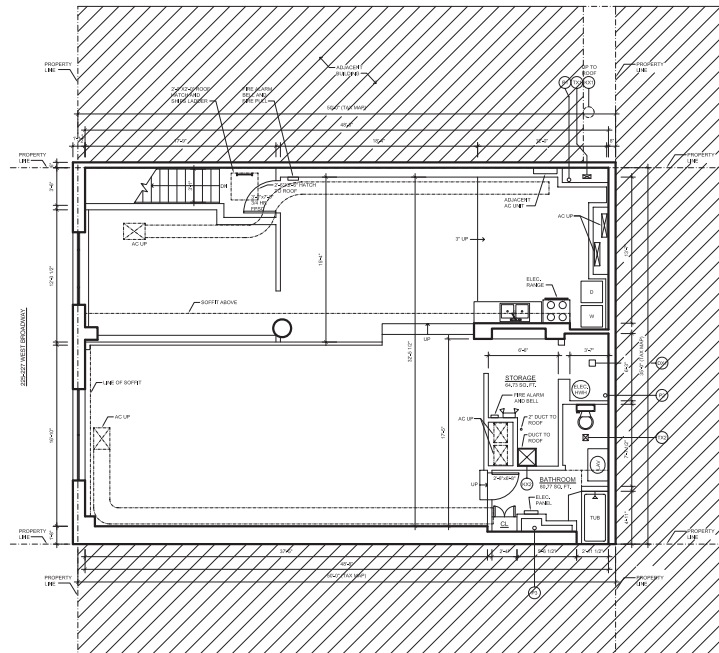

225-227 WEST BROADWAY
BETWEEN FRANKLIN & WHITE STREETS