

FOR LEASE > INDUSTRIAL SPACE

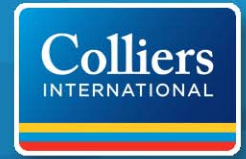

4,965 to 6,440 SF Flex

26820 HOBIE CIRCLE, SUITES B / D, MURRIETA, CA 92562



Property Features:

- > Approx. 2,730 Sq. Ft. of 1st / 2nd Floor Office
- > Approx. 2,235 Sq. Ft. of HVAC Improved Warehouse
- > Approx. 1,475 Sq. Ft. of Standard Warehouse (Ste. D)
- > Two (2) Grade-Level Loading Doors
- > 300 Amps, 120/208 Volt, 3-Phase Power
- > 9' to 18' Minimum Clearance
- > MU- 2 (Multiple Use) Zoning
- > Suites B & D Can Be Leased Separately
- > **LEASE RATE: \$0.60/SF Modified Gross**

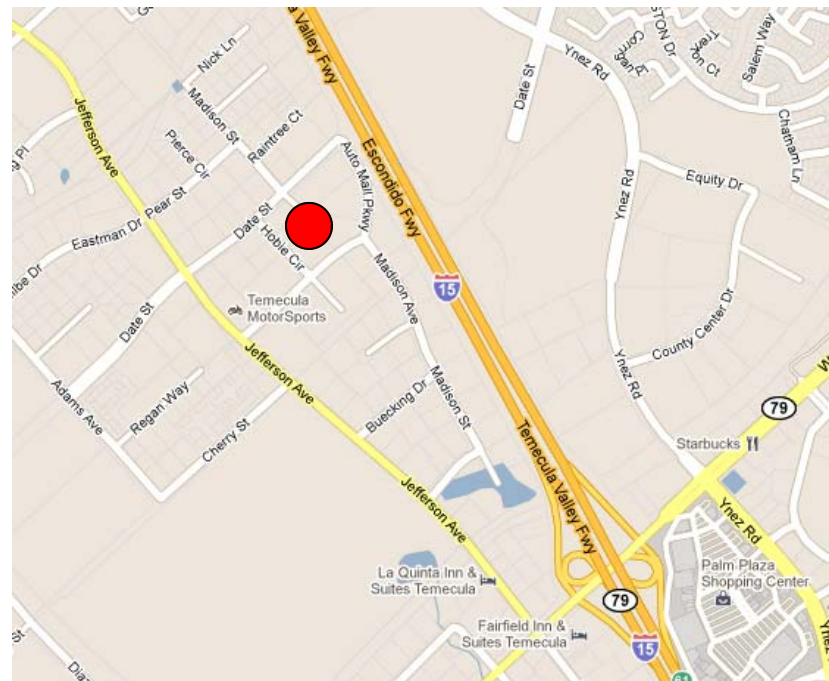

MIKE PAPPAS
951 695 3770
mike.pappas@colliers.com
Lic# 00981543

COLLIERS INTERNATIONAL
5901 Priestly Drive, Suite 100
Carlsbad, CA 92008
www.colliers.com/temecula

26820 Hobie Circle, Suites B / D > Site Plan

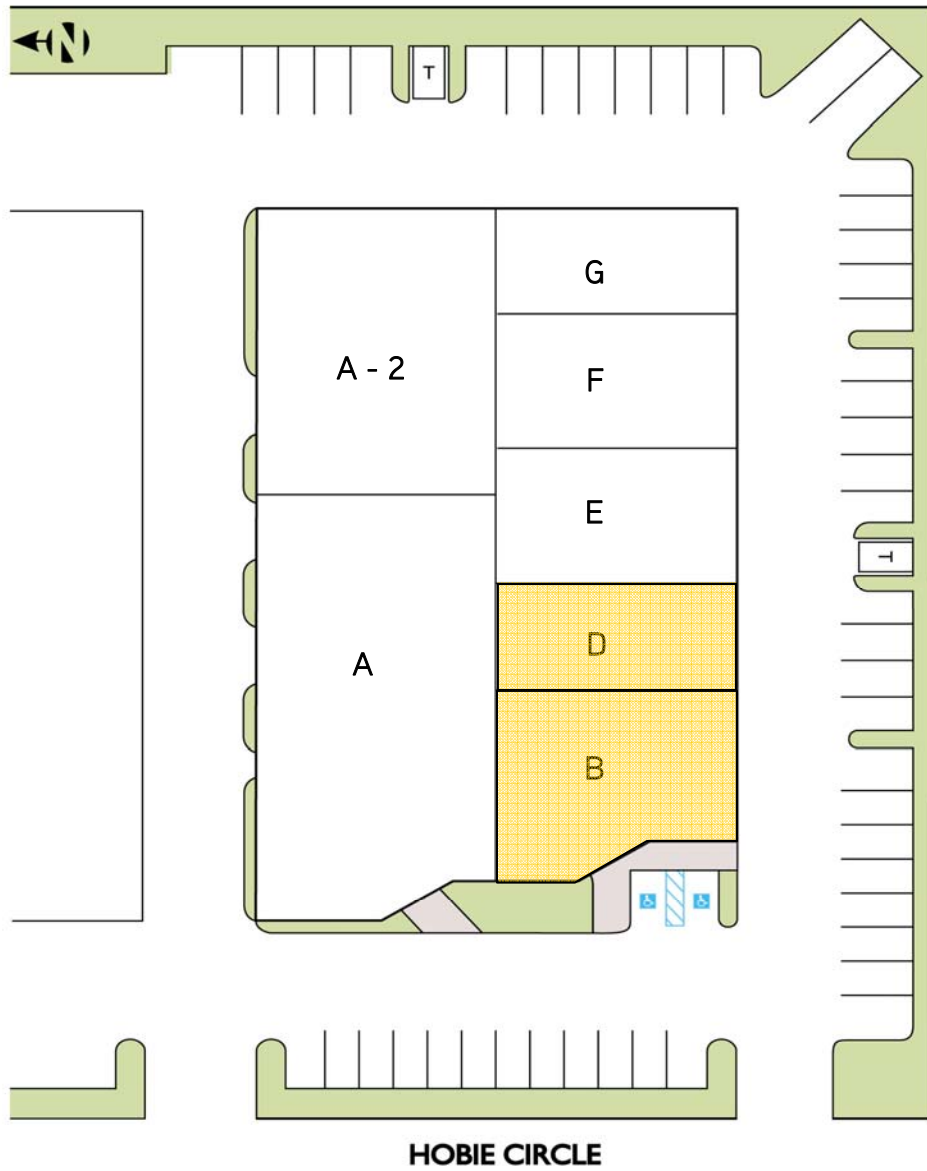

Contact Us

MIKE PAPPAS
951 695 3770
mike.pappas@colliers.com
Lic# 00981543

COLLIERS INTERNATIONAL
5901 Priestly Drive, Suite 100
Carlsbad, CA 92008
www.colliers.com/temecula

This document has been prepared by Colliers International for advertising and general information only. Colliers International makes no guarantees, representations or warranties of any kind, expressed or implied, regarding the information including, but not limited to, warranties of content, accuracy and reliability. Any interested party should undertake their own inquiries as to the accuracy of the information. Colliers International excludes unequivocally all inferred or implied terms, conditions and warranties arising out of this document and excludes all liability for loss and damages arising there from. Colliers International is a worldwide affiliation of independently owned and operated companies.

