

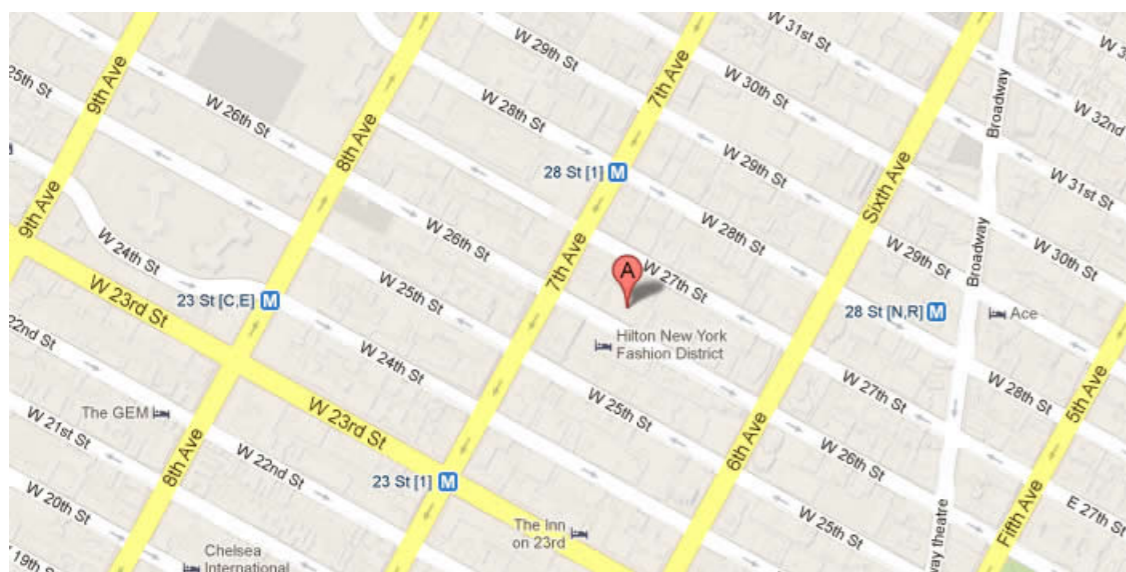

151 WEST 26TH STREET, New York, NY 10001



197,336.00 SF

Up To 2,433 SF Available

12 story office building with doorman in lobby
and Tenant-controlled A/C

This building is registered with the U.S. Green Building Council
Built: 1912 Architect: Schwartz & Gross & B.N. Marcus

Tenants

SWEDISH INSTITUTE INC
SWEDISH INSTITUTE INC
CHADO RALPH RUCCI, LLC
Sies Marjan LLC
SOCIAL CODE LLC

For more information call
1- 212- 249- 1550
KOEPEL ROSEN
40 East 69th Street
New York, NY 10021
dkoepfel@koepfelrosen.com

151 WEST 26TH STREET, New York, NY 10001

151 West 26th Street

Typical Floor Plan

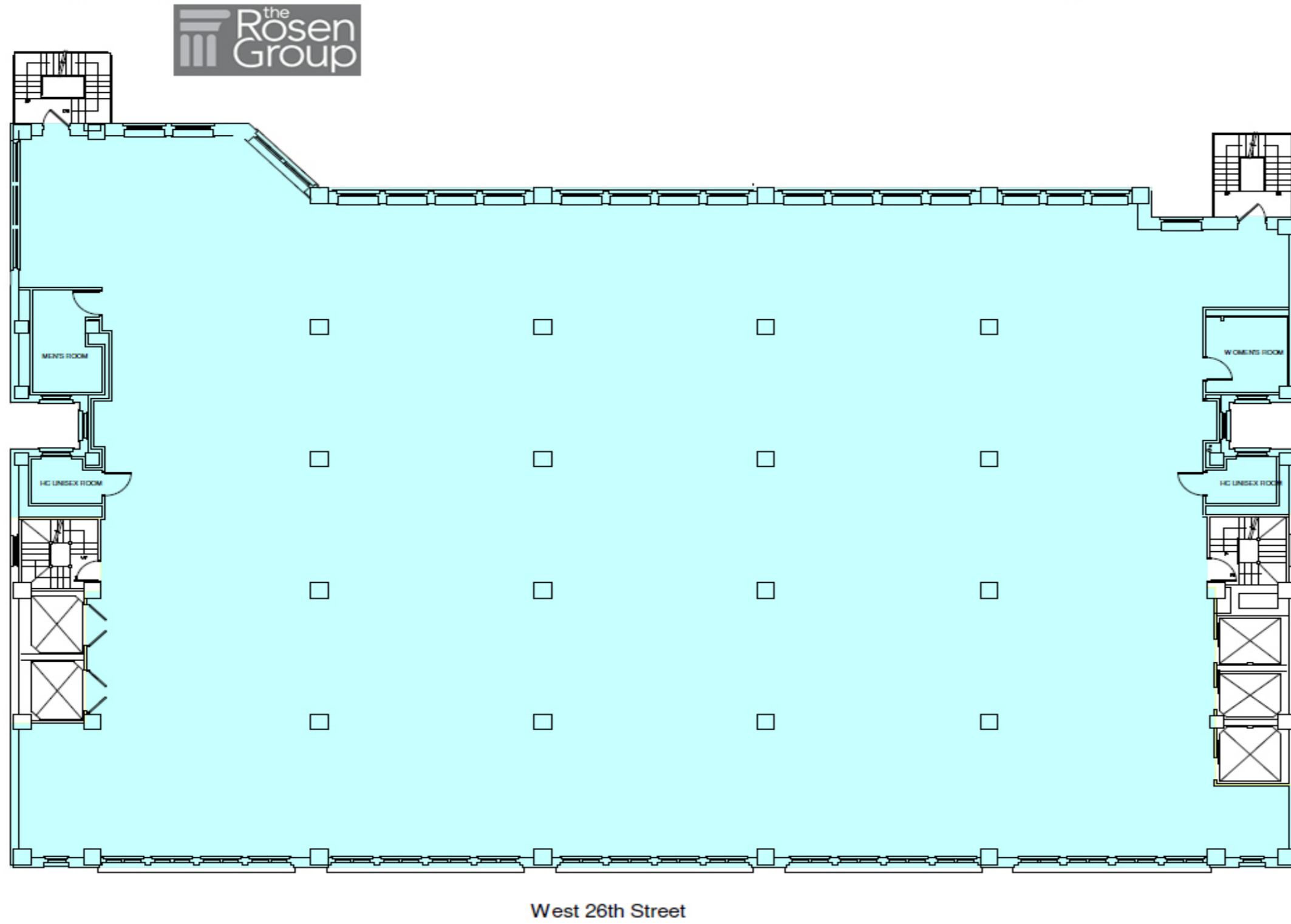

 Koeppel Rosen LLC
 40 East 69th Street
 New York, NY 10021
 212-249-1550
 www.koeppelrosen.com

Note: All dimensions and conditions are approximate and for information only

Scale: NTS
 Date: February 8, 2016



For more information call
 1- 212- 249- 1550
 KOEPEL ROSEN
 40 East 69th Street
 New York, NY 10021
 dkoeppe@koeppelrosen.com