

# FOR LEASE 366,117 SF



## → OVERVIEW

A 366,117 sf freestanding turnkey e-commerce facility (former iHerb facility):

- Air-conditioned warehouse, with 11.5M BTU capacity and can be cooled to 70 degrees
- Dematic Material Handling Systems with pick to light technology.
- Excellent access to the I-215 and SR-60 Freeways.

## → PROPERTY STATISTICS

Available SF	±180,000 - 366,117
Office Area SF	±23,080
Ceiling Height	32' Min. Clearance
Dock High Doors	56 (12 w/ Levelers)
Grade Level Doors	2
Trailer Parking	56 Trailer Stalls
Sprinkler System	EFSR
Electrical Service	4,000 Amps, 277/480V
Lighting	T-5 & T-8 Lighting

**17825 Indian Street  
Moreno Valley, CA**

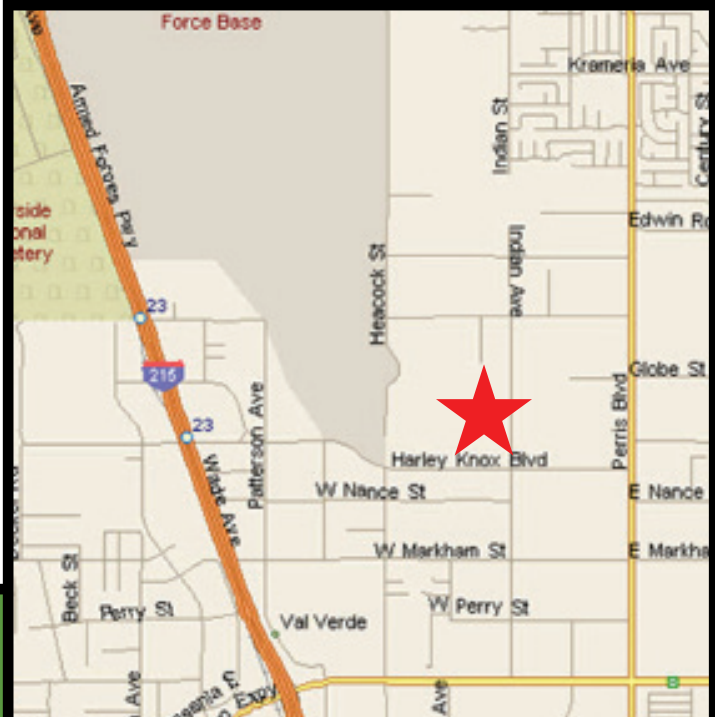

## FIRST INDUSTRIAL REALTY TRUST

898 N. Sepulveda Blvd Ste. 175, El Segundo, CA 90245  
T: (310) 414-5400 F: (310) 414-5462 www.firstindustrial.com



17825 Indian Street  
Moreno Valley, CA

# FOR LEASE 366,117 SF

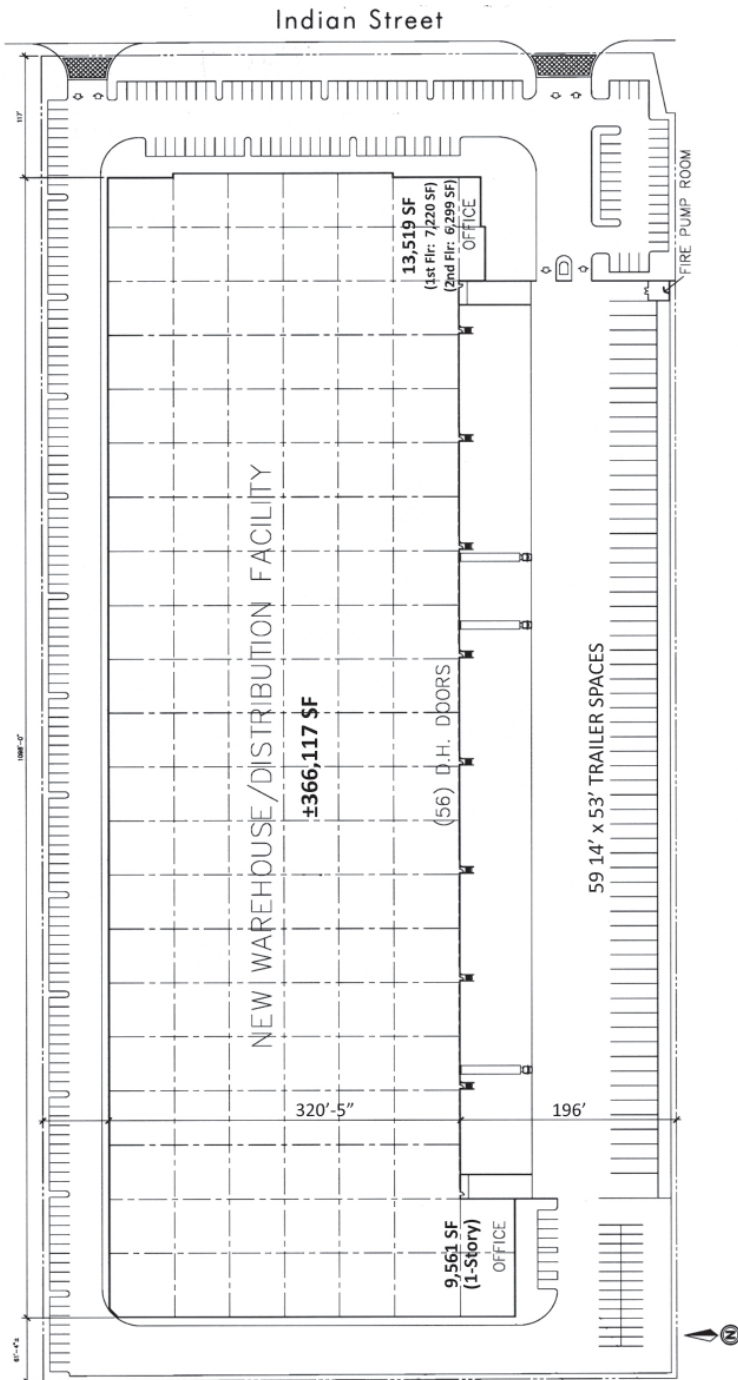

## → CONTACT

### Ryan McClean

First Industrial Realty Trust  
Marketing/Leasing Manager  
(310) 321-3810  
[rmcclean@firstindustrial.com](mailto:rmcclean@firstindustrial.com)

Or our exclusive agents:

### Mike Wolfe, SIOR

Principal / Sr. Vice President  
(909) 373-2915  
[mwolfe@lee-assoc.com](mailto:mwolfe@lee-assoc.com)  
(CA DRE# 00641624)

### Joe McKay

Principal / Sr. Vice President  
(909) 373-2914  
[jmckay@lee-assoc.com](mailto:jmckay@lee-assoc.com)  
(CA DRE# 00894360)

### Stephen Deverian

(909) 373-2938  
[sdeverian@lee-assoc.com](mailto:sdeverian@lee-assoc.com)  
(CA DRE# 01964686)



All information furnished regarding the property for sale, rental or financing is obtained from sources deemed reliable. No representation is made to the accuracy thereof and is submitted subject to errors, omissions, change of price rental or other conditions, prior sale, lease, or financing, or withdrawal without notice. First Industrial Realty Trust, Inc. represents the Seller in this transaction and as such owes all duties and obligations thereto.

## FIRST INDUSTRIAL REALTY TRUST

898 N. Sepulveda Blvd Ste 175, El Segundo, CA 90245  
T: (310) 414-5400 F: (310) 414-5462 [www.firstindustrial.com](http://www.firstindustrial.com)

