

# FOR SALE

SORRENTO MESA  
BUSINESS PLAZA



±12,569 SF HIGH IMAGE LAB/OFFICE GROUND FLOOR CONDO FOR SALE IN SORRENTO MESA

# 5820

OBERLIN DRIVE

**CHRIS DUNCAN**, Senior Associate  
858.458.3307 | [cduncan@voitco.com](mailto:cduncan@voitco.com) | Lic. #01324067

**RANDY LACHANCE**, Senior Vice President  
858.458.3374 | [rlachance@voitco.com](mailto:rlachance@voitco.com) | Lic. #00969674

***Voit***  
REAL ESTATE SERVICES

# PROPERTY FEATURES

- ±12,569 saleable SF high image ground floor lab/office condo
  - » Unit 104: **±5,169 SF**
  - » Unit 106, 107 & 108: **±7,400 SF**
- 95% office, 5% warehouse (ability to create additional warehouse)
- Divisible for multiple tenants
- High quality lab/office improvements
- Common area lobby & restrooms
- Two grade level doors (can add glass inserts)
- 18'-20' clear height in warehouse
- Lab benching, fume hoods with ventilation & ducting in place can remain or be converted back to office
- Located in the heart of Sorrento Mesa with great Freeway access to I-5 and I-805
- 34 parking spaces
- Part of Sorrento Business Plaza Condo Association (Association dues ±\$0.325/SF)

**SALE PRICE: \$3,995,000**

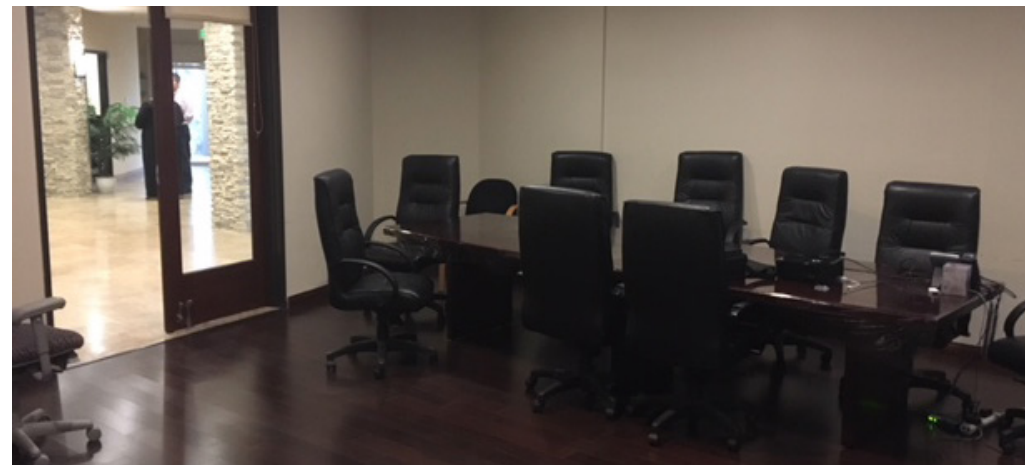
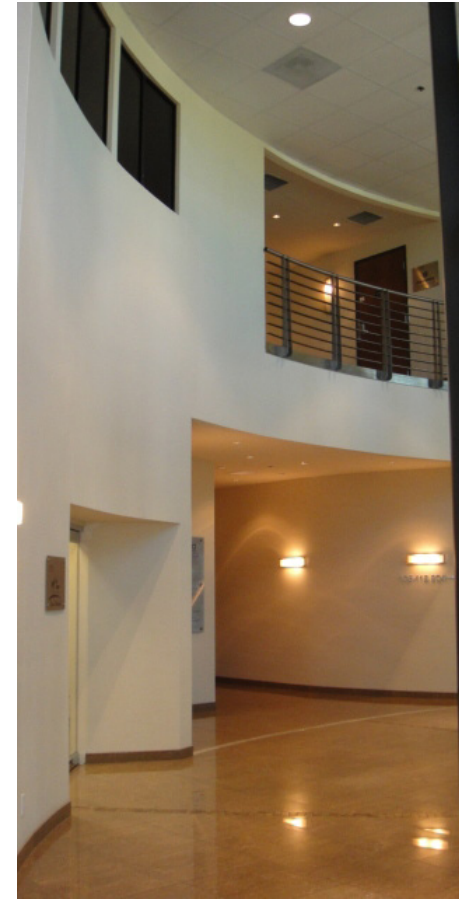

# FLOOR PLANS (FIRST FLOOR)

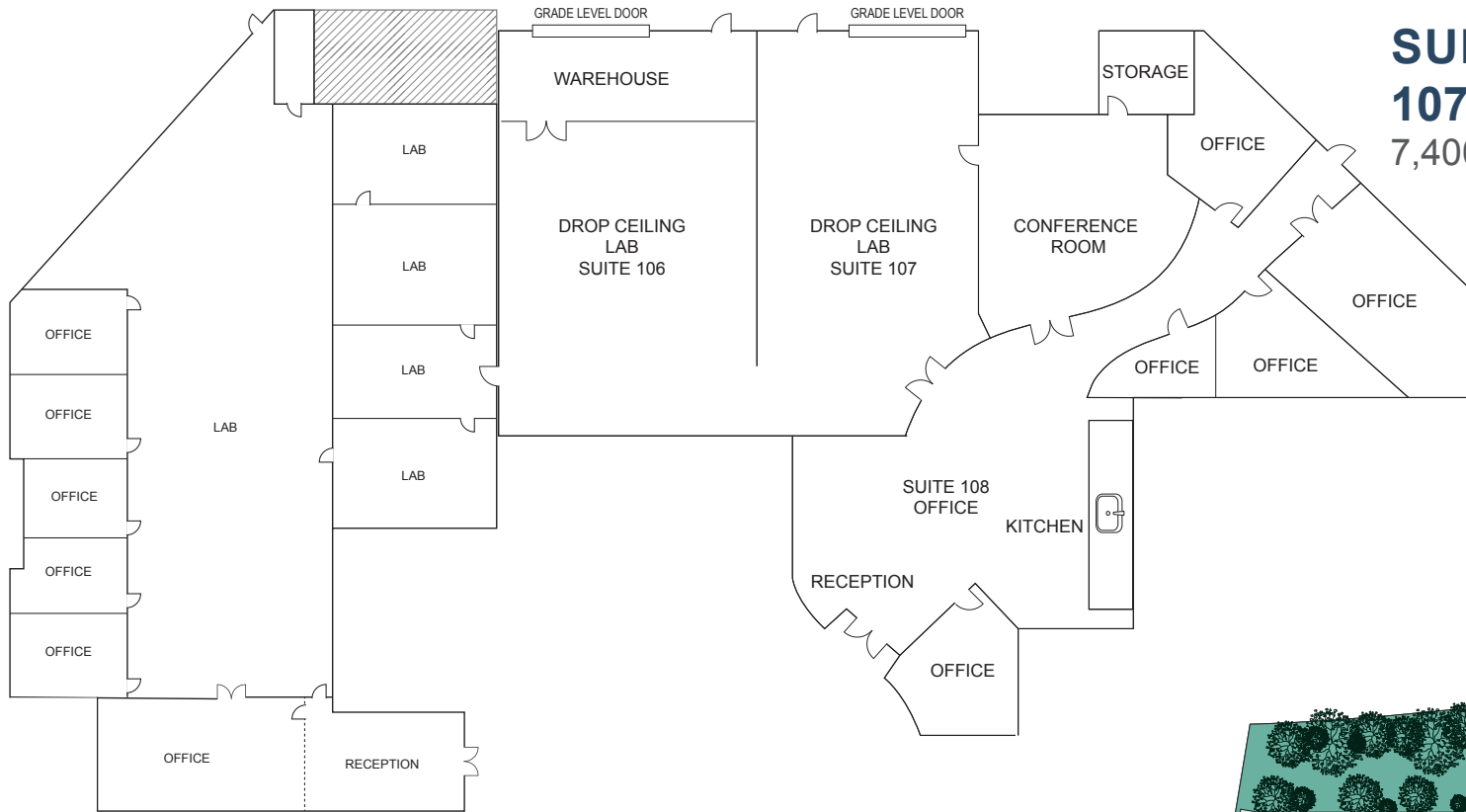

**SUITES 106,  
107 & 108**  
7,400 SF

**SUITE 104**  
5,169 SF

**SITE  
PLAN**

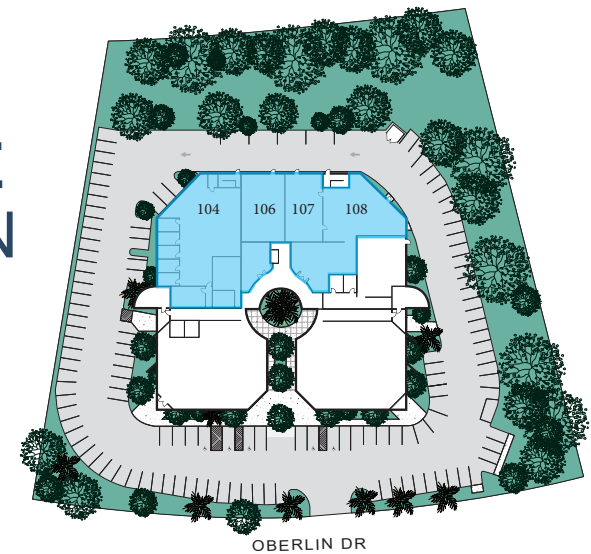

# 5820

---

## OBERLIN DRIVE



**CHRIS DUNCAN**, Senior Associate

858.458.3307 | [cduncan@voitco.com](mailto:cduncan@voitco.com) | Lic. #01324067

4180 L Jolla Village Drive, Suite 100, L Jolla, CA 92037 | 858.453.0505 | 858.408.3976 Fax | Lic #01991785 | [www.voitco.com](http://www.voitco.com)

**RANDY LACHANCE**, Senior Vice President

858.458.3374 | [rlachance@voitco.com](mailto:rlachance@voitco.com) | Lic. #00969674

# Voit

REAL ESTATE SERVICES