

Highway 92 and Lee Road Extension

Douglasville, GA 30135 | Douglas County



COMMERCIAL SITES FOR SALE

HIGHLIGHTS

- Traffic signal at Lee Road and Highway 92
- Daily traffic count is 30,000 ±
- Graded sites with utilities
- Interchange improvements at Lee Road and I-20
- Lee Road widening project started 2014
- Zoned C-G-C, Douglas County
- Property is located in Highway 92 Village Overlay District
- Adjacent to Tractor Supply (opened Feb 2015) and Walgreens



Ackerman & Co.

LARRY WOOD
770.913.3902
lwood@ackermanco.net



KYLE GABLE
404.867.3332
kgable@pioneerlandga.com

Highway 92 and Lee Road Extension

Douglasville, Georgia 30135
Douglas County

AERIAL



Ackerman & Co.

LARRY WOOD
770.913.3902
lwood@ackermanco.net



KYLE GABLE
404.867.3332
kgable@pioneerlandga.com

Highway 92 and Lee Road Extension

Douglasville, Georgia 30135
Douglas County

DEVELOPED OUT-PARCEL SITES

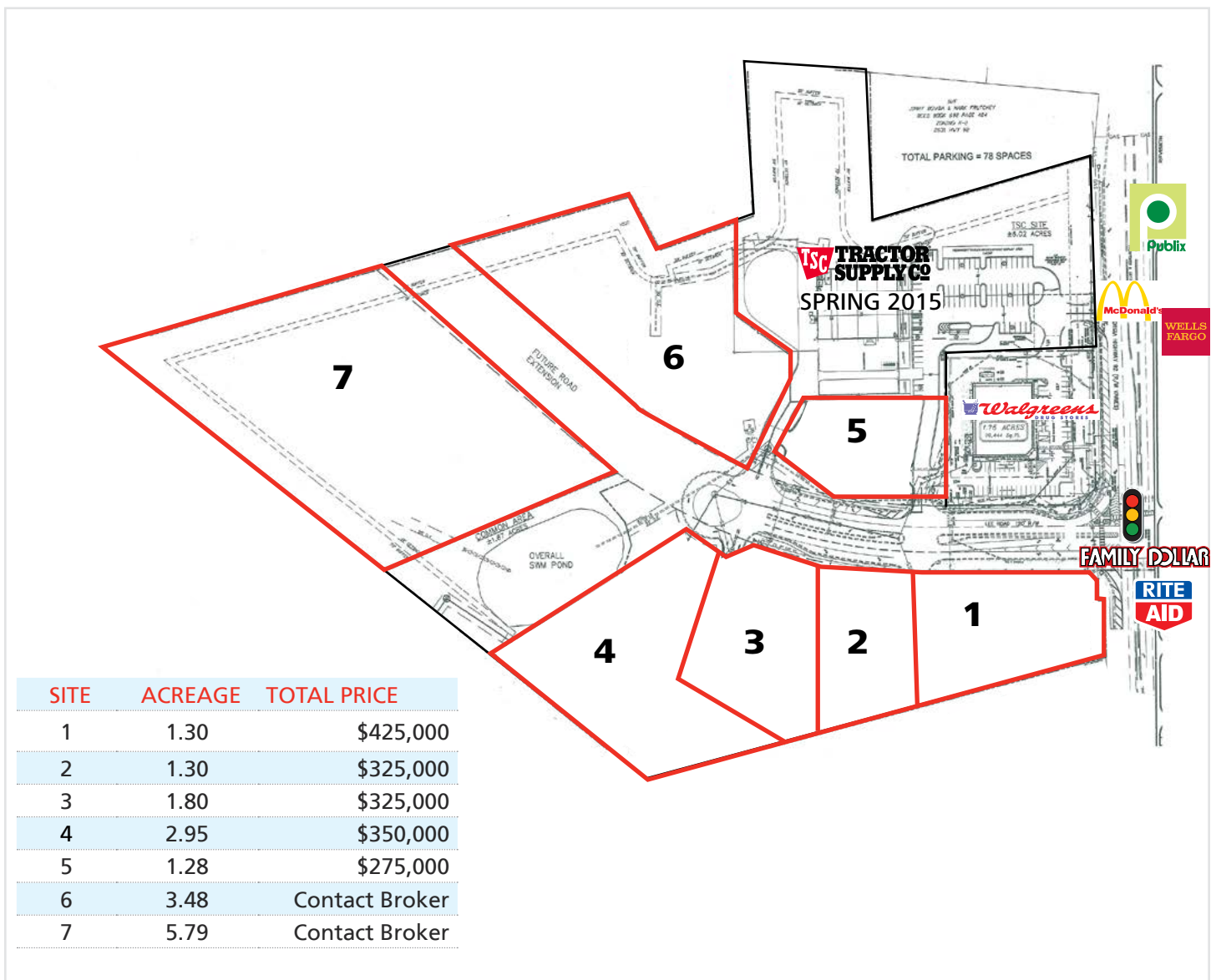

| DEMOGRAPHICS | 1-MILE | 3-MILE | 5-MILE |
|--------------------------|----------|----------|----------|
| Population | 3,685 | 25,641 | 81,168 |
| Average Household Income | \$54,741 | \$58,920 | \$60,305 |
| Number of Households | 1,275 | 8,979 | 28,572 |

Ackerman & Co.

LARRY WOOD
770.913.3902
lwood@ackermanco.net



KYLE GABLE
404.867.3332
kgable@pioneerlandga.com