

# OWYHEE CENTER RETAIL PLAZA

For Lease



**MARK BOTTLES**  
REAL ESTATE SERVICES



## PROPERTY INFORMATION:

**Address:** 421 12th Avenue Road  
Nampa, Idaho 83686

**Space Available:** +/- 14,100 SF main level  
plus mezzanine/office  
and basement area

**Lease Rate:** \$11.00/SF NNN

**Terms:** 5-10 years

## COMMENTS:

- Excellent Location on 12th Avenue Road
- Traffic Count: +/- 28,000 VPD
- Updated storefront with large parking area
- Pylon signage with electronic reader board

- Close to NNU
- Long Term tenants include:
  - Chicago Connection
  - One Hour Martinizing
  - Sunrise Cafe
  - Lucky Star Mongolian Grill
  - Bagel Shop
- Call listing agent for access; **Do Not Disturb Tenant**



839 S. Bridgeway Place  
Eagle, Idaho  
P(208) 377-5700 F(208) 377-0035  
[www.markbottles.com](http://www.markbottles.com)

**David Bohecker**

Cell: (208) 230-3309 | Office: (208) 947-1081  
[dbohecker@markbottles.com](mailto:dbohecker@markbottles.com)

# OWYHEE CENTER RETAIL PLAZA

For Lease



**MARK BOTTLES**  
REAL ESTATE SERVICES

## MB FLOOR PLANS

421 12TH AVENUE ROAD, NAMPA

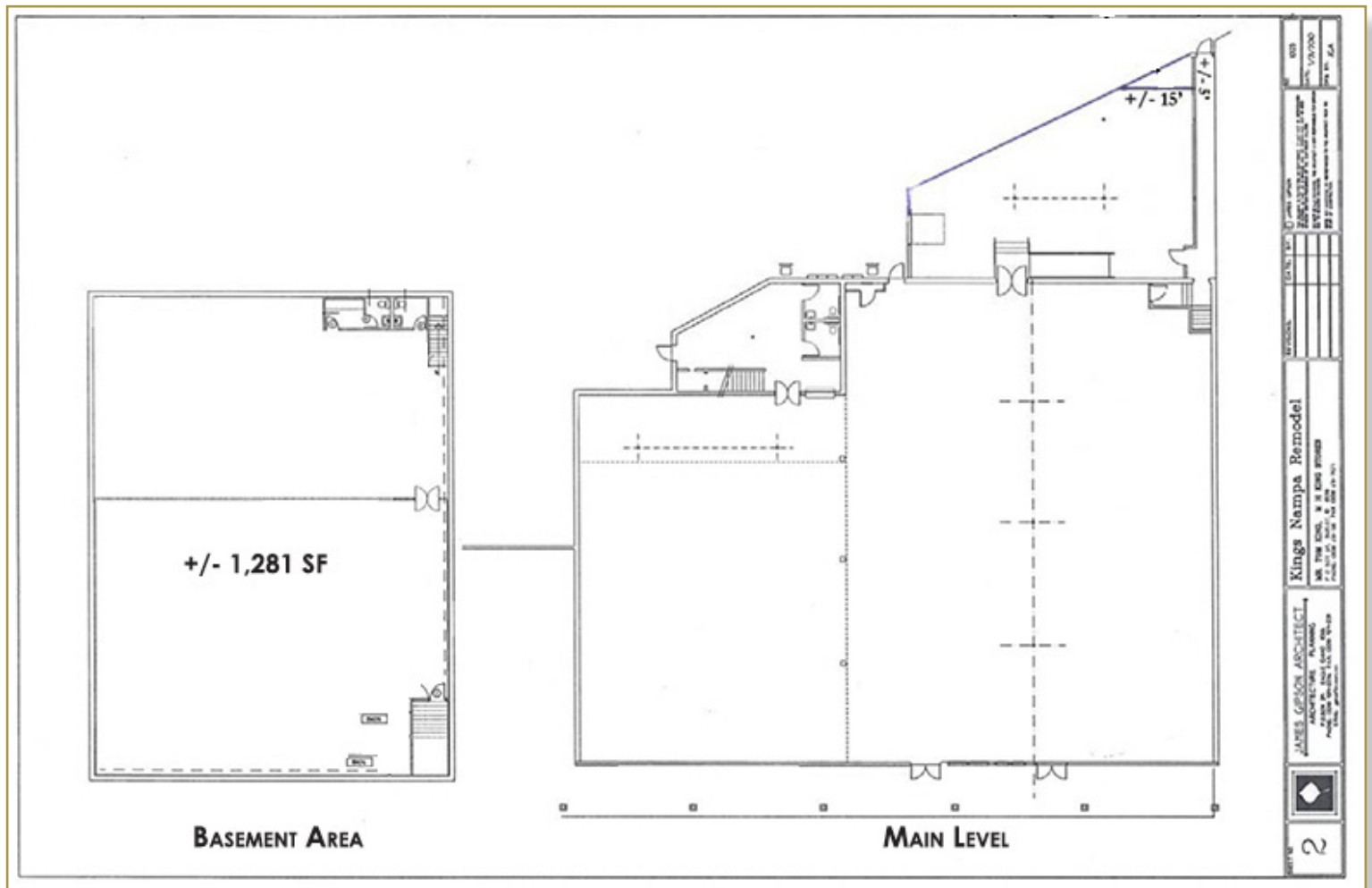

839 S. Bridgeway Place  
Eagle, Idaho  
P(208) 377-5700 F(208) 377-0035  
[www.markbottles.com](http://www.markbottles.com)

**David Bohecker**  
Cell: (208) 230-3309 | Office: (208) 947-1081  
[dbohecker@markbottles.com](mailto:dbohecker@markbottles.com)

This information, while not guaranteed, is from sources we believe to be reliable. This data is subject to price changes, corrections, errors, omissions, prior sale, and/or withdrawal.