

Aerial / Demographics

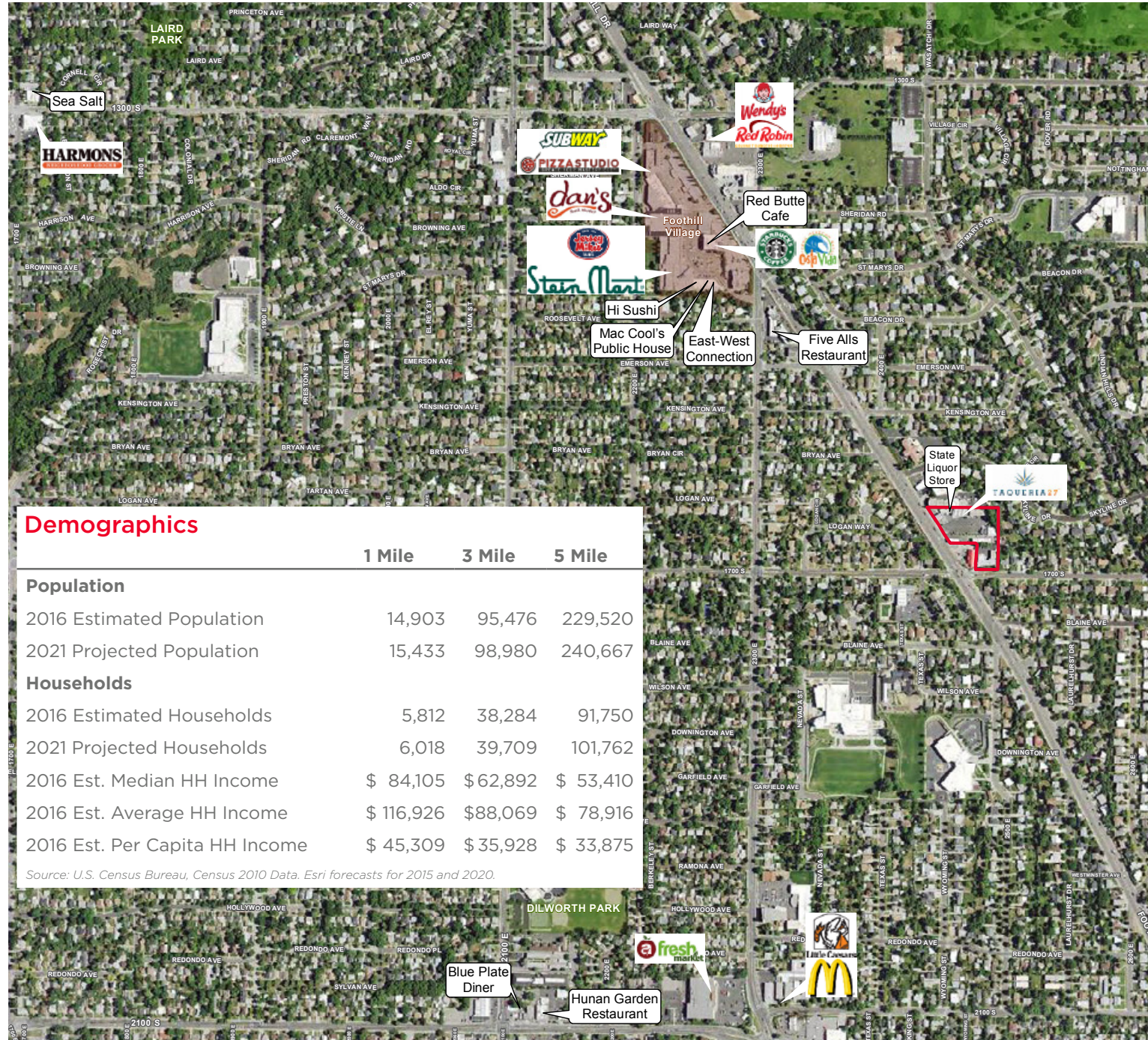

Demographics	1 Mile	3 Mile	5 Mile
Population			
2016 Estimated Population	14,903	95,476	229,520
2021 Projected Population	15,433	98,980	240,667
Households			
2016 Estimated Households	5,812	38,284	91,750
2021 Projected Households	6,018	39,709	101,762
2016 Est. Median HH Income	\$ 84,105	\$ 62,892	\$ 53,410
2016 Est. Average HH Income	\$ 116,926	\$ 88,069	\$ 78,916
2016 Est. Per Capita HH Income	\$ 45,309	\$ 35,928	\$ 33,875

Source: U.S. Census Bureau, Census 2010 Data. Esri forecasts for 2015 and 2020.

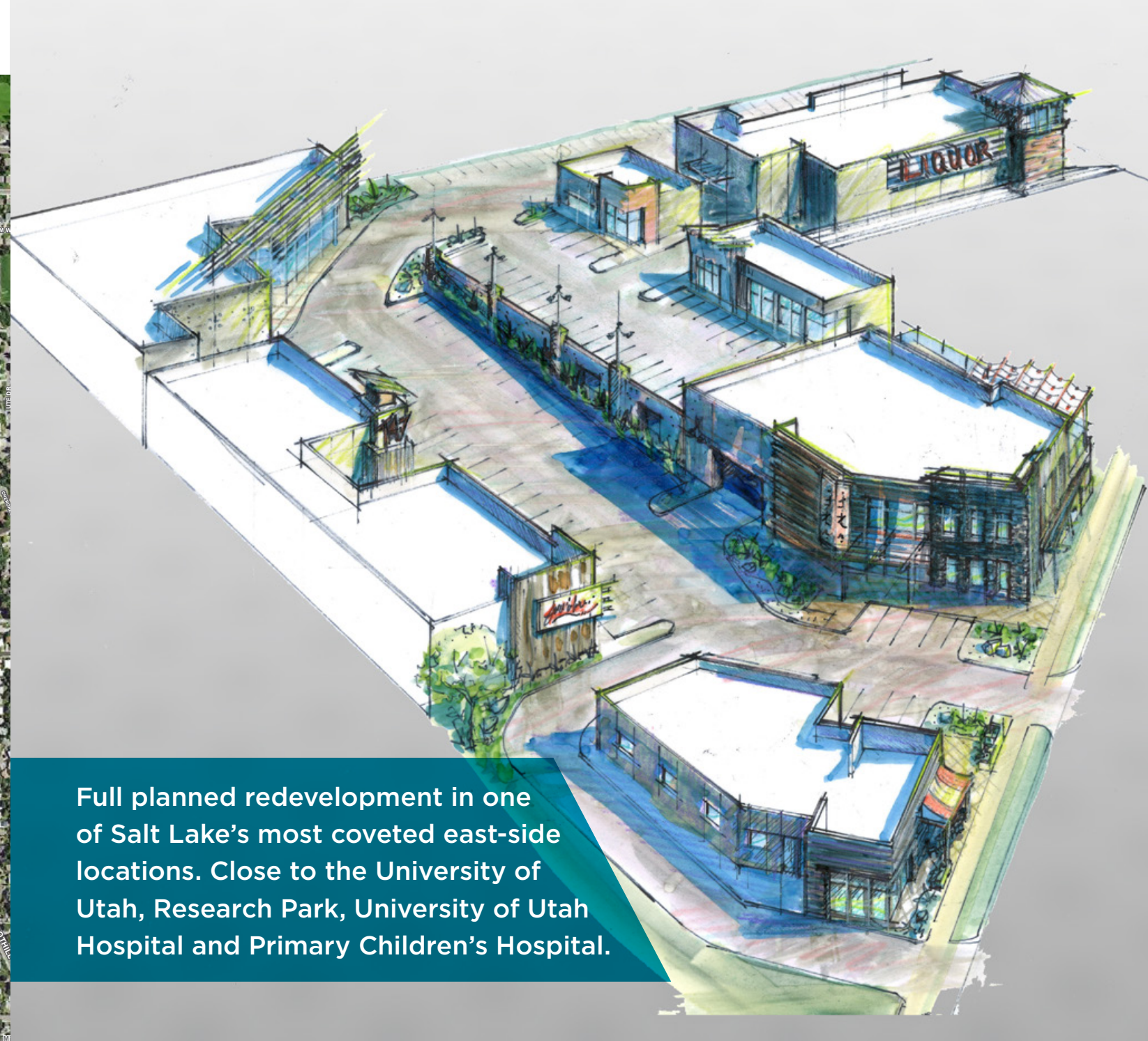

Full planned redevelopment in one of Salt Lake's most coveted east-side locations. Close to the University of Utah, Research Park, University of Utah Hospital and Primary Children's Hospital.

Steve Tate
 Senior Director
 +1 801 303 5558
 state@comre.com

Katie Mikula
 Associate
 +1 801 303 5497
 kmikula@comre.com

170 South Main Street Suite 1600
 Salt Lake City, UT 84101
 Main +1 801 322 2000
 Fax +1 801 322 2040
 comre.com

Steve Tate
 Senior Director
 +1 801 303 5558
 state@comre.com

Katie Mikula
 Associate
 +1 801 303 5497
 kmikula@comre.com

170 South Main Street Suite 1600
 Salt Lake City, UT 84101
 Main +1 801 322 2000
 Fax +1 801 322 2040
 comre.com



- Property Highlights**
- 1,200 - 10,000 SF Available
 - Restaurant Space with Patios
 - New, additional underground parking planned
 - Great access and visibility from Foothill Drive

