

12921 STARK ROAD
LIVONIA, MICHIGAN

INDUSTRIAL FOR SALE
19,800 Square Feet Available



**SIGNATURE
ASSOCIATES**
KNOW SIGNATURE | KNOW RESULTS



PROPERTY FEATURES

- 19,800 square foot building available
- Includes 2,400 square feet of mezzanine space
- 4,800 square feet of office
- 21' clear height
- (2) 8x10, 12x14 grade level doors, (2) truckwells
- Zoned M-1
- 70 parking spaces
- 2,000 amps, 480 volts power, buss duct
- Sale Price: \$1,405,800 (\$71.00/sq.ft.)



For more information, please contact:

STEVE GORDON
(248) 948 0101
sgordon@signatureassociates.com

SIGNATURE ASSOCIATES
One Towne Square, Suite 1200
Southfield, MI 48076
www.signatureassociates.com

12921 Stark Road – Livonia, Michigan

Industrial For Sale

19,800
Square Feet
AVAILABLE

Site Plan

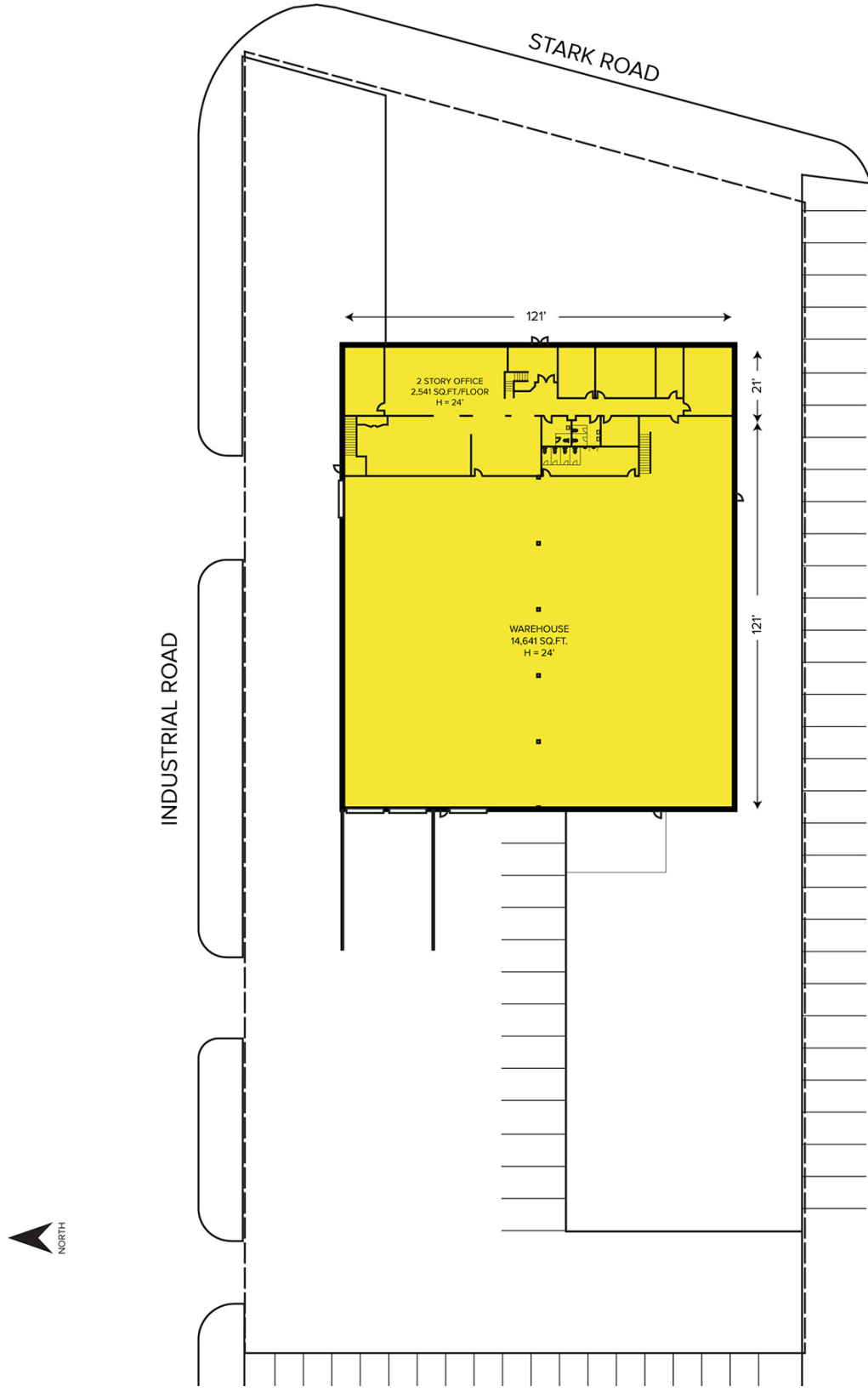

For more information, please contact:

STEVE GORDON
(248) 948 0101
sgordon@signatureassociates.com

SIGNATURE ASSOCIATES
One Towne Square, Suite 1200
Southfield, MI 48076
www.signatureassociates.com

12921 Stark Road – Livonia, Michigan

Industrial For Sale

19,800
Square Feet
AVAILABLE

Floor Plan

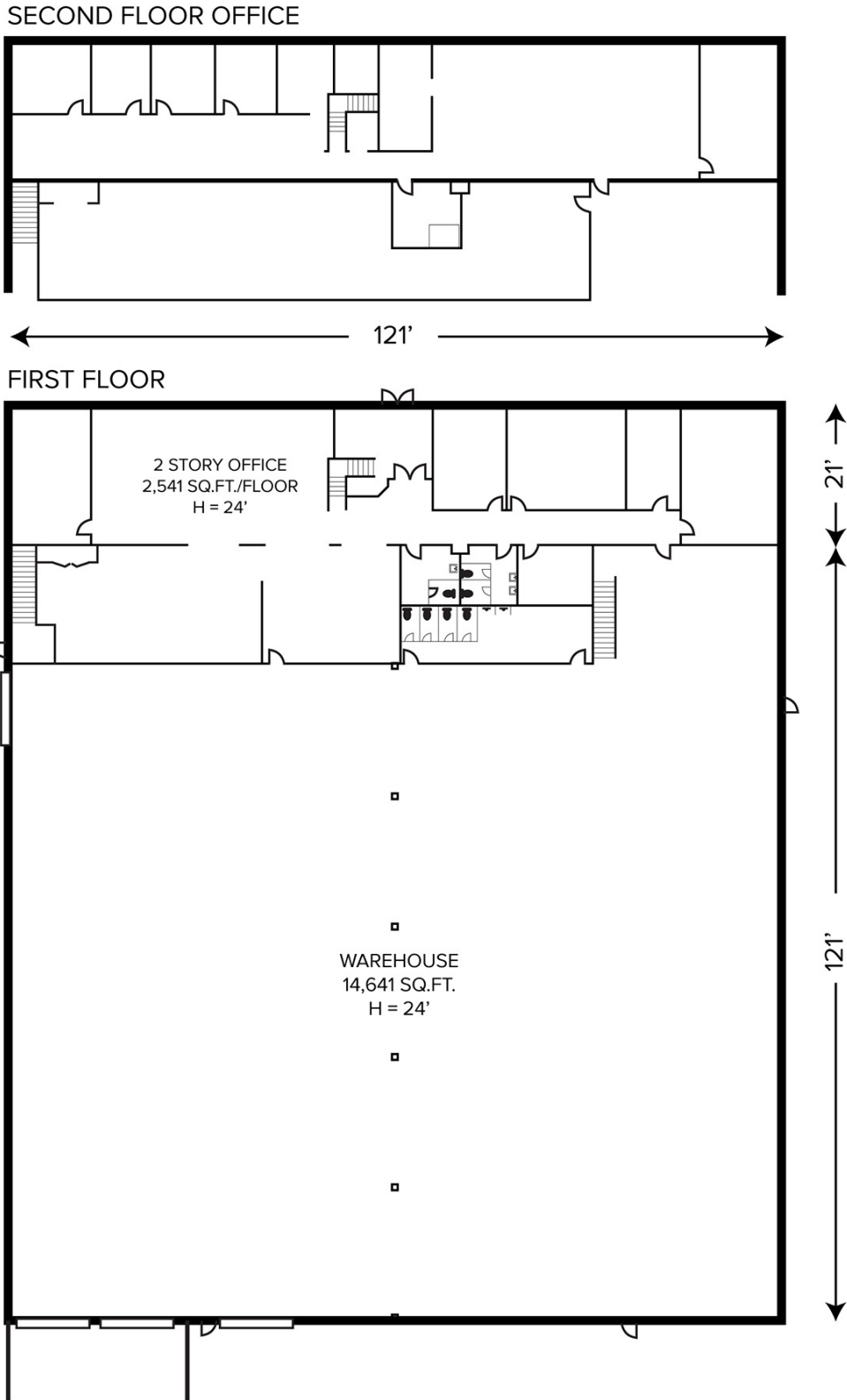

For more information, please contact:
STEVE GORDON
(248) 948 0101
sgordon@signatureassociates.com

SIGNATURE ASSOCIATES
One Towne Square, Suite 1200
Southfield, MI 48076
www.signatureassociates.com

Information is subject to verification and no liability for errors or omissions is assumed. Price is subject to change and listing withdrawal.

12921 Stark Road – Livonia, Michigan

Industrial For Sale

19,800
Square Feet
AVAILABLE

Aerial



For more information, please contact:

STEVE GORDON

(248) 948 0101

sgordon@signatureassociates.com

SIGNATURE ASSOCIATES

One Towne Square, Suite 1200

Southfield, MI 48076

www.signatureassociates.com