

For Sale

# ASTORIA CORNER WAREHOUSE PACKAGE

2413 46TH STREET & 2426 47TH STREET, ASTORIA, NY 11103

TWO WAREHOUSES ON BROOKLYN-QUEENS EXPRESSWAY  
TOTALING 16,270 SF



## FEATURES

- TWO CORNER WAREHOUSES WITH 3 STREET FRONTAGES
  - 10,835 SF GROUND FLOOR
  - 5,465 SECOND FLOOR
  - 1,254 SF YARD
- PERFECT OWNER-USER OPPORTUNITY
- HEAVY POWER 4000 AMPS SEPARATELY METERED
- EXCELLENT SIGNAGE
- DAILY TRAFFIC COUNT APPROX. 21,500
- EASY ACCESS TO ALL NYC
- DIRECT ACCESS TO 278 / BROOKLYN QUEENS EXPRESSWAY, GRAND CENTRAL PARKWAY, & RFK BRIDGE

## EXCLUSIVE AGENT

**MATTHEW MCMULLEN**

(718) 786-5050

[mmcmullen@greiner-maltz.com](mailto:mmcmullen@greiner-maltz.com)

**GREINER-MALTZ**

REAL ESTATE

Creating Opportunities Together

[WWW.GREINER-MALTZ.COM](http://WWW.GREINER-MALTZ.COM)

Any information set-forth herein has been obtained from sources deemed reliable, however, we have not verified it, and make no representation or warranty of any kind, including without limitation: condition: either latent or patent, size or manner of construction of the property, compliance with local law, and environmental conditions. All information submitted herein is subject to errors and omissions, and the right of our principal(s), to withdraw, modify, or condition the listing with-out prior notice. Broker cooperation encouraged.



# ASTORIA CORNER WAREHOUSE PACKAGE

2413 & 2426 46TH STREET, ASTORIA, NY 11103

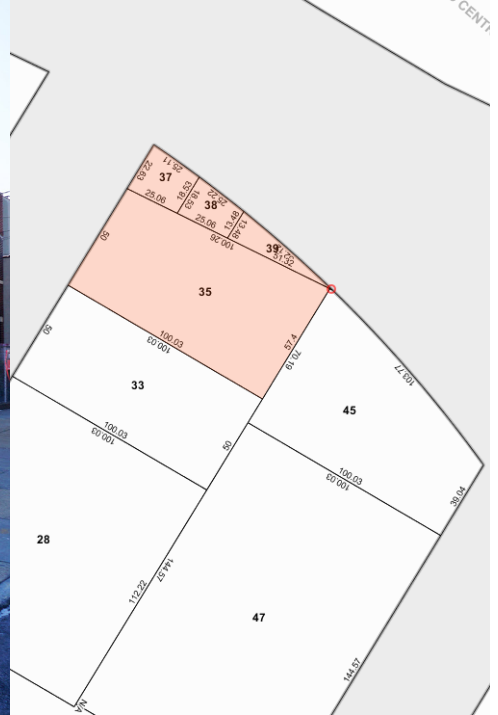

**BLOCK/LOT** 732 / 35, 37, 38, 39

**BUILDING DIMENSIONS** 50 ft x 100 ft

**BUILDING SIZE** 5,370 SF

**LOT DIMENSIONS** 50 ft x 100.03 ft irregular

**LOT SIZE** 6,626 SF

**YARD SF** 1,254 SF

**ZONING** M1-1

**REAL ESTATE TAXES** \$22,495

## FEATURES

- Single-Story Warehouse
- 1 Drive-In Door
- 1,254 SF Yard
- Great Traffic Exposure
- Convenient Location to Major Roadways
- Heavy Power

## TRANSPORTATION

**N W** Subway  
278 / Brooklyn Queens Expressway  
Grand Central Parkway  
RFK Bridge

## EXCLUSIVE AGENT

**MATTHEW MCMULLEN**

(718) 786-5050

[mmcmullen@greiner-maltz.com](mailto:mmcmullen@greiner-maltz.com)

**GREINER-MALTZ**  
REAL ESTATE

Creating Opportunities Together

[WWW.GREINER-MALTZ.COM](http://WWW.GREINER-MALTZ.COM)

Any information set-forth herein has been obtained from sources deemed reliable, however, we have not verified it, and make no representation or warranty of any kind, including without limitation: condition: either latent or patent, size or manner of construction of the property, compliance with local law, and environmental conditions. All information submitted herein is subject to errors and omissions, and the right of our principal(s), to withdraw, modify, or condition the listing with-out prior notice. Broker cooperation encouraged.

# ASTORIA CORNER WAREHOUSE PACKAGE

2413 & 2426 46TH STREET, ASTORIA, NY 11103



## BLOCK/LOT

732 / 45

**BUILDING DIMENSIONS** 39 ft x 100 ft

**BUILDING SIZE** 10,900 SF

**LOT DIMENSIONS** 39.04 ft x 100.03 ft

**LOT SIZE** 5,465 SF

**ZONING** M1-1

**REAL ESTATE TAXES** \$43,873

## FEATURES

- Heavy Power - 3000 Amps
- 1 Drive-In Door (13.5 ft)
- 14 ft Ceiling Heights
- Lots of Natural Light
- Sprinklered
- Great Traffic Exposure
- Convenient Location to Major Roadways

## TRANSPORTATION

**N W** Subway  
278 / Brooklyn Queens Expressway  
Grand Central Parkway  
RFK Bridge

## EXCLUSIVE AGENT

**MATTHEW MCMULLEN**

(718) 786-5050

[mmcmullen@greiner-maltz.com](mailto:mmcmullen@greiner-maltz.com)

**GREINER-MALTZ**

REAL ESTATE

Creating Opportunities Together

[WWW.GREINER-MALTZ.COM](http://WWW.GREINER-MALTZ.COM)

Any information set-forth herein has been obtained from sources deemed reliable, however, we have not verified it, and make no representation or warranty of any kind, including without limitation: condition: either latent or patent, size or manner of construction of the property, compliance with local law, and environmental conditions. All information submitted herein is subject to errors and omissions, and the right of our principal(s), to withdraw, modify, or condition the listing with-out prior notice. Broker cooperation encouraged.