

# FOR SALE

## LAGUNA HILLS OFFICE PARK

23221 South Pointe Drive # 101, Laguna Hills CA 92653



### PROPERTY HIGHLIGHTS

- ±2,130 single story medical office condo
- Corner unit with (3) three separate entries
- Building signage available
- Property contains 2 parcels for future value
- Currently a physical therapy office
- Large treatment room or open therapy area
- Shared restrooms
- Excellent glass line
- Association Cost \$338.00 per month
- \$310 PSF (\$660,300)
- High image glass and brick exterior
- Immediate access to 5, 405 & 133 Freeways
- Close to new Los Olivos Shopping Center and Whole Foods, 24 hour fitness, starbucks, and more
- Near Irvine Spectrum Entertainment Center & Five Lagunas
- Excellent owner/user office/medical building
- **Medical uses approved**

### CONTACT



**Allen Basso**  
Senior Vice President  
License ID# 01298152  
949.790.3130  
abasso@leeirvine.com



**Eric Darnell**  
Senior Associate  
License ID# 01888743  
949.790.3157  
edarnell@leeirvine.com



COMMERCIAL REAL ESTATE SERVICES

No warranty or representation is made to the accuracy of the foregoing information. Terms of sale or lease and availability are subject to change or withdrawal without notice.

**FOR  
SALE**

# LAGUNA HILLS OFFICE PARK

23221 South Pointe Drive # 101, Laguna Hills CA 92653

## Floor Plan

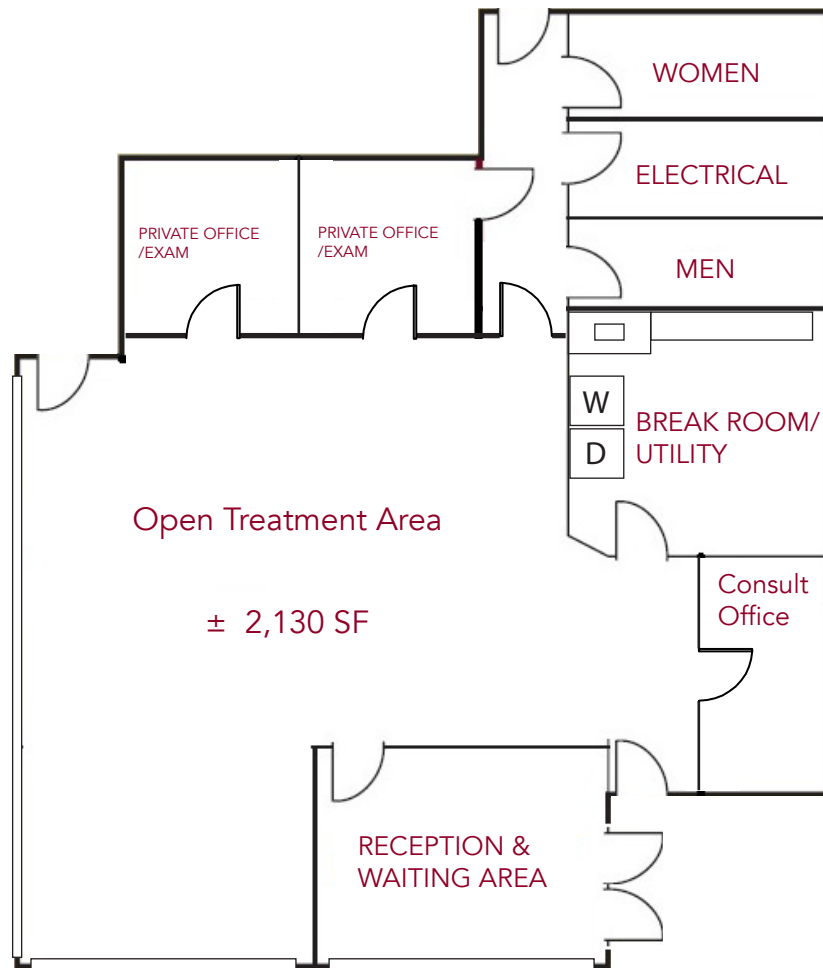

## CONTACT



**Allen Basso**  
Senior Vice President  
License ID# 01298152  
949.790.3130  
abasso@leeirvine.com



**Eric Darnell**  
Senior Associate  
License ID# 01888743  
949.790.3157  
edarnell@leeirvine.com



COMMERCIAL REAL ESTATE SERVICES  
No warranty or representation is made to the accuracy of the foregoing information. Terms of sale or lease and availability are subject to change or withdrawal without notice.

# FOR SALE

## LAGUNA HILLS OFFICE PARK

23221 South Pointe Drive # 101, Laguna Hills CA 92653

Aerial Map

# PART OF MASTER PLANNED IRVINE SPECTRUM



## CONTACT



**Allen Basso**  
Senior Vice President  
License ID# 01298152  
949.790.3130  
abasso@leirvine.com



**Eric Darnell**  
Senior Associate  
License ID# 01888743  
949.790.3157  
edarnell@leirvine.com

**LEE & ASSOCIATES**

COMMERCIAL REAL ESTATE SERVICES

No warranty or representation is made to the accuracy of the foregoing information. Terms of sale or lease and availability are subject to change or withdrawal without notice.