

2628-32 NORTH BROAD STREET

PHILADELPHIA, PA

±937 - 1,937 SF AVAILABLE AVAILABLE FOR LEASE



property highlights.

- Walking distance from North Broad Street Station
- High visibility on Broad Street with 35,186 VPD
- Pylon signage available
- Over 63,000 people within 1 mile radius
- Within close proximity to Temple University
- Available onsite parking

stats.

| 2019 DEMOGRAPHICS* | 0.25 MILE | 0.5 MILE | 1 MILE |
|---------------------|-----------|----------|----------|
| EST. POPULATION | 3,785 | 15,045 | 63,317 |
| EST. HOUSEHOLDS | 1,402 | 5,439 | 21,757 |
| EST. AVG. HH INCOME | \$33,949 | \$28,622 | \$28,290 |

NORTH BROAD STREET TRAFFIC COUNT: 35,168 VPD *ESRI 2019



METRO[®]
COMMERCIAL
REAL ESTATE, INC.

MetroCommercial.com | PHILADELPHIA, PA | PLYMOUTH MEETING, PA | MOUNT LAUREL, NJ | NAPLES, FL

get in touch.

JONATHAN SPOERL

office 215.893.0300
direct 215.282.0157
jspoerl@metrocommercial.com

KJ KULIK

office 856.866.1900
direct 856.222.3012
kkulik@metrocommercial.com

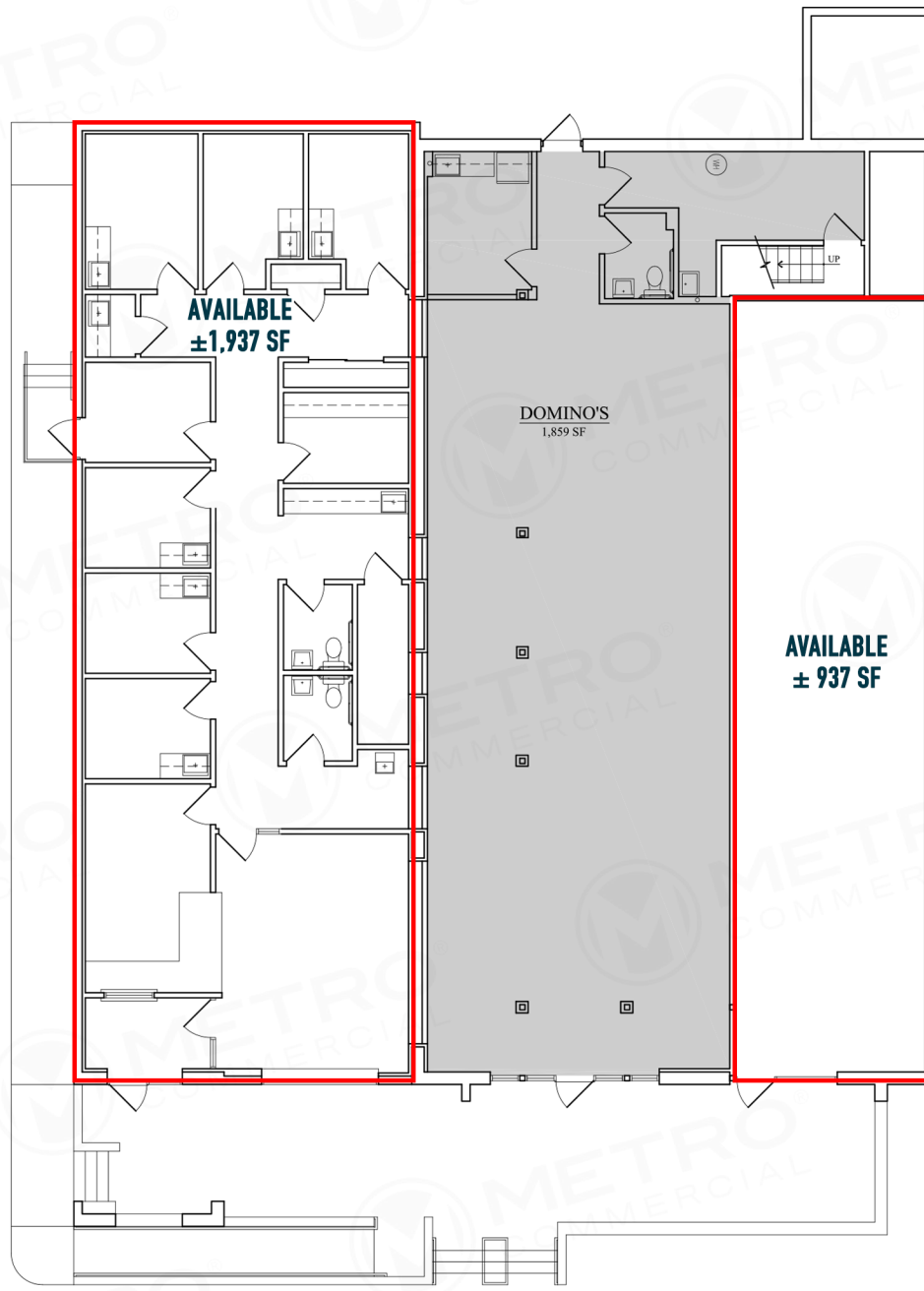

1 FLOOR PLAN
SCALE: 3/16" = 1'-0"

The information and images contained herein are from sources deemed reliable. However, Metro Commercial Real Estate, Inc. makes no representation whatsoever as to their accuracy or authenticity. Images shown may be modified for illustrative purposes. Images may be out-of-date and not current. 3.4.20



The information and images contained herein are from sources deemed reliable. However, Metro Commercial Real Estate, Inc. makes no representation whatsoever as to their accuracy or authenticity. Images shown may be modified for illustrative purposes. Images may be out-of-date and not current. 3.4.20

2628-32 N. BROAD STREET
PHILADELPHIA, PA





The information and images contained herein are from sources deemed reliable. However, Metro Commercial Real Estate, Inc. makes no representation whatsoever as to their accuracy or authenticity. Images shown may be modified for illustrative purposes. Images may be out-of-date and not current. 3.4.20

2628-32 N. BROAD STREET
PHILADELPHIA, PA

