



**TRANSWESTERN**<sup>®</sup>  
Industrial



# North Freeway Business Center

## 32,400 SF AVAILABLE



### PROPERTY FEATURES

4555 Airline • Suite 135  
Houston, TX 77022

- Total Lease Area: 32,400 SF  
Office Area: 2,150 SF  
Warehouse Area: 30,250 SF
- Easy access to I-45 and 610 Loop
- Dock-high, Front-load
- 22' Clear Height
- Fully sprinklered
- Ramp access

Transwestern Houston • 1900 West Loop South, Suite 1300 • Houston, Texas 77027  
P: 713.270.7700 • F: 713.271.8172

**JUDE FILIPPONE**  
713.270.3318  
jude.filippone@transwestern.com

**VINCE STRAKE**  
713.490.3784  
vince.strake@transwestern.com



The information provided herein was obtained from sources believed reliable, however, Transwestern makes no guarantees, warranties or representations as to the completeness or accuracy thereof. The presentation of this property is submitted subject to errors, omissions, change of price or conditions, prior to sale or lease, or withdrawal without notice.



# Floor Plan North Freeway Business Center 32,400 SF AVAILABLE

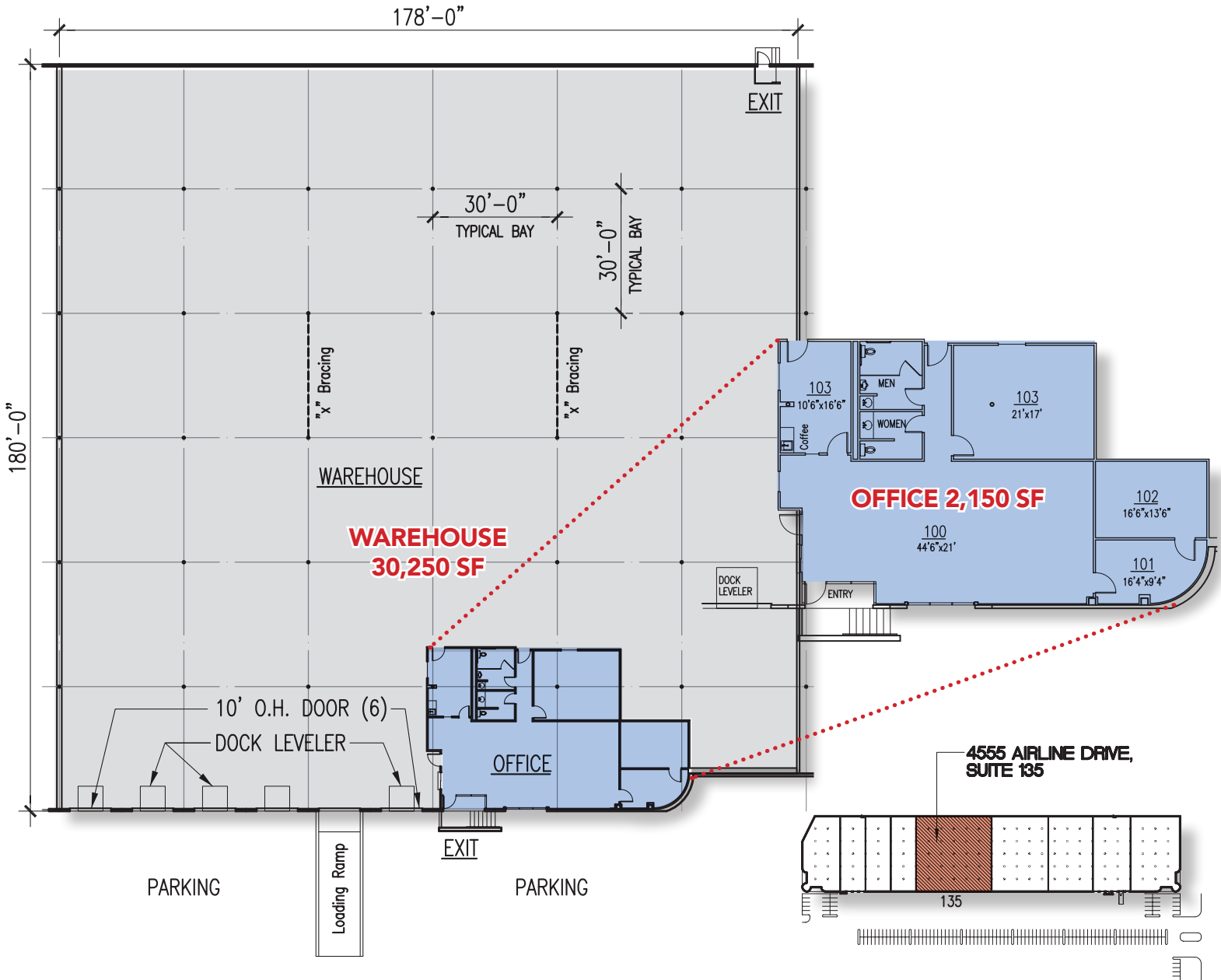

Transwestern Houston • 1900 West Loop South, Suite 1300 • Houston, Texas 77027  
P: 713.270.7700 • F: 713.271.8172

**JUDE FILIPPONE**  
713.270.3318  
jude.filippone@transwestern.com

**VINCE STRAKE**  
713.490.3784  
vince.strake@transwestern.com

